

Excellent Integrated System Limited

Stocking Distributor

Click to view price, real time Inventory, Delivery & Lifecycle Information:

[Molex Connector Corporation](#)
[0197024001](#)

For any questions, you can email us directly:

sales@integrated-circuit.com

CUSTOMER PART NO.	PART NO.	L* MAX. ±.015	I.D. MIN.	MATERIAL THICKNESS	WIRE SIZE
RT-2016	19702-4001	1.63	.060	.021	AWG 20-16
RT-1410	19702-4101	1.66	.128	DUAL THICKNESS .021/.026	AWG 14-10

- NOTES:
 1. MATERIAL: PHOSBRONZE.
 2. PLATING: SILVER.
 3. BARREL BRAZED CLOSED.
 4. MATERIAL THICKNESS: SEE CHART.

AWG 14-10 VIEW

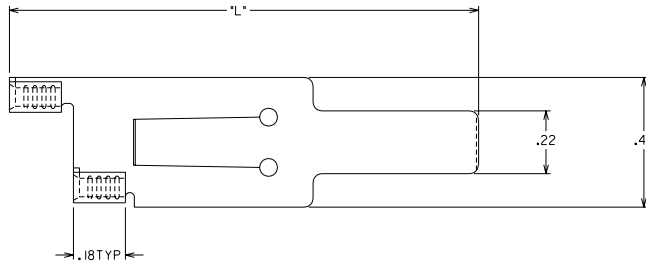
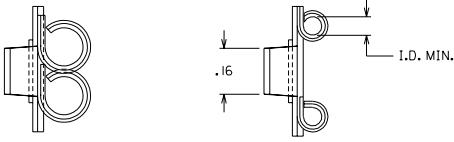

DUAL THICKNESS DETAIL

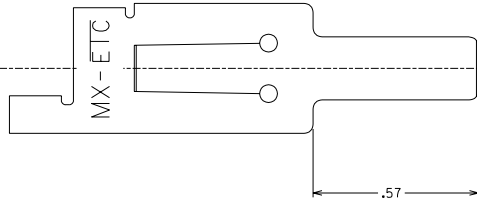
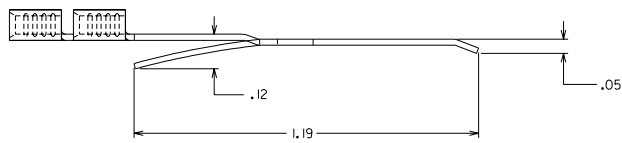
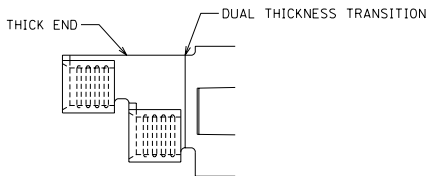

CUSTOMER DRAWING

DIMENSIONS SHOWN (METRIC) INCH		REVISE ONLY ON CAD SYSTEM	
UNLESS OTHERWISE SPECIFIED TOLERANCES ARE AS FOLLOWS:		TITLE	
3 PLACE ± .005 ± ---	INCH	RAILROAD RELAY TERMINAL CUSTOMER DRAWING	
2 PLACE ± .01 ± 0.13	METRIC	E.T.C. INC. PINEBLISS PARK, FLA. 33781 U.S.A.	
1 PLACE ± --- ± 0.25		SHEET NO. DATE 96/10/23	
DRAFT WHERE APPLICABLE MUST REMAIN WITH DIMENSIONS		PART NO. 197024001	
DRG. BY: JH		FILE NAME: SEE CHART	
CHK'D. BY: RWD		DRG. NO. 197024001	
APP'D. BY: RWD		SCALE: NONE	
		THIS DRAWING CONTAINS INFORMATION THAT IS PROPRIETARY TO E.T.C. INC. AND SHOULD NOT BE USED WITHOUT WRITTEN PERMISSION.	

B-2	LOAD INTO WM ETC2003-0200 03-02-10 BRE
B-1	19702-4001 WAS -4000; 19702-4101 WAS -4100 ECN70887 7/1 DAY
B	ADD COLUMN TO CHART ECN60601 11/96 JH
A	RELEASE CUSTOMER DRAWING ECN60593 10/25 JH
LTR.	REVISIONS