



Distributor of Molex Connector Corporation: Excellent Integrated System Limited
Datasheet of 0350689842 - Connector Quick Connect Receptacle 16-20 AWG 0.187"
(4.75mm) Crimp

Contact us: sales@integrated-circuit.com Website: www.integrated-circuit.com

Excellent Integrated System Limited

Stocking Distributor

Click to view price, real time Inventory, Delivery & Lifecycle Information:

[Molex Connector Corporation](#)
[0350689842](#)

For any questions, you can email us directly:
sales@integrated-circuit.com

Contact us: sales@integrated-circuit.com Website: www.integrated-circuit.com

- NOTES
1. MATERIAL: BRASS 0.30mm THICKNESS
 2. FINISH: PRE-PLATED TIN
 3. MATING TAB THICKNESS: 0.50 mm
 4. RECOMMENDED LENGTH OF WIRE STRIP IS 4.4-5.0mm.
 5. APPLICABLE WIRE: AWG #20-#16
INSULATION DIA.: ϕ 1.9-3.4mm

MATERIAL NO.	ENG NO.	REMARK
350689802	35068-9802	HIGH TENSION VERSION
350689842	35068-9842	LOW TENSION VESION

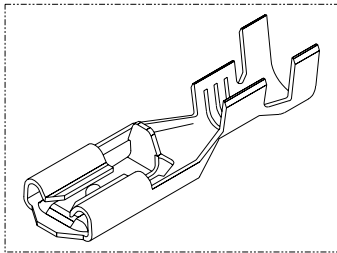
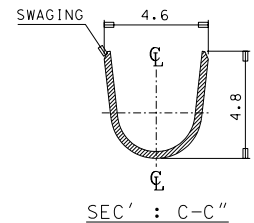
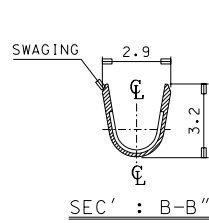
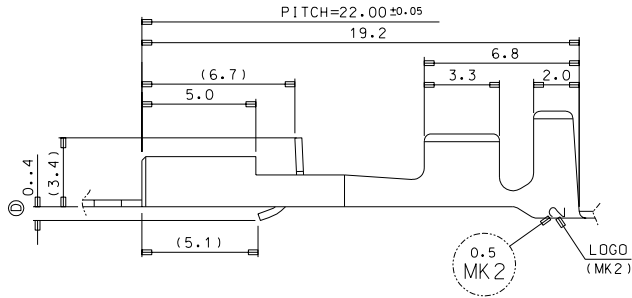
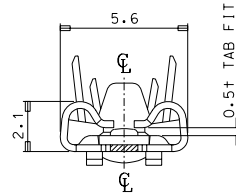
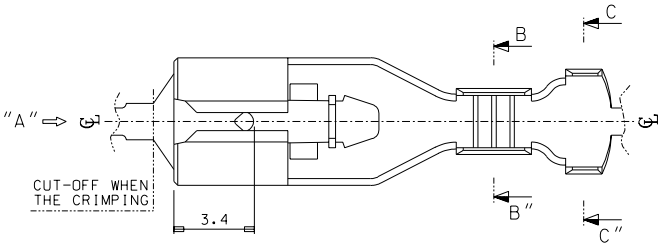

ISOMETRIC VIEW

REVISED EC NO. KOR 2003-0004 DRAWN: C.B.CHIN 02/07/05 CHK'D: W.Y. YANG APPR: C.W.LEE	DESCRIPTION	QUALITY SYMBOLS	GENERAL TOLERANCES: (UNLESS SPECIFIED)	SCALE 6/1	DESIGN UNITS <input checked="" type="checkbox"/> mm <input type="checkbox"/> INCH	THIRD ANGLE PROJECTION	DIMENSIONS: <input type="checkbox"/> mm <input type="checkbox"/> INCH <input type="checkbox"/> mm ONLY	SHT REV
		MAJOR $\nabla = 0$ CRITICAL $\nabla = 0$	mm INCH	DRAWN BY & DATE J.S.KANG 97/12/02	TITLE: .187 MP-LOCK TM'L(M) (0.5+ TAB FIT)	REVISE ON CAD ONLY		
F	REV	4 PLACES $\pm 0.$ 3 PLACES $\pm 0.$ 2 PLACES ± 0.2 1 PLACE ± 0.3	ANGULAR: $\pm 1^\circ$	CHECKED BY & DATE B.K.CHOI	APPROVED BY & DATE C.W.LEE	<input checked="" type="checkbox"/> THIRD ANGLE PROJECTION	<input type="checkbox"/> mm <input type="checkbox"/> inch <input checked="" type="checkbox"/> mm ONLY	
		DRAFT WHERE APPLICABLE MUST REMAIN WITHIN DIMENSIONS		CAD FILENAME s35068.dgn	MATERIAL NO. SEE CHART	MOLEX INCORPORATED		SHEET NO. 1 of 1
				THIS DRAWING CONTAINS INFORMATION THAT IS PROPRIETARY TO MOLEX INCORPORATED AND SHOULD NOT BE USED WITHOUT WRITTEN PERMISSION.			SIZE B	