

Excellent Integrated System Limited

Stocking Distributor

Click to view price, real time Inventory, Delivery & Lifecycle Information:

[Molex Connector Corporation](#)
[0192030165](#)

For any questions, you can email us directly:

sales@integrated-circuit.com

10	9	8	7	6	5	4	3	2	19203
MATERIAL NUMBER	ENGINEERING NUMBER	WIRE RANGE	"L" MAX	"A" MIN	"B" MAX	MATERIAL	MATERIAL THICKNESS	TEMPERATURE RATING	
192030165	A-T-302	22-18 (0.3-1.0mm ²)	.330 / (8.4)	.060 / (1.5)	.130 / (3.3)	COPPER	.032 / (0.8)	650F (342C)	
192030172	B-T-304	16-14 (1.2-2.0mm ²)	.330 / (8.4)	.091 / (2.3)	.160 / (4.1)	COPPER	.032 / (0.8)	650F (342C)	
192030169	C-T-303	12-10 (3.0-6.0mm ²)	.330 / (8.4)	.130 / (3.3)	.225 / (5.7)	COPPER	.040 / (1.0)	650F (342C)	

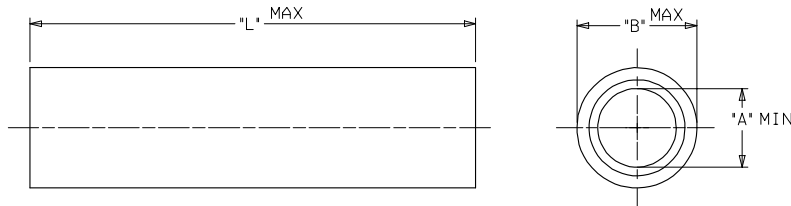

NOTES:
 1. PLATING: ELECTRO-NICKEL.
 2. ALL DIMENSIONS IN INCHES/(MM).
 3. RoHS COMPLIANT

RELEASE FOR PROD EC NO: ETC2007-046 DRWN: JLOMASTRO 2006/10/11 CHKD: JMACEIL 2006/10/11 APPR: JMACEIL 2006/10/12	QUALITY SYMBOLS ▽=0 ▽=0	GENERAL TOLERANCES (UNLESS SPECIFIED)		DIMENSION STYLE	SCALE	DESIGN UNITS	THIRD ANGLE PROJECTION	
		mm	INCH	IN/MM	INCH			
		4 PLACES	± .005	± .005	DRAWN BY	DATE	TITLE	
		3 PLACES	± .005	± .010	JLOMASTRO	10/02/06	PARALLEL SPLICE VERSAKRIMP TEMP TERMS	
		2 PLACES	± 0.25	± .01	CHECKED BY	DATE		
		1 PLACE	± 0.3	± .01	JMACEIL	10/02/06		
		ANGULAR ±1/2°		APPROVED BY	DATE			
				RDROSS	10/04/06			
		DRAFT WHERE APPLICABLE MUST REMAIN WITHIN DIMENSIONS		MATERIAL NO.	DOCUMENT NO.		SHEET NO.	
				SEE CHART	SD-19203-042		1 OF 1	
		THIS DRAWING CONTAINS INFORMATION THAT IS PROPRIETARY TO MOLEX INCORPORATED AND SHOULD NOT BE USED WITHOUT WRITTEN PERMISSION						