

Excellent Integrated System Limited

Stocking Distributor

Click to view price, real time Inventory, Delivery & Lifecycle Information:

[Sumida Corporation](#)

[CDPH45D16FHF-100MC](#)

For any questions, you can email us directly:

sales@integrated-circuit.com

SMD Power Inductor CDPH45D16F



Halogen Free

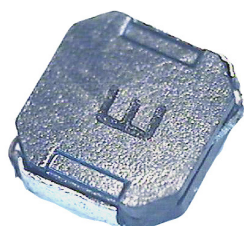

Description

- Ferrite core construction.
- Magnetically shielded.
- L × W × H: 4.9 × 4.7 × 1.8 mm Max.
- Product weight: 0.15g(Ref.)
- Moisture Sensitivity Level: 1
- RoHS compliance.
- Halogen Free available.

Dimension - [mm]

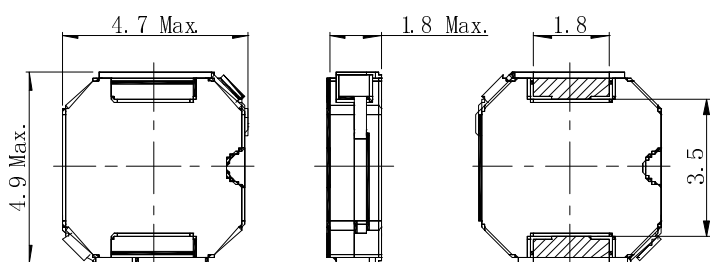

Environmental Data

- Operating temperature range: -40°C~+105°C (including coil's self temperature rise)
- Storage temperature range: -40°C~+105°C
- Solder reflow temperature: 260 °C peak.

Packaging

- Carrier tape and reel packaging.
- 7.0" diameter reel
- 1000pcs per reel

Land pattern and Schematics - [mm]

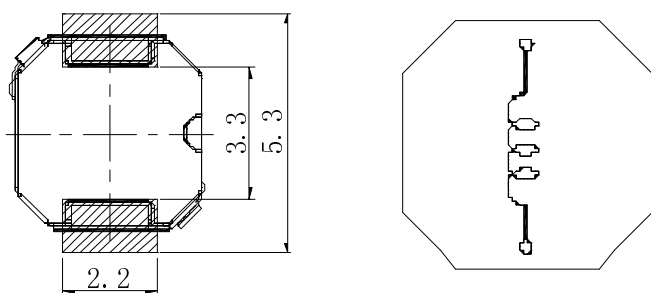

Applications

- Ideally used in Mobile phone, PDA, HDD etc.

Electrical Characteristics

Part No.	Stamp	Inductance (μ H) [Within] ※1	D.C.R. (m Ω) [Max.] (Typ.)	DC Saturation current (A) ※2	Temperature rise current (A) ※3
CDPH45D16FHF-4R3MC	E	4.3 ± 20%	85 (68)	2.00 (2.50)	2.00 (2.25)
CDPH45D16FHF-6R8MC	F	6.8 ± 20%	138 (110)	1.45 (1.80)	1.45 (1.65)
CDPH45D16FHF-8R2MC	G	8.2 ± 20%	150 (120)	1.35 (1.70)	1.45 (1.65)
CDPH45D16FHF-100MC	J	10.0 ± 20%	161 (129)	1.30 (1.60)	1.45 (1.65)
CDPH45D16FHF-120MC	K	12.0 ± 20%	233 (186)	1.20 (1.55)	1.05 (1.20)
CDPH45D16FHF-150MC	L	15.0 ± 20%	341 (273)	1.10 (1.40)	0.90 (1.05)
CDPH45D16FHF-180MC	M	18.0 ± 20%	375 (300)	0.90 (1.15)	0.90 (1.00)
CDPH45D16FHF-220MC	N	22.0 ± 20%	393 (314)	0.90 (1.10)	0.90 (1.00)

※1. Inductor measuring condition: at 100kHz.

※2. Saturation current: The value of D.C. current when the inductance decreases to 70% of it's nominal value.

※3. Temperature rise current: The value of D.C. current when the temperature rise is $\Delta t = 40^\circ\text{C}$ ($T_a = 20^\circ\text{C}$).

SMD Power Inductor CDPH45D16F

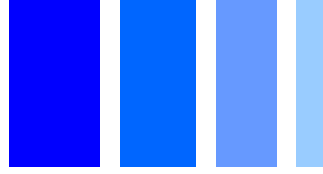

Saturation Current & Temperature Rise Graph

— L (20°C) — ΔT

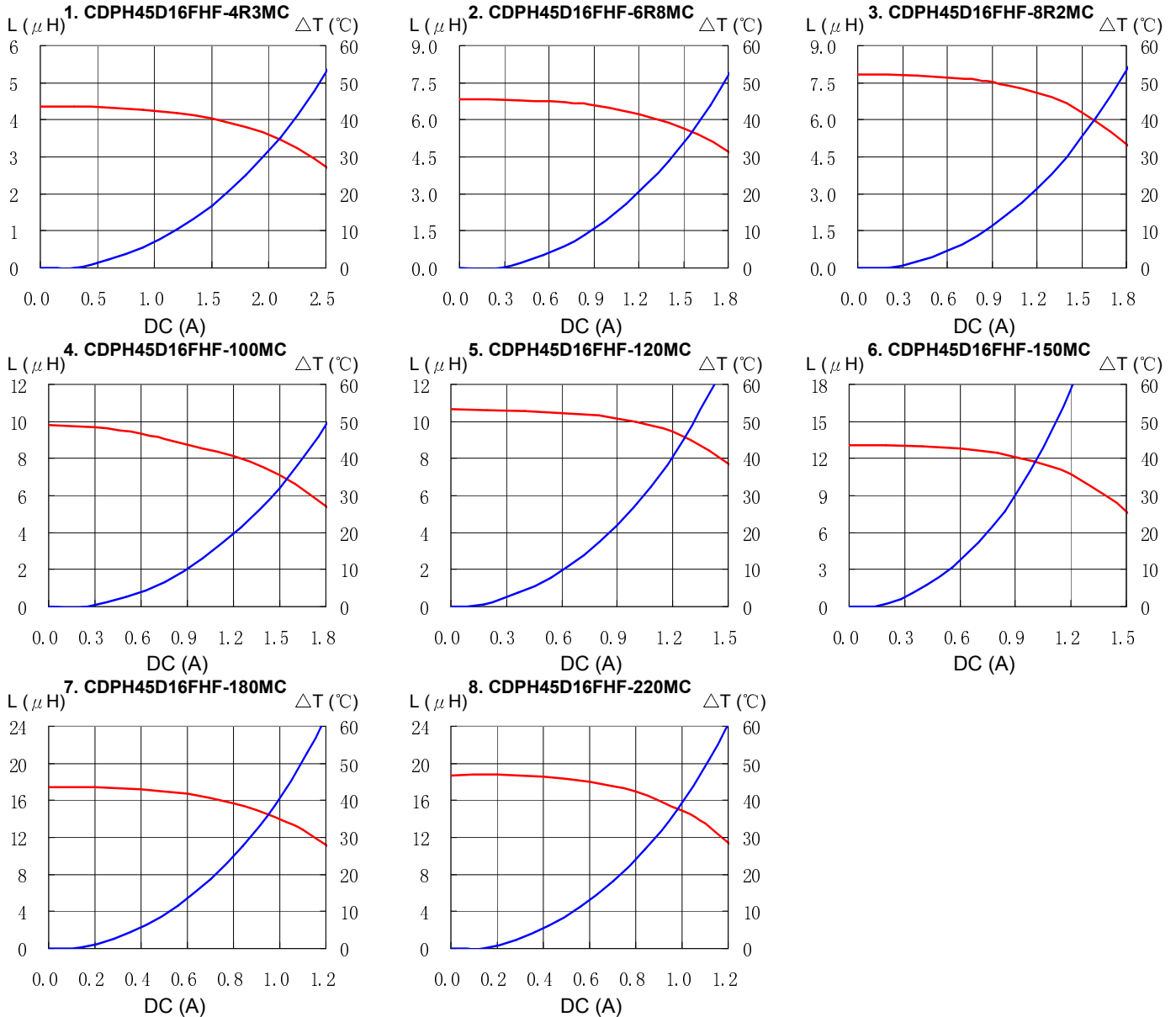

SMD Power Inductor CDPH45D16F



Solder Reflow Condition

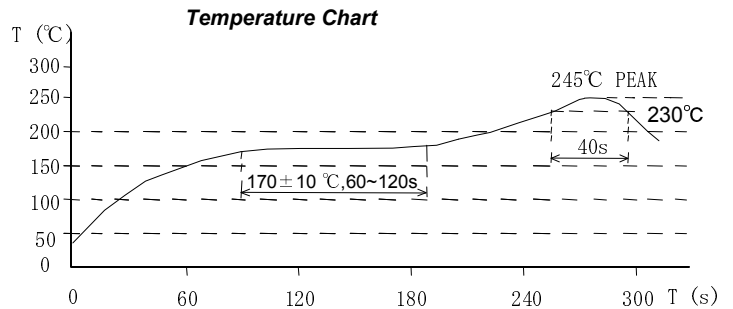
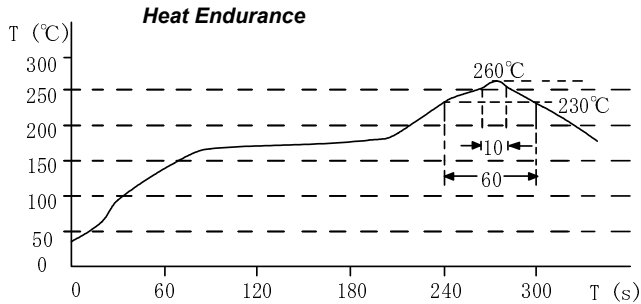

Please refer to the sales offices on our website - <http://www.sumida.com>

Hong Kong

Tel. +852-2880-6781
 FAX. +852-2565-9600
sales@hk.sumida.com

Saitama(Japan)

Tel. +81-48-691-7300
 FAX. +81-48-691-7340
sales@jp.sumida.com

Chicago

Tel. +1-847-545-6700
 FAX. +1-847-545-6720
sales@us.sumida.com

Shanghai

Tel. +86-21-5836-3299
 FAX. +86-21-5836-3266
shanghai.sales@cn.sumida.com

Seoul

Tel. +82-2-6237-0777
 FAX. +82-2-6237-0778
sales@kr.sumida.com

Oberzell

Tel. +49-8591-937-0
 FAX. +49-8591-937-103
contact@eu.sumida.com

Shenzhen

Tel. +86-755-8291-0228
 FAX. +86-755-8291-0338
shenzhen.sales@cn.sumida.com

Singapore

Tel. +65-6296-3388
 FAX. +65-6841-4426
sales@sg.sumida.com

Neumarkt

Tel. +49-9181-4509-110
 FAX. +49-9181-4509-310
infocomp@eu.sumida.com

Taipei

Tel. +886-2-8751-2737
 FAX. +886-2-8751-2738
sales@tw.sumida.com

San Jose

Tel. +1-408-321-9660
 FAX. +1-408-321-9308
sales@us.sumida.com