

Excellent Integrated System Limited

Stocking Distributor

Click to view price, real time Inventory, Delivery & Lifecycle Information:

[Molex Connector Corporation](#)
[0394850005](#)

For any questions, you can email us directly:

sales@integrated-circuit.com

10 9 8 7 6 5 4 3 2 39485

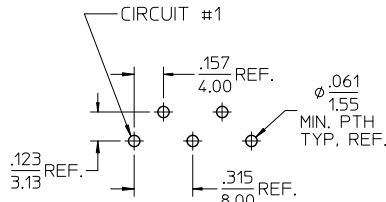
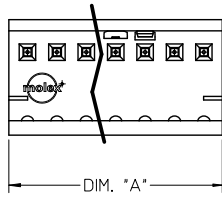
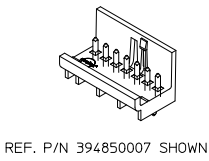

RECOMMENDED PCB FOOTPRINT
(5 CIRCUIT SHOWN)

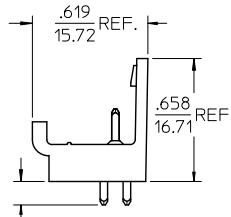
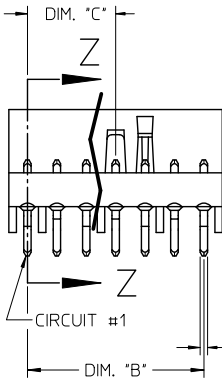

| CIRCUIT SIZE | HEADER ASSEMBLY MATERIAL NO. | DIM "A" | DIM "B" | DIM "C" |
|--------------|------------------------------|-------------|-------------|-------------|
| 2 | 39485-0002 | .356/9.03 | .158/4.00 | .000/0.00 |
| 3 | 39485-0003 | .513/13.03 | .315/8.00 | .000/0.00 |
| 4 | 39485-0004 | .671/17.03 | .473/12.00 | .158/4.00 |
| 5 | 39485-0005 | .828/21.03 | .630/16.00 | .315/8.00 |
| 6 | 39485-0006 | .986/25.03 | .788/20.00 | .315/8.00 |
| 7 | 39485-0007 | 1.143/29.03 | .945/24.00 | .473/12.00 |
| 8 | 39485-0008 | 1.301/33.03 | 1.103/28.00 | .473/12.00 |
| 9 | 39485-0009 | 1.458/37.03 | 1.260/32.00 | .630/16.00 |
| 10 | 39485-0010 | 1.616/41.03 | 1.418/36.00 | .630/16.00 |
| 11 | 39485-0011 | 1.773/45.03 | 1.575/40.00 | .788/20.00 |
| 12 | 39485-0012 | 1.931/49.03 | 1.733/44.00 | .788/20.00 |
| 13 | 39485-0013 | 2.088/53.03 | 1.890/48.00 | .945/24.00 |
| 14 | 39485-0014 | 2.246/57.03 | 2.048/52.00 | .945/24.00 |
| 15 | 39485-0015 | 2.403/61.03 | 2.205/56.00 | 1.103/28.00 |
| 16 | 39485-0016 | 2.561/65.03 | 2.363/60.00 | 1.103/28.00 |
| 17 | 39485-0017 | 2.718/69.03 | 2.520/64.00 | 1.260/32.00 |
| 18 | 39485-0018 | 2.876/73.03 | 2.678/68.00 | 1.260/32.00 |
| 19 | 39485-0019 | 3.033/77.03 | 2.835/72.00 | 1.418/36.00 |
| 20 | 39485-0020 | 3.191/81.03 | 2.993/76.00 | 1.418/36.00 |
| 21 | 39485-0021 | 3.348/85.03 | 3.150/80.00 | 1.575/40.00 |
| 22 | 39485-0022 | 3.506/89.03 | 3.308/84.00 | 1.575/40.00 |
| 23 | 39485-0023 | 3.663/93.03 | 3.465/88.00 | 1.733/44.00 |
| 24 | 39485-0024 | 3.821/97.03 | 3.623/92.00 | 1.733/44.00 |

NOTES: (D)

1. MATERIALS: SEE CHART.
2. FINISHES: SEE CHART.
3. PRODUCT SPECIFICATION: PS-39484-001.
4. MATES WITH TIN PLATED SERIES 39484 PLUG ASSEMBLIES.
5. ALL DIMENSIONS ARE REFERENCE.
6. ALL MATERIALS AND FINISHES ARE ROHS COMPLIANT.

| ITEM # | QTY. | DESCRIPTION | MATERIAL & FINISH |
|--------|------|-------------|-------------------------------------|
| 2 | XX | HEADER PIN | COPPER ALLOY, 100µ" TIN PLATED |
| 1 | 1 | HEADER BODY | GLASS FILLED POLYAMIDE 6T/66, BLACK |

| | | | | | | | | | |
|---|-------------------------------|---|---------|---------------------------|--------------------|--|----------------------|------------------------|--|
| REV. NOTES: TB WAS MAP EC NO: WNA2012-0110 DRAWN BY: DRWINSTONE CHKD BY: JOZNIK APPR'D BY: TILUS | QUALITY SYMBOLS ▽=0 ▽=0 | GENERAL TOLERANCES (UNLESS SPECIFIED) | | DIMENSION STYLE IN/MM | | SCALE 2:1 | DESIGN UNITS INCH | THIRD ANGLE PROJECTION | |
| | | 4 PLACES ± --- ± --- 3 PLACES ± --- ± .015 2 PLACES ± 0.38 ± --- 1 PLACE ± --- ± --- | mm INCH | DRAWN BY C. YORK | DATE 2008/05/21 | TITLE 4.00MM HEADER ASSEMBLY TIN PLATING | | | |
| | | ANGULAR ± 1° | | CHECKED BY R. DEROSS | DATE 2008/05/21 | APPROVED BY R. DEROSS | | | |
| | | DRAFT WHERE APPLICABLE MUST REMAIN WITHIN DIMENSIONS | | MATERIAL NO. SEE CHART | | DOCUMENT NO. SD-39485-001 | | MOLEX INCORPORATED | |

THIS DRAWING CONTAINS INFORMATION THAT IS PROPRIETARY TO MOLEX INCORPORATED AND SHOULD NOT BE USED WITHOUT WRITTEN PERMISSION

9 8 7 6 5 4 3 2 1