

Excellent Integrated System Limited

Stocking Distributor

Click to view price, real time Inventory, Delivery & Lifecycle Information:

[Molex Connector Corporation](#)
[0503518010](#)

For any questions, you can email us directly:

sales@integrated-circuit.com

注記
NOTES

1. 適合ハウジング : 51103 シリーズ
APPLICABLE HOUSING : 51103 SERIES
2. 材料 : リン青銅, 錫メッキ材 (t=0.2)
MATERIAL : PRE-TINNED PHOSPHOR BRONZE (t=0.2)
3. 適用電線サイズ AWG #26
WIRE SIZE
被覆外径 $\phi 0.93 \sim 1.03$
INS RANGE
4. ELV及びRoHS適合品
ELV AND RoHS COMPLIANT

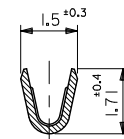
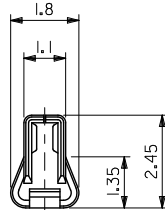
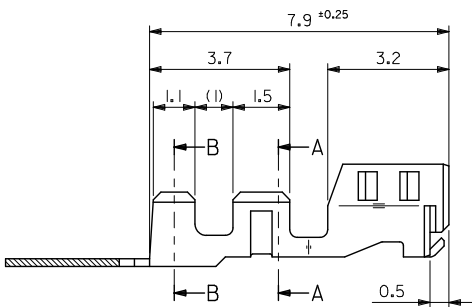
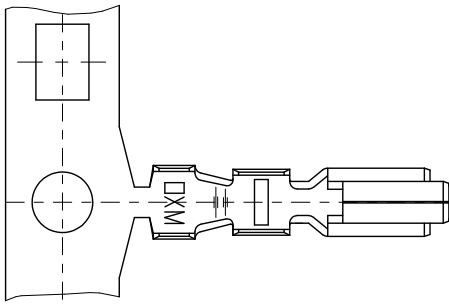

断面 A-A
SECT. A-A

断面 B-B
SECT. B-B

PLASTIC BAG	50351-8110	バラ状 LOOSE
REEL	50351-8010	連続状 CHAIN
PACKAGING SPEC.	オーダー番号 ORDER NO.	形態 FORM

CONNECTOR SERIES NO. 50351-8*10

REVISED EC NO. J2010-1995 DRAWN BY NYOSHIIKAWA 2010/04/02 CHECKED BY CHIKIDAKAKAWA 2010/04/02 APPROVED BY NUKITA 2010/04/05	GENERAL TOLERANCES (UNLESS SPECIFIED)		DIMENSION STYLE MM ONLY		SCALE ---	DESIGN UNITS METRIC	THIRD ANGLE PROJECTION
	10 UNDER	± 0.2	DRAWN BY NYOSHIIKAWA	DATE 2009/06/11	TITLE 2.5 W/B CONN.CRIMP REC.		
	10 OVER 30 UNDER	± 0.25	CHECKED BY THARUYAMA	DATE 2009/06/11	MATERIAL NO. SEE CHART		
	30 OVER	± 0.3	APPROVED BY NUKITA	DATE 2009/06/11	DOCUMENT NO. SD-50351-002		
A	ANGULAR ±3 ° DRAFT WHERE APPLICABLE MUST REMAIN WITHIN DIMENSIONS		SIZE A3		SHEET NO. 1 OF 1		