

Excellent Integrated System Limited

Stocking Distributor

Click to view price, real time Inventory, Delivery & Lifecycle Information:

[Molex Connector Corporation](#)
[0511031500](#)

For any questions, you can email us directly:

sales@integrated-circuit.com

DWG. NO. SD-51103-020

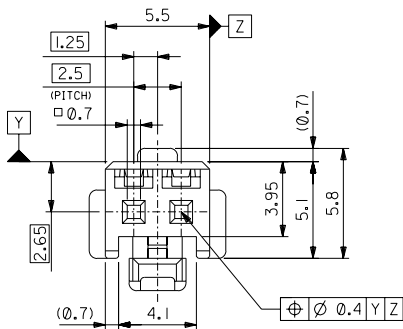
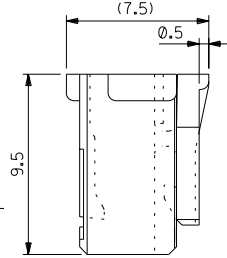
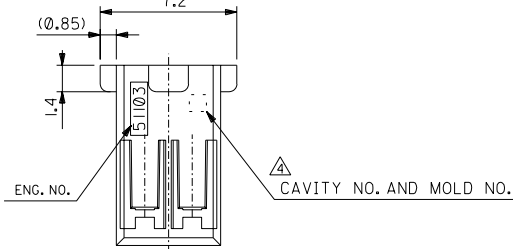
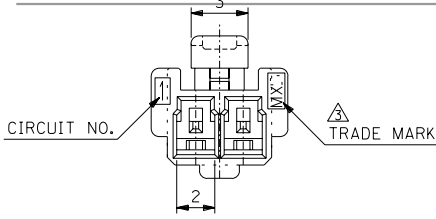

注記 NOTES

1. 適合ターミナル: 50351-8*00
APPLICABLE TERMINAL: 50351-8*00
2. 嵌合相手: 53464 シリーズ
MATE WITH: 53464 SERIES.
3. MXJと表示。
INDICATE MXJ.
4. キャビティー番号: 1桁~2桁の数字
金型番号: アルファベット1文字にて構成。(例, 1A, 10B)
FORMED BY 1 DIGIT TO 2 DIGIT NUMBERS (TO CAVITY NO.)
AND BY 1 LETTER OF ALPHABET (TO MOLD NO.).
(e.g., 1A, 10B)
5. 製品番号の末尾は製品の色を示す
LAST NUMBER OF DWG.NO. MEANS PART COLLER.

51103-**25
色番号 COLLER CODE
5 蛍光灰色 GRAY

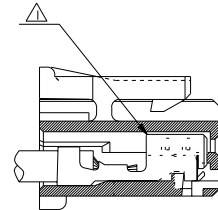

ターミナル装着状態図
TERMINAL ASSEMBLY DRAWING

51103-0225	2
MATERIAL NO.	NO. OF CIRCUIT

DO NOT SCALE DRAWING

8	7	6	5	4	3	2	1
ENG. NO. DRAWN: CHK'G: APPR:	ENG. NO. DRAWN: CHK'G: APPR:	ENG. NO. DRAWN: CHK'G: APPR:	ENG. NO. DRAWN: CHK'G: APPR:	ENG. NO. DRAWN: CHK'G: APPR:	ENG. NO. DRAWN: CHK'G: APPR:	ENG. NO. DRAWN: CHK'G: APPR:	ENG. NO. DRAWN: CHK'G: APPR:

MATERIAL 材料 POLYBUTYLENE TEREPHTHALATE UL94V-0	FINISH 仕上り	WIRE RANGE 適用電線範囲	INS. RANGE 適用外径
RELEASED '02/11/22 DRAWN: NITO CHK'G: K.SAKAWA APPR: T.YAMAGUCHI			

GENERAL TOLERANCES: (UNLESS SPECIFIED) 一般公差	SCALE 5 : 1	DESIGN UNITS mm INCH
10 UNDER 未満 +0.2	DRAWN BY & DATE NITO '02/11/22	TITLE: 2.5 WIRE TO BOARD CONN. HOUSING (POSITIVE LOCK)
10 OVER 以上 30 UNDER 未満 +0.25	CHECKED BY & DATE K.SAKAWA '02/11/22	APPROVED BY & DATE T.YAMAGUCHI '02/11/22
30 OVER 以上 +0.3	CAD FILENAME SD-51103-020.S01	MATERIAL NO. SEE CHART
ANGLE 角度 ±3°		DRAWING NO. SD-51103-020

DIMENSIONS: mm INCH		SHT CAD ONLY	REV CAD ONLY
MOLEX INCORPORATED		SHEET NO. 1 OF 1	SIZE B
MATERIAL NO. SEE CHART		EN-02J(097) MXJ-54	

A
1511031500-020.S01

10 9 8 7 6 5 4 3 2 1

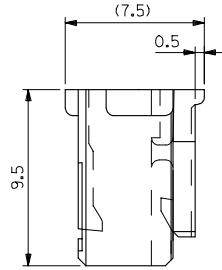
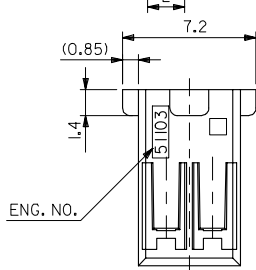
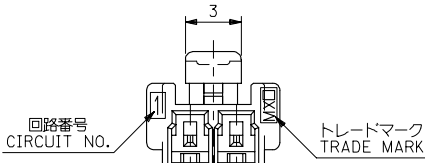

注記 NOTES

- △ 適合ターミナル : 50351-8*00
APPLICABLE TERMINAL : 50351-8*00
2. 嵌合相手 : 53375,53426 シリーズ
MATE WITH : 53375,53426 SERIES
- △ 偶数極の製品に適用。
APPLY EVEN CIRCUIT PRODUCTS.
4. 製品型番の下1桁は色を表す。
LAST DIGIT OF PART NUMBER INDICATES COLOR.
0 : 白 WHITE 1 : 黒 BLACK 2 : 赤 RED
3 : 黄 YELLOW 4 : 青 BLUE

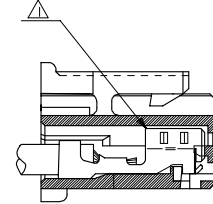

ターミナル装着状態図
TERMINAL ASSEMBLY DRAWING

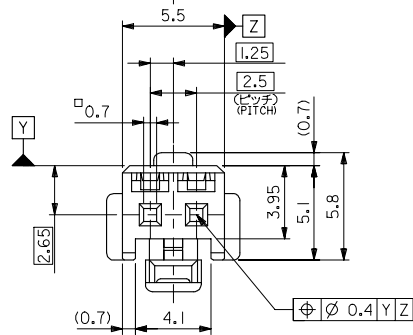

2極に適用
FOR 2 CKTS.

51103-020*	2
MATERIAL NO.	CIRCUIT
◎ THIRD ANGLE PROJECTION	

RELEASED EC NO. : J2005-2009 DRAWN BY M.UMEDA 2005/02/04 CHKD BY K.TOYODA 2005/02/04 APP. BY N.UKITA 2005/02/14 REV.	GENERAL TOLERANCES (UNLESS SPECIFIED)		DIMENSION STYLE MM ONLY	SCALE ---	DESIGN UNITS METRIC	TITLE 2.5 W/B CONN. HOUSING (POSITIVE LOCK)
	10 UNDER	± 0.2	DRAWN BY M.UMEDA	DATE 2005/01/14	MOLEX INCORPORATED	
	10 OVER 30 UNDER	± 0.25	CHECKED BY K.TOYODA	DATE 2005/01/14		
	30 OVER	± 0.3	APPROVED BY N.UKITA	DATE 2005/01/14	MATERIAL NO. SEE CHART	DOCUMENT NO. SD-51103-021
ANGULAR ± 3 °		DRAFT WHERE APPLICABLE MUST REMAIN WITHIN DIMENSIONS		THIS DRAWING CONTAINS INFORMATION THAT IS PROPRIETARY TO MOLEX INCORPORATED AND SHOULD NOT BE USED WITHOUT WRITTEN PERMISSION		

9 8 7 6 5 4 3 2 1 EN-02JA(021)

10 9 8 7 6 5 4 3 2 1

F
E
D
C
B
A

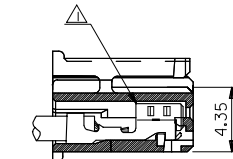
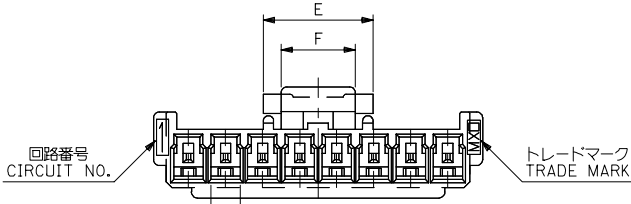

ターミナル装着状態図
TERMINAL ASSEMBLY DRAWING

注記 NOTES

- △ 適合ターミナル : 50351-8*00
APPLICABLE TERMINAL : 50351-8*00
2. 嵌合相手 : 53375,53426 シリーズ
MATE WITH : 53375,53426 SERIES
- △ 偶数極の製品に適用。
APPLY EVEN CIRCUIT PRODUCTS.
4. 製品型番の下1桁は色を表す。
LAST DIGIT OF PART NUMBER INDICATES COLOR.
0 : 白 WHITE 1 : 黒 BLACK 2 : 赤 RED
3 : 黄 YELLOW 4 : 青 BLUE

3-15 極に適用
FOR 3-15 CKTS.

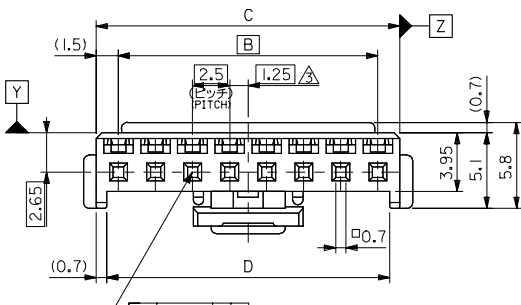
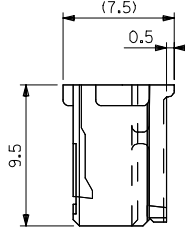
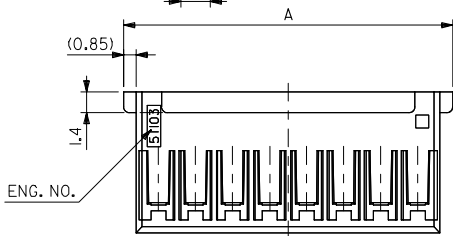

5	7.4	36.6	38	35	39.7	51103-150*	15
↑	↑	34.1	35.5	32.5	37.2	↑ -140*	14
		31.6	33	30	34.7	↑ -130*	13
		29.1	30.5	27.5	32.2	↑ -120*	12
		26.6	28	25	29.7	↑ -110*	11
		24.1	25.5	22.5	27.2	↑ -100*	10
		21.6	23	20	24.7	↑ -090*	9
		19.1	20.5	17.5	22.2	↑ -080*	8
		16.6	18	15	19.7	↑ -070*	7
		14.1	15.5	12.5	17.2	↑ -060*	6
		11.6	13	10	14.7	↑ -050*	5
5	7.4	9.1	10.5	7.5	12.2	↓ -040*	4
3	5	6.6	8	5	9.7	51103-030*	3
F	E	D	C	B	A	MATERIAL NO.	CIRCUIT

RELEASED EC NO: J2005-2009 DRAWN BY: M.UMEDA CHK'D BY: K.TOYODA APPR'D BY: N.UKITA DATE: 2005/02/02 DATE: 2005/02/04 DATE: 2005/02/14	GENERAL TOLERANCES (UNLESS SPECIFIED)		DIMENSION STYLE	SCALE	DESIGN UNITS	THIRD ANGLE PROJECTION	
			MM ONLY	---	METRIC	☉	
	10 UNDER	± 0.2	DRAWN BY	DATE	TITLE		
	10 OVER 30 UNDER	± 0.25	M.UMEDA	2005/01/14	2.5 W/B CONN. HOUSING (POSITIVE LOCK)		
	30 OVER	± 0.3	CHECKED BY	DATE	MATERIAL NO.		
ANGULAR ± 3 °		K.TOYODA	2005/01/14	MOLEX INCORPORATED			
DRAFT WHERE APPLICABLE MUST REMAIN WITHIN DIMENSIONS		APPROVED BY	DATE	DOCUMENT NO.			
		N.UKITA	2005/01/14	SD-51103-021			
		MATERIAL NO.	SEE CHART	SHEET NO.			
		SIZE	A3	2 OF 2			
THIS DRAWING CONTAINS INFORMATION THAT IS PROPRIETARY TO MOLEX INCORPORATED AND SHOULD NOT BE USED WITHOUT WRITTEN PERMISSION							

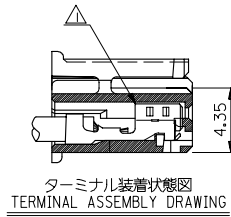
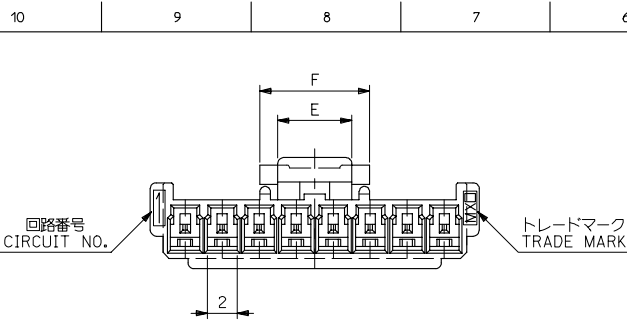

注記 NOTES

- △ 適合ターミナル : 50351-8*00
APPLICABLE TERMINAL : 50351-8*00
- 2. 嵌合相手 : 53375,53376,53388,53389
53426 シリーズ
MATE WITH : 53375,53376,53388,53389
53426 SERIES
- △ 偶数極の製品に適用。
APPLY EVEN CIRCUIT PRODUCTS.

3-15 極に適用
FOR 3-15 CKTS.

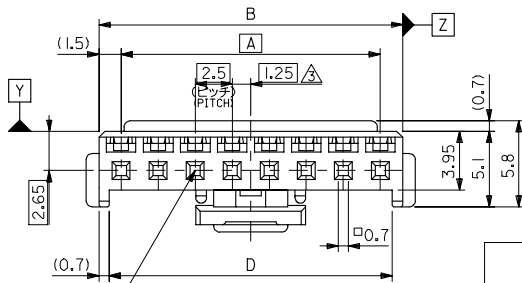
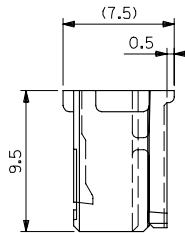
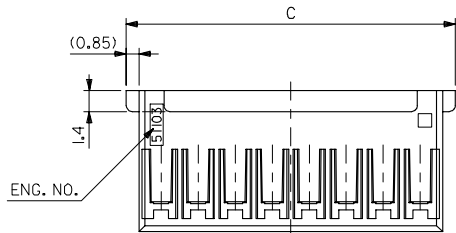

7.4	5	36.6	39.7	38	35	51103-1500	15
↑	↑	34.1	37.2	35.5	32.5	↑ -1400	14
		31.6	34.7	33	30	↑ -1300	13
		29.1	32.2	30.5	27.5	↑ -1200	12
		26.6	29.7	28	25	↑ -1100	11
		24.1	27.2	25.5	22.5	↑ -1000	10
		21.6	24.7	23	20	↑ -0900	9
		19.1	22.2	20.5	17.5	↑ -0800	8
		16.6	19.7	18	15	↑ -0700	7
		14.1	17.2	15.5	12.5	↑ -0600	6
		11.6	14.7	13	10	↑ -0500	5
7.4	5	9.1	12.2	10.5	7.5	↑ -0400	4
5	3	6.6	9.7	8	5	51103-0300	3
F	E	D	C	B	A	MATERIAL NO.	極数 OF CKT.

材料 MATERIAL
PBTP, UL94V-0
(色 WHITE)

仕上り FINISH —

適用電線範囲 WIRE RANGE —

被覆外径 INS. RANGE —

REVISED EC NO: J2005-3799	2005/06/20 DRAWN/MADE CHIKO KUYODA	2005/06/21 APPR/CHK/ITA	2005/06/27	DESCRIPTION	GENERAL TOLERANCES (UNLESS SPECIFIED)	10 UNDER ±0.2	10 OVER 30 UNDER ±0.25	30 OVER ±0.3	ANGULAR ±3 °	DRAFT WHERE APPLICABLE MUST REMAIN WITHIN DIMENSIONS	DIMENSION STYLE MM ONLY	SCALE 4:1	DESIGN UNITS METRIC	THIRD ANGLE PROJECTION
DRAWN BY T. ITO				DATE '92/05/06	TITLE 2.5 WIRE TO BOARD CONN HOUSING (POSITIVE LOCK)									
CHECKED BY H. HIRAMOTO				DATE '95/10/03	APPROVED BY M. FUKUSHIMA									
DATE '95/10/03				MATERIAL NO. SEE CHART										
DOCUMENT NO. SD-51103-023				SHEET NO. 1 OF 2										
SIZE A3 THIS DRAWING CONTAINS INFORMATION THAT IS PROPRIETARY TO MOLEX INCORPORATED AND SHOULD NOT BE USED WITHOUT WRITTEN PERMISSION														

10 9 8 7 6 5 4 3 2 1

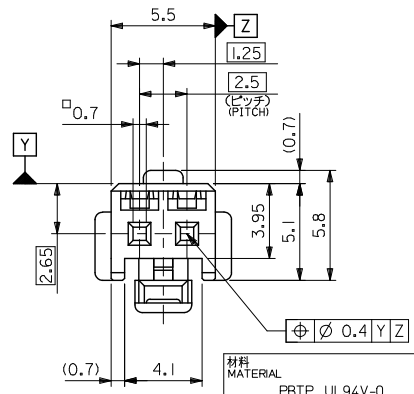
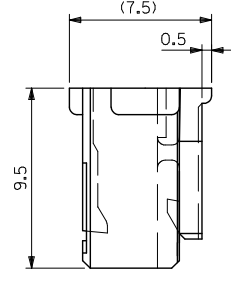
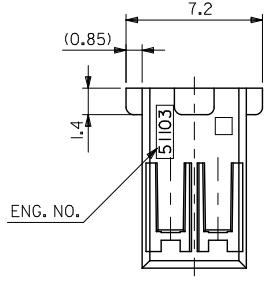
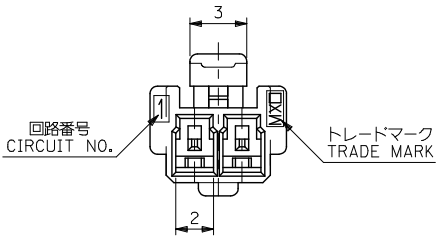

注記 NOTES

- △ 適合ターミナル: 50351-8*00
APPLICABLE TERMINAL: 50351-8*00
- 2. 嵌合相手: 53375,53426 シリーズ
MATE WITH: 53375,53426 SERIES

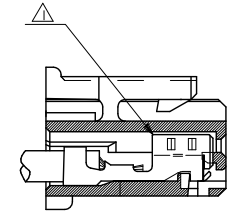

ターミナル装着状態図
TERMINAL ASSEMBLY DRAWING

2極に適用
FOR 2 CKTS.

材料 MATERIAL	PBTP, UL94V-0 (白色 WHITE)
仕上げ FINISH	—
適用電線範囲 WIRE RANGE	—
被覆外径 INS. RANGE	—

REVISED REV. NO. J2005-3799 DRAWN BY: 2005/06/20 CHKD BY: 2005/06/21 APPR. BY: 2005/06/27	DESCRIPTION	GENERAL TOLERANCES (UNLESS SPECIFIED)	DIMENSION STYLE	SCALE	DESIGN UNITS	51103-0200	2
		10 UNDER ±0.2	MM ONLY	5:1	METRIC	MATERIAL NO.	NO. OF CKTS.
		10 OVER 30 UNDER ±0.25	DRAWN BY DATE	T. ITO '92/05/06	TITLE	2.5 WIRE TO BOARD CONN HOUSING (POSITIVE LOCK)	
		30 OVER ±0.3	CHECKED BY DATE	H. HIRAMOTO '95/10/03			
		ANGULAR ±3°	APPROVED BY DATE	M. FUKUSHIMA '95/10/03	Molex	MOLEX INCORPORATED	
		DRAFT WHERE APPLICABLE MUST REMAIN WITHIN DIMENSIONS	MATERIAL NO.	SEE CHART	DOCUMENT NO.	SD-51103-023	SHEET NO. 2 OF 2
			SIZE	THIS DRAWING CONTAINS INFORMATION THAT IS PROPRIETARY TO MOLEX INCORPORATED AND SHOULD NOT BE USED WITHOUT WRITTEN PERMISSION			