

Excellent Integrated System Limited

Stocking Distributor

Click to view price, real time Inventory, Delivery & Lifecycle Information:

[Molex Connector Corporation](#)
[0511420600](#)

For any questions, you can email us directly:

sales@integrated-circuit.com

10 9 8 7 6 5 4 3 2 1

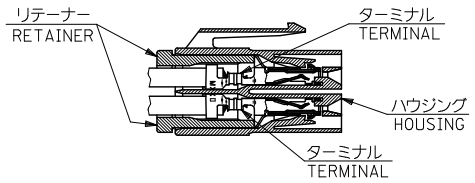
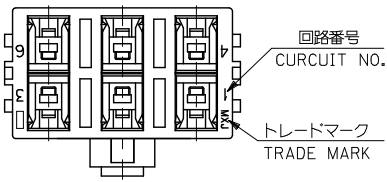

ターミナル及びリテーナー装着状態図
TERMINAL & RETAINER ASSEMBLY DRAWING

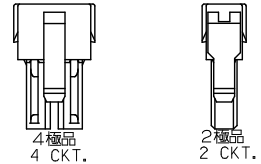
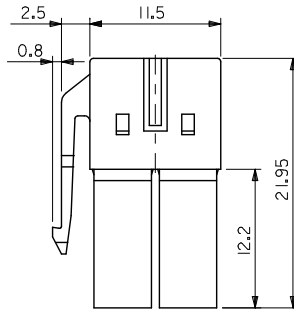
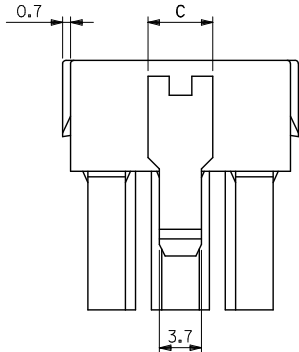

ロック形状図
LOCK CONFIGURATION

注記
NOTES

- 適合ターミナル : 50597, 50598
APPLICABLE TERMINAL : 50597 , 50598
- 適合リテーナー : 51143
APPLICABLE RETAINER : 51143
- 嵌合相手 : 53721,53728 シリーズ
MATE WITH : 53721,53728 SERIES

5.7	19.34	13	51142-0600	6
3.7	12.84	6.5	51142-0400	4
5.7	6.34	—	51142-0200	2
C	B	A	ENG. NO.	極品 CKT.

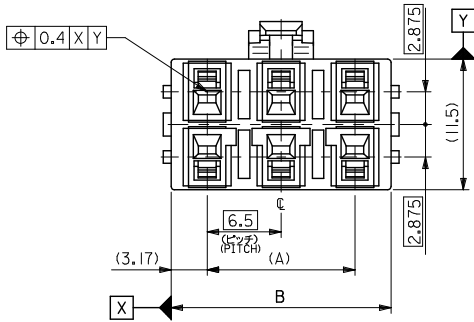

MATERIAL
PBTP, UL94V-0
(色 : 自然色)
(COLOR : NATURAL)

REVISED EC NO. J2013-0477 DRAWN BY CHIKO KASAKAWA APPR. YOITO REV A	GENERAL TOLERANCES (UNLESS SPECIFIED)		DIMENSION STYLE MM ONLY		TITLE 6.5 WIRE TO BOARD CONN. RECEPTACLE HOUSING molex DOCUMENT NO. SD-51142-002 SHEET NO. 1 OF 1
	10 UNDER	± 0.2	DRAWN BY NITO	DATE 2012/10/24	
	10 OVER 30 UNDER	± 0.25	CHECKED BY KASAKAWA	DATE 2012/10/24	
	30 OVER	± 0.3	APPROVED BY YOITO	DATE 2012/10/24	
ANGULAR ± 3 °		DRAFT WHERE APPLICABLE MUST REMAIN WITHIN DIMENSIONS		MATERIAL NO. SEE CHART	THIS DRAWING CONTAINS INFORMATION THAT IS PROPRIETARY TO MOLEX INCORPORATED AND SHOULD NOT BE USED WITHOUT WRITTEN PERMISSION

9 8 7 6 5 4 3 2