

Excellent Integrated System Limited

Stocking Distributor

Click to view price, real time Inventory, Delivery & Lifecycle Information:

[Molex Connector Corporation](#)

[0511461800](#)

For any questions, you can email us directly:

sales@integrated-circuit.com

10 9 8 7 6 5 4 3 2 1

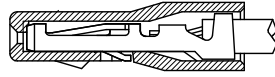
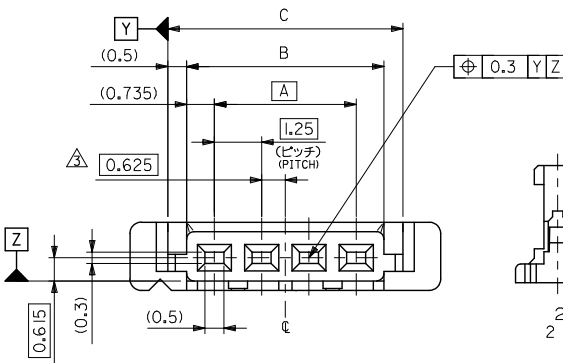

ターミナル装着状態図
TERMINAL ASSEMBLY DRAWING

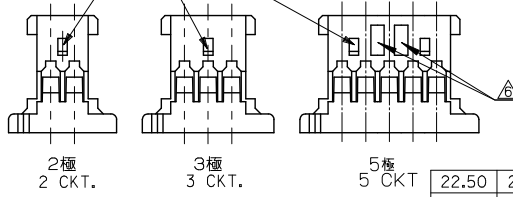

注記 NOTES

1. 嵌合相手: 53779-***10, 53780-***10
MATES: 53779-***10, 53780-***10
2. 適合ターミナル: 50641-8***
APPLICABLE TERMINAL: 50641-8***
3. 偶数種の製品に適用。
APPLY EVEN CIRCUIT PRODUCTS.
4. 材料: PBT, UL94V-0
MATERIAL
5. 及び 適合品
ELV AND RoHS COMPLIANT
6. 4極以上のロック間に於ける各極間に適用
APPLY TO RECESS SPACE BETWEEN EACH CKT WALL OVER THE 4CKT

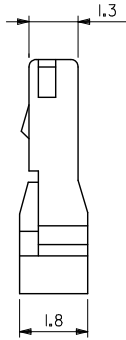
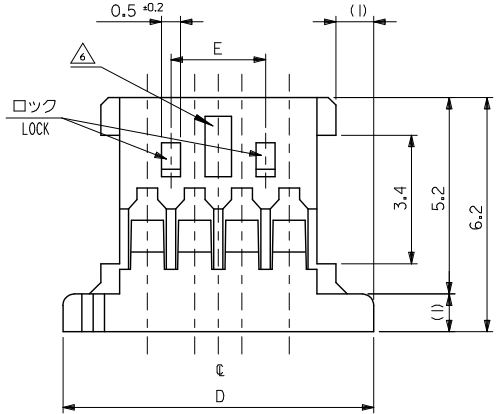

22.50	28.22	26.22	25.22	23.75	51146-2000	20
21.25	26.97	24.97	23.97	22.50	-1900	19
20.00	25.72	23.72	22.72	21.25	-1800	18
18.75	24.47	22.47	21.47	20.00	-1700	17
17.50	23.22	21.22	20.22	18.75	-1600	16
16.25	21.97	19.97	18.97	17.50	-1500	15
15.00	20.72	18.72	17.72	16.25	-1400	14
13.75	19.47	17.47	16.47	15.00	-1300	13
12.50	18.22	16.22	15.22	13.75	-1200	12
11.25	16.97	14.97	13.97	12.50	-1100	11
10.00	15.72	13.72	12.72	11.25	-1000	10
8.75	14.47	12.47	11.47	10.00	-0900	9
7.50	13.22	11.22	10.22	8.75	-0800	8
6.25	11.97	9.97	8.97	7.50	-0700	7
5.00	10.72	8.72	7.72	6.25	-0600	6
3.75	9.47	7.47	6.47	5.00	-0500	5
2.50	8.22	6.22	5.22	3.75	-0400	4
	6.97	4.97	3.97	2.50	-0300	3
	5.72	3.72	2.72	1.25	51146-0200	2
E	D	C	B	A	PLASTIC BAG	極数
					ORDER No. オオーダー番	CIRCUITS

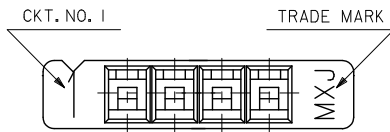

REVISED EC NO: J2016-0670 DRAWN: MATSUJIMA 2016/01/28 CHKD: APPR: TKANEKO 2016/01/29	GENERAL TOLERANCES (UNLESS SPECIFIED)		DIMENSION STYLE		SCALE	DESIGN UNITS	CONNECTOR SERIES No. 51146-***00 1.25 WIRE TO BOARD CONN. HOUSING molex SD-51146-001 SHEET NO. 1 OF 1
	0.25 UNDER	±0.03	MM ONLY		10:1	METRIC	
	0.25 OVER	0.5 UNDER ±0.05	DRAWN BY DATE		TITLE		
	0.5 OVER	1.0 UNDER ±0.1	Y. MIZUNO '95/12/25		THIRD ANGLE PROJECTION		
	1.0 OVER	10 UNDER ±0.2	CHECKED BY DATE				
	10 OVER	30 UNDER ±0.25	Y. MIZUNO '96/08/20				
30 OVER	±0.3	APPROVED BY DATE					
ANGULAR	±3°	TKANEKO 2016/01/29					
DRAFT WHERE APPLICABLE MUST REMAIN WITHIN DIMENSIONS			MATERIAL NO.		DOCUMENT NO.		
			SEE TABLE		SD-51146-001		
			SIZE A3		THIS DRAWING CONTAINS INFORMATION THAT IS PROPRIETARY TO MOLEX ELECTRONIC TECHNOLOGIES, LLC AND SHOULD NOT BE USED WITHOUT WRITTEN PERMISSION		

9 8 7 6 5 4 3 2 1