

## Excellent Integrated System Limited

Stocking Distributor

Click to view price, real time Inventory, Delivery & Lifecycle Information:

[Molex Connector Corporation](#)  
[0512160600](#)

For any questions, you can email us directly:

[sales@integrated-circuit.com](mailto:sales@integrated-circuit.com)

CONFIDENTIAL

ELV AND RoHS COMPLIANT

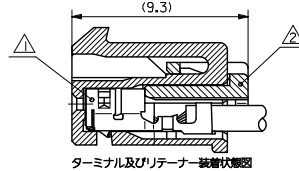
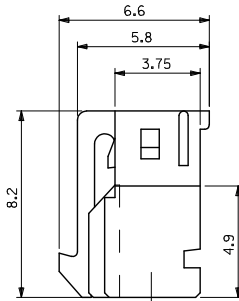
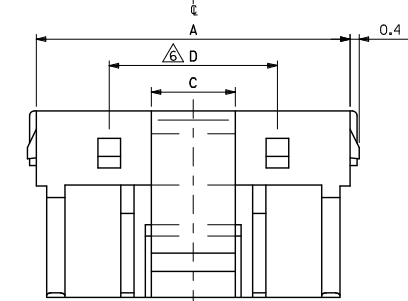
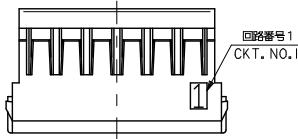
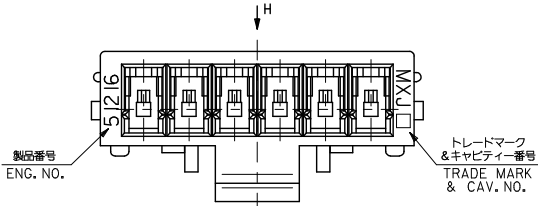

ターミナル及びリテーナー 接合状態図  
TERMINAL & RETAINER ASSEMBLY DRAWING

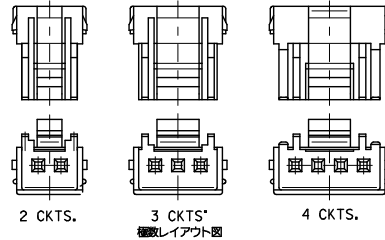
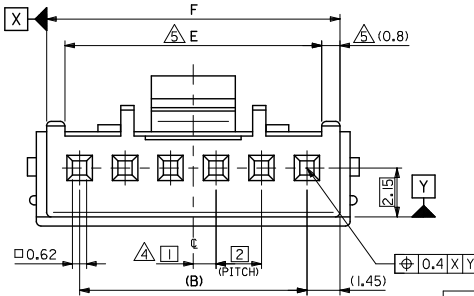

LAYOUT OF EACH CKTS.

- 注記 NOTES
- △ 適合ターミナル : 59370シリーズ  
APPLICABLE TERMINAL : 59370 SERIES
  - △ 適合リテーナー : 51217シリーズ  
APPLICABLE RETAINER : 51217 SERIES
  - 3. 嵌合相手 : 55487, 55755シリーズ  
MATE WITH : 55487, 55755
  - △ 偶数極に適用。  
APPLY EVEN CIRCUIT PRODUCTS.
  - △ 4~15極に適用。  
APPLY 4-15 CIRCUITS.
  - △ 5~15極に適用。  
APPLY 5-15 CIRCUITS.
  - 7. ELVおよびRoHS適合品  
ELV AND RoHS COMPLIANT
  - 8. ハッチングの色 (MATERIAL NO. の下1桁に対応) :  
HSG COLOR:
 

WHITE :	51216-***0
BLACK :	51216-***1
RED :	51216-***2
YELLOW :	51216-***3
BLUE :	51216-***4
GREEN :	51216-***6

30.9	29.3	7.4	3.7	28	31.8	51216-150*	15
28.9	27.3			26	29.8		-140*
26.9	25.3			24	27.8		-130*
24.9	23.3			22	25.8		-120*
22.9	21.3			20	23.8		-110*
20.9	19.3			18	21.8		-100*
18.9	17.3			16	19.8		-090*
16.9	15.3			14	17.8		-080*
14.9	13.3			12	15.8		-070*
12.9	11.3			10	13.8		-060*
10.9	9.3	7.4		8	11.8		-050*
8.9	7.3			6	9.8		-040*
6.9				4	7.8		-030*
4.9				2	5.8	51216-020*	2
				F	E	D	C
							B
							A
							MATERIAL NO.
							CKT.

材料 MATERIAL	PBTP, UL94V-0
仕上げ FINISH	—
適用電線範囲 WIRE RANGE	—
被覆外径 INS. RANGE	—

REVISED	2014/03/03
EC NO.	J2014-1352
DRW.	TAJIMA01
CHKD.	KAKAWA
APPR.	MUKITA
REV	2014/03/03
DESCRIPTION	
10 UNDER	±0.2
10 OVER 30 UNDER	±0.25
30 OVER	±0.3
ANGULAR	±3°
DRAFT WHERE APPLICABLE MUST REMAIN WITHIN DIMENSIONS	

DIMENSION STYLE		SCALE		DESIGN UNITS		THIRD ANGLE PROJECTION	
MM ONLY		---		METRIC		☉	
DRAWN BY	DATE	TITLE				SHEET NO.	
T. YASUI	'00/2/22	2.0MM WIRE TO BOARD RECEPTACLE HOUSING				1 OF 1	
CHECKED BY	DATE	<b>molex</b>				DOCUMENT NO. SD-51216-004	
T. YAMAGUCHI	'00/2/22						
APPROVED BY	DATE	SEE TABLE				THIS DRAWING CONTAINS INFORMATION THAT IS PROPRIETARY TO MOLEX INCORPORATED AND SHOULD NOT BE USED WITHOUT WRITTEN PERMISSION	
M. FUKUSHIMA	'00/2/22						
MATERIAL NO.							