

Excellent Integrated System Limited

Stocking Distributor

Click to view price, real time Inventory, Delivery & Lifecycle Information:

[Molex Connector Corporation](#)
[0559321530](#)

For any questions, you can email us directly:

sales@integrated-circuit.com

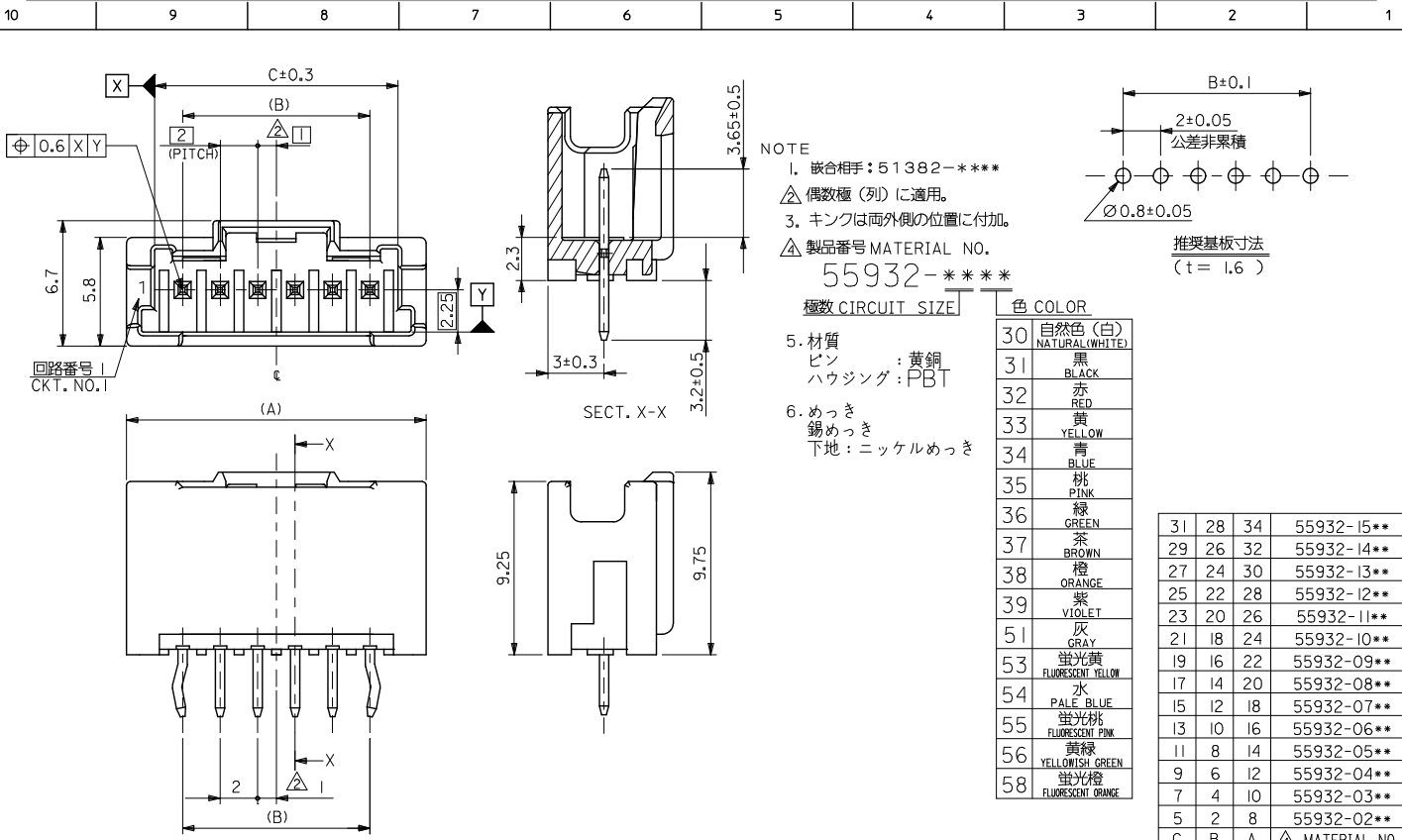

31	28	34	55932-15**	15
29	26	32	55932-14**	14
27	24	30	55932-13**	13
25	22	28	55932-12**	12
23	20	26	55932-11**	11
21	18	24	55932-10**	10
19	16	22	55932-09**	9
17	14	20	55932-08**	8
15	12	18	55932-07**	7
13	10	16	55932-06**	6
11	8	14	55932-05**	5
9	6	12	55932-04**	4
7	4	10	55932-03**	3
5	2	8	55932-02**	2

MODEL NO. : 55932-****

DESIGN UNITS: METRIC THIRD ANGLE PROJECTION

REVISED EC NO: J2015-0937 DRW: RMATSUYAMA 2015/10/05 CHK: KASAKAWA 2015/10/05 APPR: NIKITA 2015/10/26 REV: H	GENERAL TOLERANCES (UNLESS SPECIFIED)		DIMENSION STYLE		SCALE	2.0 W/B CONN. PLUG HOUSING ASS'Y ST -LEAD FREE- molex DOCUMENT NO. SD-55932-006 SHEET NO. 1 OF 2
	0.25 UNDER ±0.03		MM ONLY		---	
	0.25 OVER 0.5 UNDER ±0.05		DRAWN BY DATE		TITLE	
	0.5 OVER 1.0 UNDER ±0.1		T. NIITSU '02/02/08			
	1.0 OVER 10 UNDER ±0.2		CHECKED BY DATE			
10 OVER 30 UNDER ±0.25		K. ASAKAWA '03/06/12				
30 OVER ±0.3		APPROVED BY DATE				
ANGULAR ±3 °		T. YAMAGUCHI '03/06/12				
DRAFT WHERE APPLICABLE MUST REMAIN WITHIN DIMENSIONS		MATERIAL NO.		SEE CHART		
		SIZE A3		THIS DRAWING CONTAINS INFORMATION THAT IS PROPRIETARY TO MOLEX INCORPORATED AND SHOULD NOT BE USED WITHOUT WRITTEN PERMISSION		

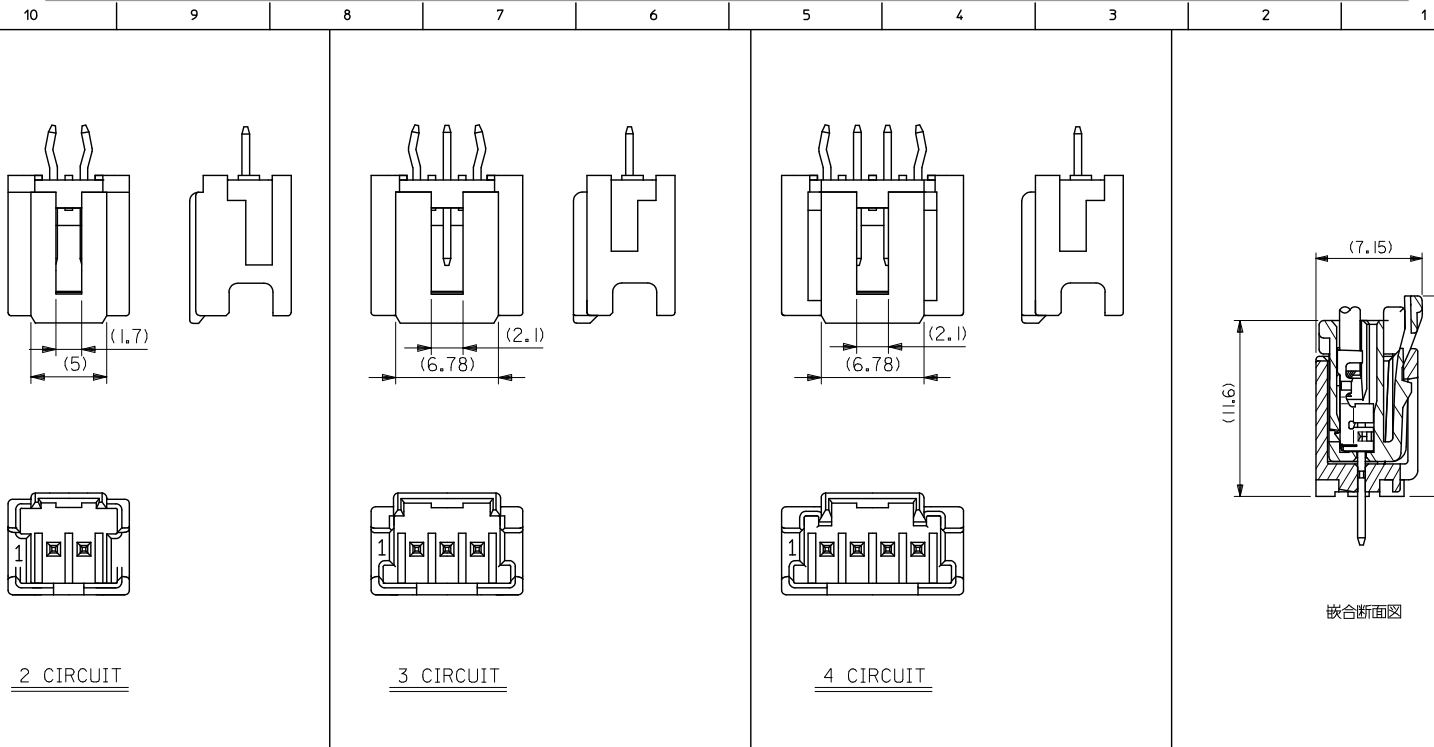

REVISED EC NO: J2015-0937 DRAWN BY: DRINKAMATSUYAMA 2015/10/05 CHECKED BY: CHIKIDAKAKAWA 2015/10/05 APPROVED BY: APPR:NIKIITA 2015/10/26	GENERAL TOLERANCES (UNLESS SPECIFIED)		DIMENSION STYLE		SCALE	DESIGN UNITS	THIRD ANGLE PROJECTION 2.0 W/B CONN. PLUG HOUSING ASS'Y ST -LEAD FREE- molex DOCUMENT NO. SD-55932-006 SHEET NO. 2 OF 2
	0.25 UNDER ±0.03		MM ONLY		---	METRIC	
	0.25 OVER	0.5 UNDER ±0.05	DRAWN BY DATE		TITLE		
	0.5 OVER	1.0 UNDER ±0.1	T.NIITSU '02/02/08		2.0 W/B CONN. PLUG HOUSING ASS'Y ST -LEAD FREE-		
	1.0 OVER	10 UNDER ±0.2	CHECKED BY DATE		K.ASAKAWA '03/06/12		
10 OVER	30 UNDER ±0.25	APPROVED BY DATE		T.YAMAGUCHI '03/06/12			
30 OVER	±0.3	MATERIAL NO.		SEE SHEET 1			
ANGULAR	±3 °	DRAFT WHERE APPLICABLE MUST REMAIN WITHIN DIMENSIONS		SIZE A3		THIS DRAWING CONTAINS INFORMATION THAT IS PROPRIETARY TO MOLEX INCORPORATED AND SHOULD NOT BE USED WITHOUT WRITTEN PERMISSION	

10 9 8 7 6 5 4 3 2 1

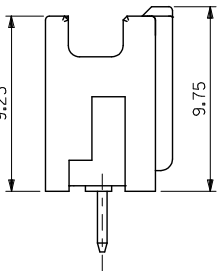
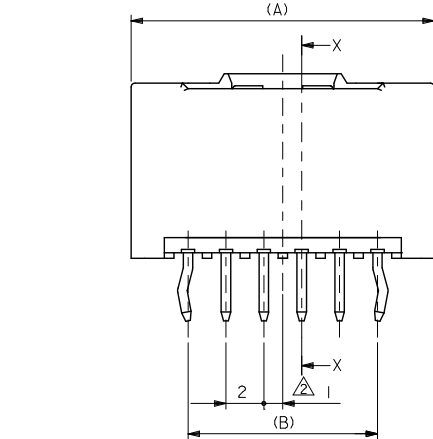
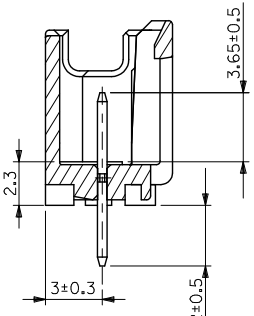
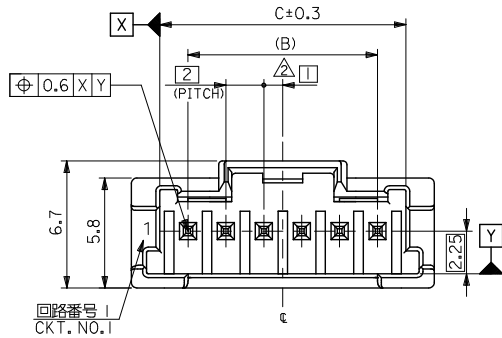

NOTE
 1. 嵌合相手: 51382-****
 2. 偶数極 (列) に適用。
 3. キングは両外側の位置に付加。
 4. ピン: 黄銅, ニッケル下地鍍メッキ
 ハウジング: PBT
 適合リテーナー: 500638シリーズ
 APPLICABLE RETAINER: 500638 SERIES.
 製品番号 MATERIAL NO.
55932-****
 極数 CIRCUIT SIZE

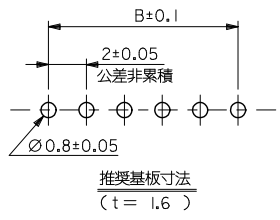

色 COLOR
30 自然色 (白) NATURAL (WHITE)
31 黒 BLACK
32 赤 RED
33 黄 YELLOW
34 青 BLUE
35 桃 PINK
36 緑 GREEN
37 茶 BROWN
38 橙 ORANGE
39 紫 VIOLET
51 灰 GRAY
53 蛍光黄 FLUORESCENT YELLOW
54 水 PALE BLUE
55 蛍光桃 FLUORESCENT PINK
56 黄緑 YELLOWISH GREEN
58 蛍光橙 FLUORESCENT ORANGE

31	28	34	55932-15**	15
29	26	32	55932-14**	14
27	24	30	55932-13**	13
25	22	28	55932-12**	12
23	20	26	55932-11**	11
21	18	24	55932-10**	10
19	16	22	55932-09**	9
17	14	20	55932-08**	8
15	12	18	55932-07**	7
13	10	16	55932-06**	6
11	8	14	55932-05**	5
9	6	12	55932-04**	4
7	4	10	55932-03**	3
5	2	8	55932-02**	2

REVISED EC NO. J2016-0482 DRWN: MIYABE 2015/10/15 CHKD: KAKAWA 2015/11/10 APPR: NUKITA 2015/12/24	GENERAL TOLERANCES (UNLESS SPECIFIED)		DIMENSION STYLE		SCALE	DESIGN UNITS	MODEL NO.: 55932-**** MM ONLY --- METRIC THIRD ANGLE PROJECTION
	0.25 UNDER	UNDER	±0.03	DRAWN BY	DATE	TITLE	
	0.25 OVER	0.5 UNDER	±0.05	YMAEDA	2005/06/13	2.0 W/B CONN.PLUG HOUSING ASS'Y WO BOSS -LEAD FREE-	
	0.5 OVER	1.0 UNDER	±0.1	MTANAKA	2005/06/13	molex	
1.0 OVER	10 UNDER	±0.2	APPROVED BY	DATE	DOCUMENT NO.	SD-55932-007	
10 OVER	30 UNDER	±0.25	NUKITA	2005/06/13	SHEET NO. 1 OF 2		
30 OVER		±0.3	MATERIAL NO.				
ANGULAR	±3 °		SEE CHART				
DRAFT WHERE APPLICABLE MUST REMAIN WITHIN DIMENSIONS			THIS DRAWING CONTAINS INFORMATION THAT IS PROPRIETARY TO MOLEX INCORPORATED AND SHOULD NOT BE USED WITHOUT WRITTEN PERMISSION				

9 8 7 6 5 4 3 2 1

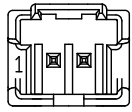
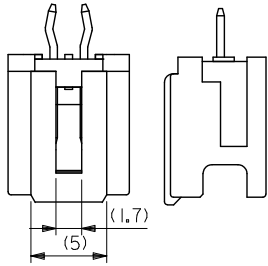

2 CIRCUIT

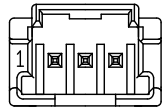
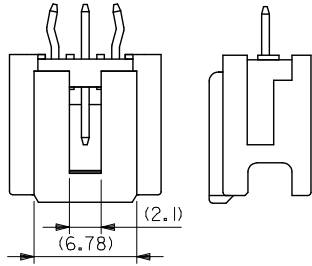

3 CIRCUIT

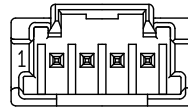
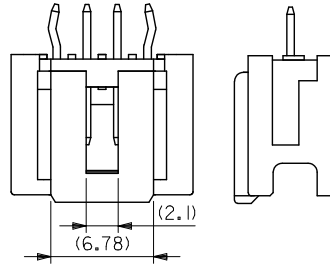

4 CIRCUIT

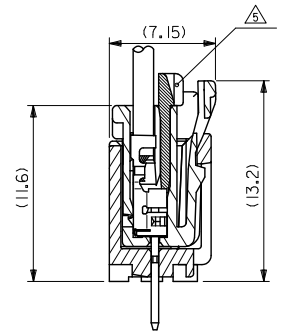

嵌合断面図

REVISED IEC NO. J2016-0482 DRAWN: MIYABE 2015/10/13 CHIKUDASAKAWA 2015/11/10 APPR: NUKITA 2015/12/24 REV A	GENERAL TOLERANCES (UNLESS SPECIFIED)		DIMENSION STYLE		SCALE	DESIGN UNITS	MODEL NO. : 55932-****		
	(UNLESS SPECIFIED)		MM ONLY		---	METRIC	THIRD ANGLE PROJECTION		
	0.25 UNDER	UNDER	±0.03	DRAWN BY	DATE	TITLE			
	0.25 OVER	0.5 UNDER	±0.05	YMAEDA	2005/06/13	2.0 W/B CONN.PLUG HOUSING ASS'Y WO BOSS -LEAD FREE-			
0.5 OVER	1.0 UNDER	±0.1	CHECKED BY	DATE	molex DOCUMENT NO. SD-55932-007 SHEET NO. 2 OF 2				
1.0 OVER	10 UNDER	±0.2	MTANAKA	2005/06/13					
10 OVER	30 UNDER	±0.25	APPROVED BY	DATE	SEE SHEET 1 THIS DRAWING CONTAINS INFORMATION THAT IS PROPRIETARY TO MOLEX INCORPORATED AND SHOULD NOT BE USED WITHOUT WRITTEN PERMISSION				
30 OVER		±0.3	NUKITA	2005/06/13					
ANGULAR ±3 °			MATERIAL NO.						
DRAFT WHERE APPLICABLE MUST REMAIN WITHIN DIMENSIONS			SIZE						