

Excellent Integrated System Limited

Stocking Distributor

Click to view price, real time Inventory, Delivery & Lifecycle Information:

[Molex Connector Corporation](#)
[0679260840](#)

For any questions, you can email us directly:

sales@integrated-circuit.com

10 9 8 7 6 5 4 3 2 1

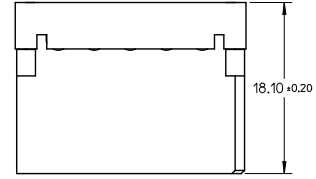
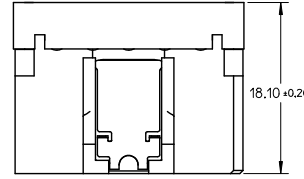
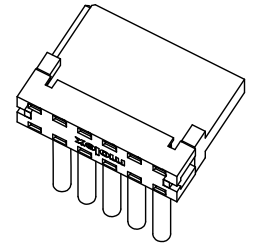
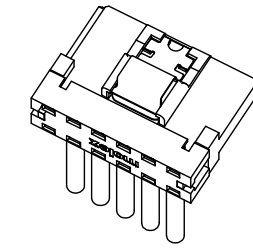
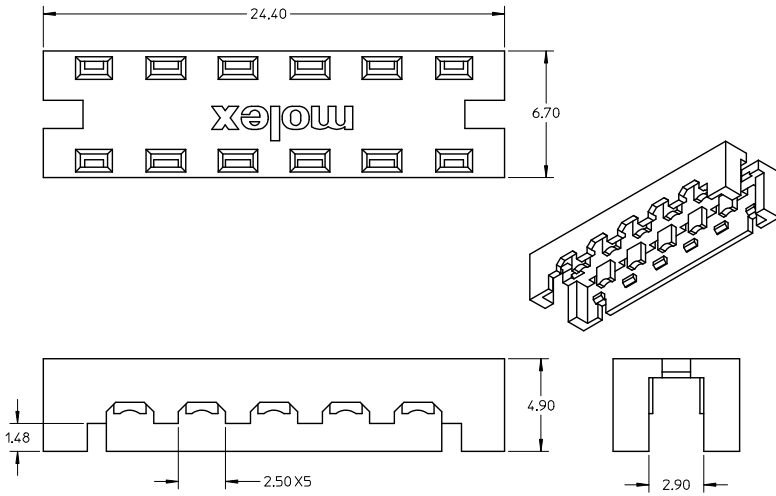

APPLICATION FOR WITH LATCH TYPE

APPLICATION FOR WITHOUT LATCH TYPE

NOTE

- 1 MATERIAL: THERMAL PLASTIC, COLOR: BLACK UL94V-0.
- 2 THIS COVER IS FEED TO TYPE. IT IS AVAILABLE FOR 67926-000*(WITH LATCH), 67926-001*(WITHOUT LATCH).
- 3 PACKAGE SPEC:
 - 3.1 1000 PCS IN ONE BAG.
 - 3.2 3000 PCS(3 PAGES) IN ONE INNER CARTON.
 - 3.3 12,000 PCS(4 INNER CARTONS) IN ONE OUTER CARTON.

P/N	REMARK
67926-0040	NON HALOGEN-FREE
67926-0840	HALOGEN-FREE

ADD PART NUMBER EC NO: SH2009-0536 DRAWN BY: TIDRANXI SONG CHECKED BY: CHIKKI SONG APPR: HWANG 2009/05/05 2009/06/19 2009/06/23	QUALITY SYMBOLS ▽=0 ▽=0	GENERAL TOLERANCES (UNLESS SPECIFIED)		DIMENSION STYLE MM ONLY		SCALE 5:1	DESIGN UNITS METRIC	THIRD ANGLE PROJECTION		
		4 PLACES ± --- ± ---	3 PLACES ± --- ± ---	2 PLACES ± 0.15 ± ---	1 PLACE ± 0.25 ± ---	ANGULAR ± 1°	DRAFT WHERE APPLICABLE MUST REMAIN WITHIN DIMENSIONS	DRAWN BY: GRATE MA CHECKED BY: YA JUN APPROVED BY: SAM DATE: 2004/04/25 DATE: 2004/04/25 DATE: 2004/04/25	TITLE FEED TO COVER FOR SATA POWER CONNECTOR IDT TYPE	MOLEX INCORPORATED
		SEE TABLE		MATERIAL NO.		DOCUMENT NO.		SHEET NO.		
		THIS DRAWING CONTAINS INFORMATION THAT IS PROPRIETARY TO MOLEX INCORPORATED AND SHOULD NOT BE USED WITHOUT WRITTEN PERMISSION		SD-67926-003		1 OF 1		1 OF 1		

9 8 7 6 5 4 3 2 1