

Excellent Integrated System Limited

Stocking Distributor

Click to view price, real time Inventory, Delivery & Lifecycle Information:

[Molex Connector Corporation](#)
[0945180100](#)

For any questions, you can email us directly:

sales@integrated-circuit.com

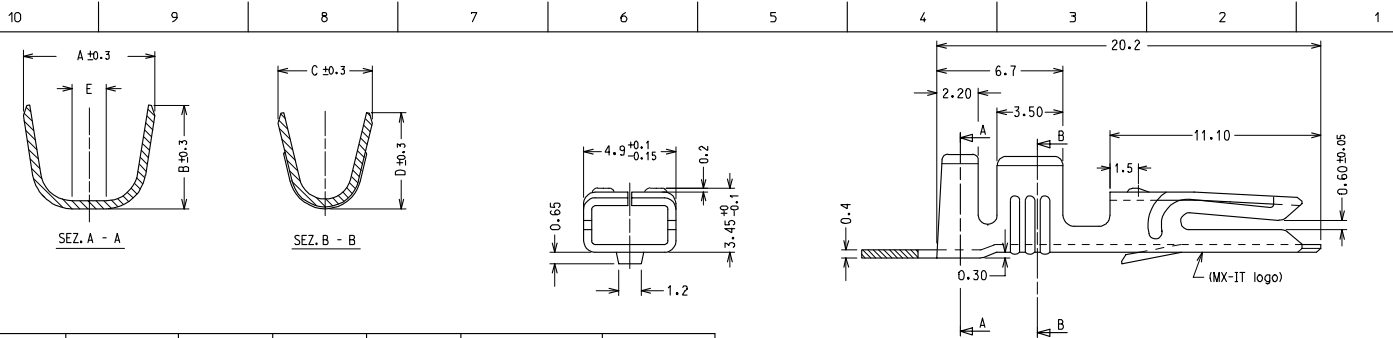

CODICE P/N	FINITURA PLATING	MATERIALE MATERIAL	SEZ. RAME WIRE RANGE	Ø ISOLANTE INS. RANGE	DIMENSIONI					PZ./BOBINA PCS/REEL
					A	B	C	D	E	
94518 - 0100	GREGGIO/ PLAIN	OTTONE BRASS	0.5 - 1.0	2.2 - 2.8	4.5	4.5	3.0	3.0	/	3000
94518 - 0101	STAGNATO/ TIN									
94518 - 0120	GREGGIO/ PLAIN	BRONZO FOSF. PHOSP.BRONZE	1.0 - 2.5	2.6 - 3.8	5.5	5.5	4.1	4.3	/	2500
94518 - 0121	STAGNATO/ TIN									
94518 - 0200	GREGGIO/ PLAIN	OTTONE BRASS	1.5 - 3.0	---	7.3	5.1	5.2	4.0	1.8	2500
94518 - 0201	STAGNATO/ TIN									
94518 - 0220	GREGGIO/ PLAIN	BRONZO FOSF. PHOSP.BRONZE	PER CAVI SINGOLI E DOPPI (VEDERE FOGLIO 2/2)	---	5.5	5.5	4.1	4.3	/	2500
94518 - 0221	STAGNATO/ TIN									
94518 - 0400	GREGGIO/ PLAIN	OTTONE BRASS	1.5 - 3.0	---	7.3	5.1	5.2	4.0	1.8	2500
94518 - 0401	STAGNATO/ TIN									
94518 - 0300	GREGGIO/ PLAIN	OTTONE BRASS	4.0	3.4 - 3.7	5.5	5.5	5.0	5.1	/	2500
94518 - 0301	STAGNATO/ TIN									

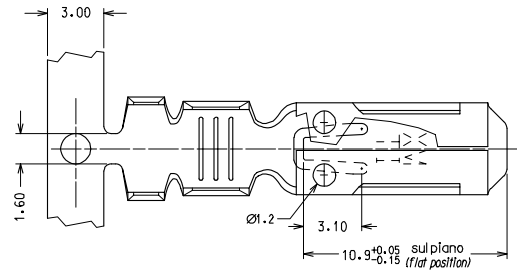

CONFEZIONE: N° 5 bobine con carta intermedia per box.
 PACKING: N° 5 reels with interleaf paper/box

Std. Descr.: HNF TERM (material-plating-wire range)

SENSO DI SVOLGIMENTO PER MINIAPPLICATORE
 DIRECTION OFF REEL

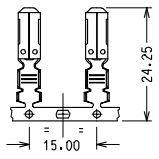
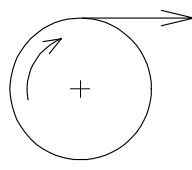

EC NO: Z72005-0129	2005/03/31	QUALITY SYMBOLS
DRAWN: FGOTTARD	2005/03/31	GENERAL TOLERANCES (UNLESS SPECIFIED)
CHKD: SANDANO	2005/03/31	mm
APPR: GZUIN	2005/04/01	INCH
DESCRIPTION		ANGULAR ± 2°
REV		DRAFT WHERE APPLICABLE MUST REMAIN WITHIN DIMENSIONS

DIMENSION STYLE MM ONLY DRAWN BY: FGOTTARD CHECKED BY: DATE: 1992/10/01 APPROVED BY: MPREVIAT DATE: 1992/10/01 MATERIAL NO.: SEE CHART DOCUMENT NO.: SD-94518-005	SCALE: 5:1 DESIGN UNITS: METRIC FIRST ANGLE PROJECTION	TITLE: HNF FEMALE TERMINAL FOR 6.3 X 0.8 TABS MOLEX INCORPORATED SHEET NO.: 1 OF 1
--	--	--