

Excellent Integrated System Limited

Stocking Distributor

Click to view price, real time Inventory, Delivery & Lifecycle Information:

[Molex Connector Corporation](#)
[0702470869](#)

For any questions, you can email us directly:

sales@integrated-circuit.com

10	9	8	7	6	5	4	3	2	1
----	---	---	---	---	---	---	---	---	---

ASSEMBLY PART NO.	CKT SIZE	A	B	C	D	L	LI
70247-0869	08	.300/7.62	.580/14.73	.700/17.78	.600/15.24	.120/3.05	0
70247-3469	34	1.600/40.64	1.880/47.76	2.000/50.80	1.900/48.26	.120/3.05	0
70247-5069	50	2.400/60.96	2.680/68.07	2.800/71.12	2.700/68.58	.120/3.05	0

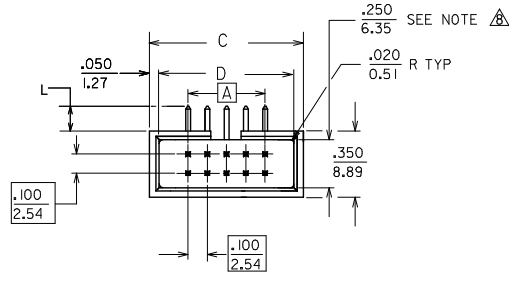

RECOMMENDED P.C. BOARD HOLE LAYOUT

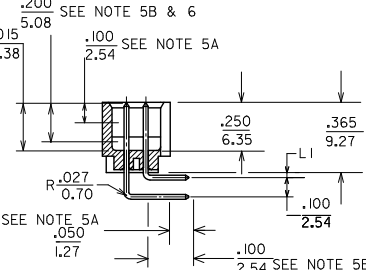
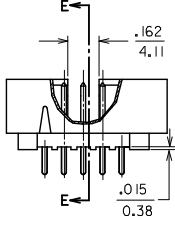
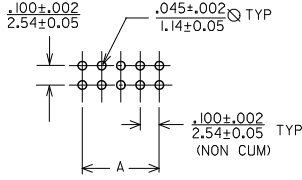

NOTES:

- PIN PUSHOUT FORCE (.9072KG)/2LBS MIN.
- PIN SOLDERABILITY PER MOLEX SPEC. ES-152
- PRODUCT SPEC: PS-70246 APPLIES.
- WAFER TO BE FLAT WITHIN (0.03MM/CM) 0.003IN/IN
- DIMENSIONS FOR PLATING LOCATION : A-MEASURE POINT FOR THICKNESS. B-MINIMUM COVERAGE
- GOLD END OF PIN UNLESS OVERALL PLATED.
- PLATING : - 15uIn MIN AU & 75uIn MIN TIN IN SELECTED AREAS. WITH 50uIn MIN NICKEL UNDERPLATE OVERALL.
- DIMENSION AT UPPER CENTER OF THE SHROUDED WALL CAN BE (5.81)/.228.
- MATERIAL:
PINS: .025 SQ. 260 BRASS OR EQUIVALENT.
WAFER: PBT, GLASS FILLED, UL94V-0, COLOUR: BLACK.
- SOLDERTAIL POSITION TOLERANCE TO BE GAUGED.

SECTION E-E

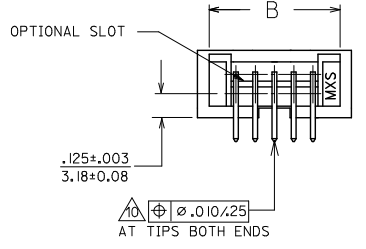

ADD NOTE 10. EC NO: S2009-0830 DRAWN BY: DRWNSKANG CHKD BY: CHYKATSEE APPR: HLONG 2009/09/28 2009/09/30 2009/10/02	QUALITY SYMBOLS ▽=0 ▽=0	GENERAL TOLERANCES (UNLESS SPECIFIED)		DIMENSION STYLE IN/MM		SCALE NTS	DESIGN UNITS METRIC	THIRD ANGLE PROJECTION
		4 PLACES ± --- ± --- 3 PLACES ± --- ± .008 2 PLACES ± 0.20 ± --- 1 PLACE ± --- ± --- ANGULAR ± 3 °	mm INCH ± --- ± --- ± .008 ± --- ± 0.20 ± --- ± --- ± ---	DRAWN BY JWAN DATE 1991/10/17	CHECKED BY TAY DATE 1991/10/22	APPROVED BY RWONG DATE 1991/10/22	TITLE C-GRID, SHROUDED HEADER R/A (SLOTTED W/O STANDOFFS)	MOLEX INCORPORATED
D1	REV	DRAFT WHERE APPLICABLE MUST REMAIN WITHIN DIMENSIONS		MATERIAL NO. SEE TABLE		DOCUMENT NO. SD-70247-**-59	THIS DRAWING CONTAINS INFORMATION THAT IS PROPRIETARY TO MOLEX INCORPORATED AND SHOULD NOT BE USED WITHOUT WRITTEN PERMISSION	

9	8	7	6	5	4	3	2	1
---	---	---	---	---	---	---	---	---