

## Excellent Integrated System Limited

Stocking Distributor

Click to view price, real time Inventory, Delivery & Lifecycle Information:

[Comchip Technology](#)  
[CDSV3-99-G](#)

For any questions, you can email us directly:

[sales@integrated-circuit.com](mailto:sales@integrated-circuit.com)

## Small Signal Switching Diodes



# CDSV3-16-G/56-G/70-G/99-G

**Reverse Voltage: 75 Volts**  
**Forward Current: 300 mA**  
**RoHS Device**

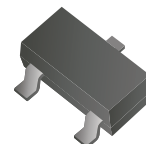

### Features

- Design for mounting on small surface.
- High speed switching.
- High mounting capability, strong surge withstand, high reliability.

### Mechanical data

- Case: SOT-323, molded plastic.
- Terminals: solderable per MIL-STD-750, method 2026.
- Approx. weight: 0.006 grams

### Circuit diagram

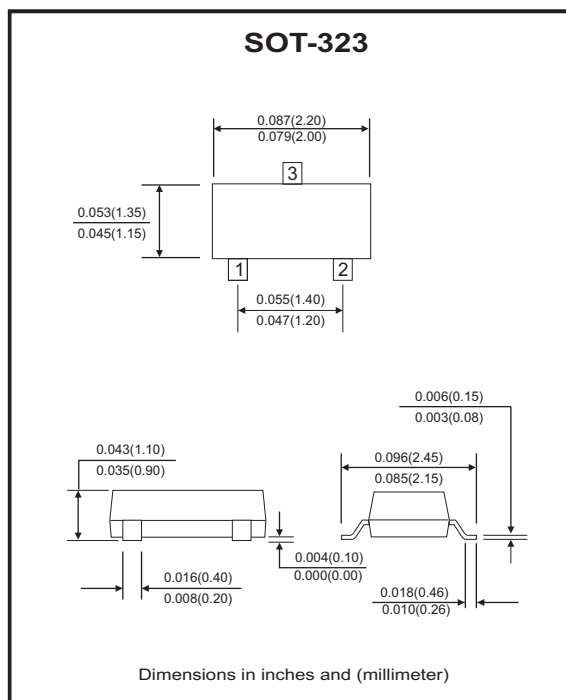
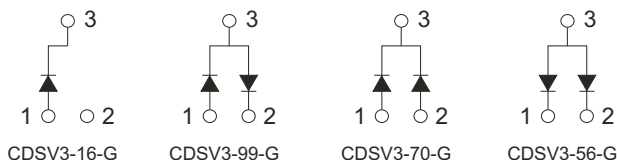

### Maximum Ratings and Electrical Characteristics

(at Ta=25°C unless otherwise noted)

Parameter	Symbol	Conditions	Value	Units
Repetitive peak reverse voltage	V <sub>RRM</sub>		75	V
Reverse voltage	V <sub>R</sub>		75	V
Forward current	I <sub>F</sub>		300	mA
Peak surge forward current	I <sub>FSM</sub>	T=1.0 μS	2	A
Power dissipation	P <sub>D</sub>		200	mW
Maximum forward voltage	V <sub>F</sub>	@I <sub>F</sub> =1mA @I <sub>F</sub> =10mA @I <sub>F</sub> =50mA @I <sub>F</sub> =150mA	0.715 0.855 1.0 1.25	V
Maximum reverse current	I <sub>R</sub>	@V <sub>R</sub> =20V @V <sub>R</sub> =75V @V <sub>R</sub> =25V, T <sub>J</sub> =150 °C @V <sub>R</sub> =75V, T <sub>J</sub> =150 °C	0.025 2.5 30 50	μA
Maximum reverse recovery time	T <sub>rr</sub>	I <sub>F</sub> =10mA, V <sub>R</sub> =6V	4	nS
Typical diode capacitance	C <sub>J</sub>	V <sub>R</sub> =0V, f=1.0MHz	2	pF
Maximum junction temperature	T <sub>J</sub>		-65~+150	°C
Storage temperature	T <sub>STG</sub>		-65 to +150	°C

# Small Signal Switching Diodes



## RATING AND CHARACTERISTIC CURVES (CDSV3-16-G/56-G/70-G/99-G)

Fig.1 - Forward Characteristics

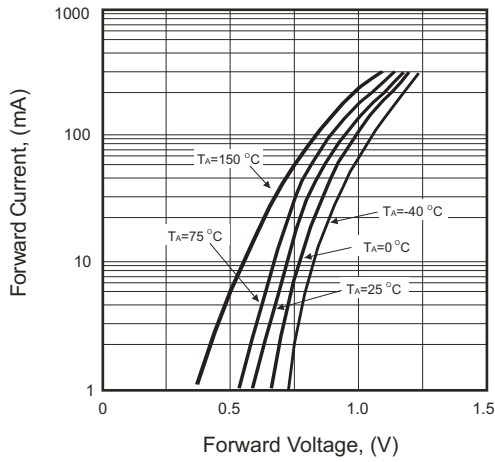

Fig.2 - Typical Reverse Characteristics

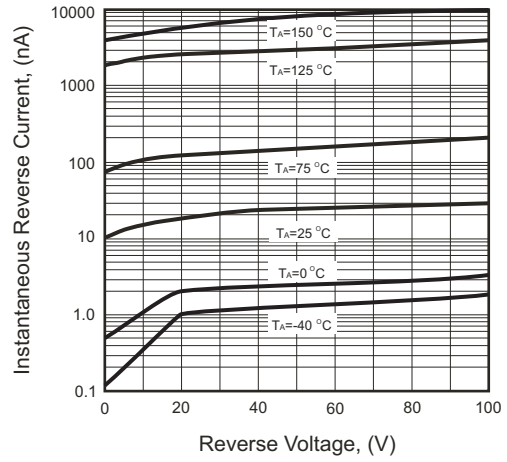

Fig.3 - Typical Capacitance vs. Reverse Voltage

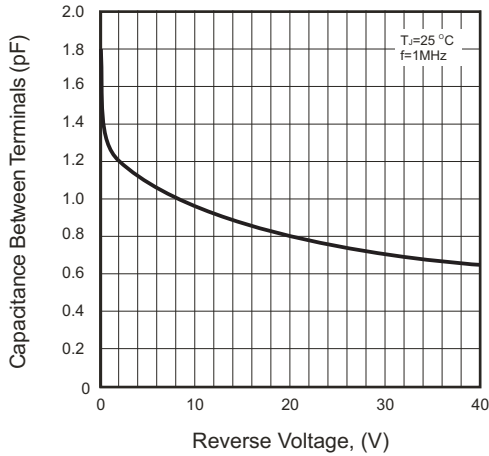

Fig.4 - Reverse Recovery Time vs. Forward Current

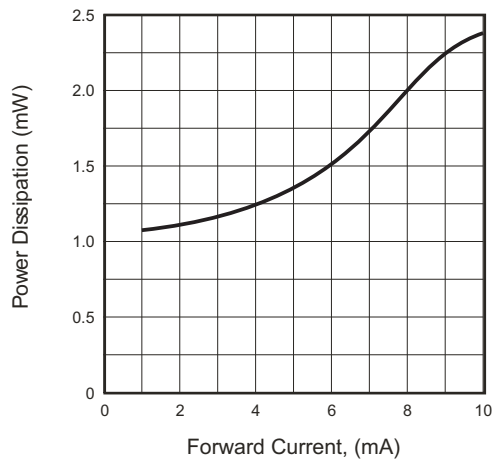
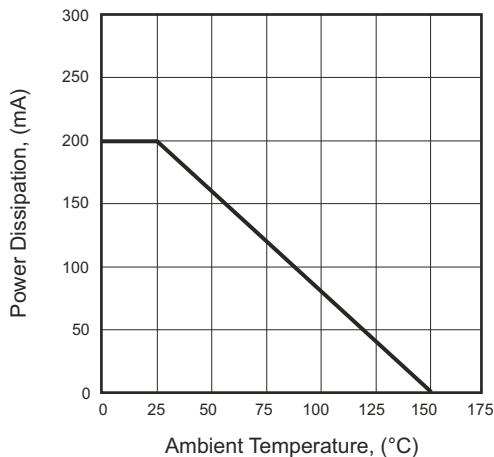

Fig.5 - Power Derating Curve, Total Package



# Small Signal Switching Diodes



## Reel Taping Specification

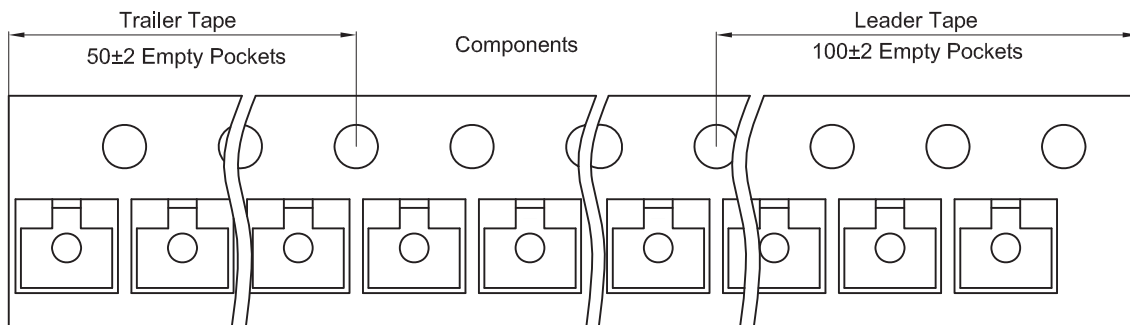
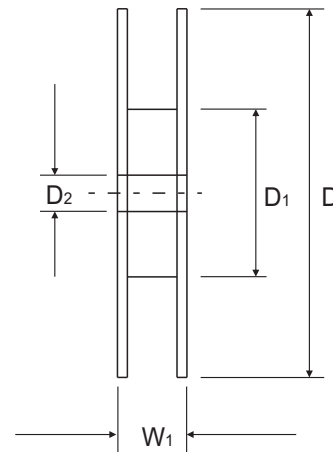
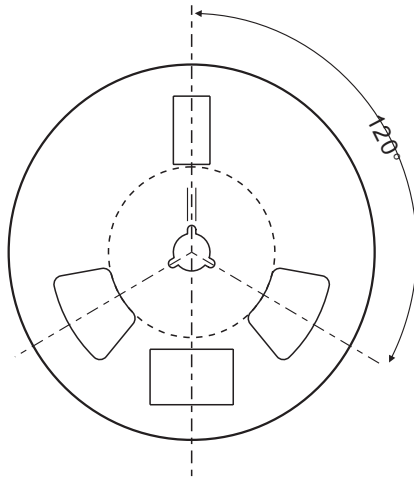
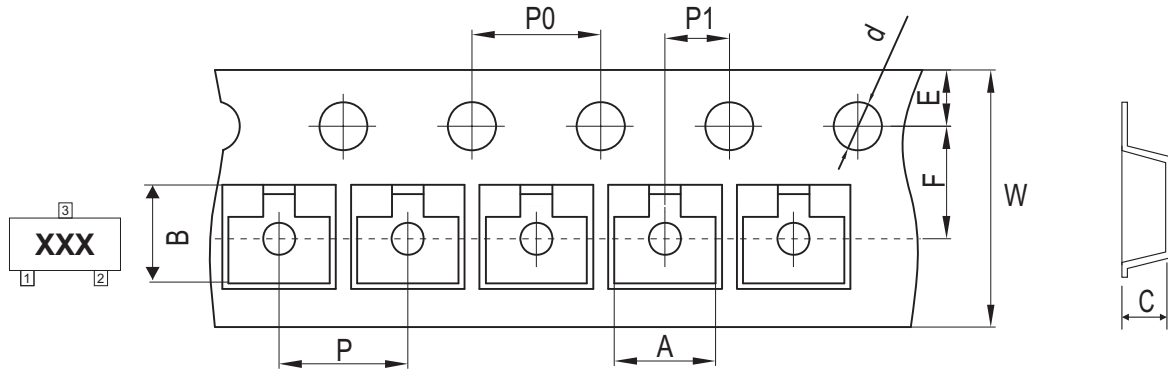

SOT-323	SYMBOL	A	B	C	d	D	D1	D2
	(mm)	2.25 ± 0.05	2.55 ± 0.05	1.19 ± 0.05	1.55 ± 0.10	178 ± 2.00	54.40 ± 1.00	13.00 ± 1.00
	(inch)	0.089 ± 0.002	0.100 ± 0.002	0.047 ± 0.002	0.061 ± 0.004	7.008 ± 0.079	2.142 ± 0.039	0.512 ± 0.039

SOT-323	SYMBOL	E	F	P	P0	P1	W	W1
	(mm)	1.75 ± 0.10	3.50 ± 0.10	4.00 ± 0.10	4.00 ± 0.10	2.00 ± 0.10	8.00 + 0.30 / - 0.10	12.30 ± 1.00
	(inch)	0.069 ± 0.004	0.138 ± 0.004	0.157 ± 0.004	0.157 ± 0.004	0.079 ± 0.004	0.315 + 0.012 / - 0.004	0.484 ± 0.039

## Small Signal Switching Diodes

### Marking Code

Part Number	Marking Code
CDBV3-16-G	A2
CDBV3-56-G	KJC
CDBV3-70-G	KJA
CDBV3-99-G	KJG

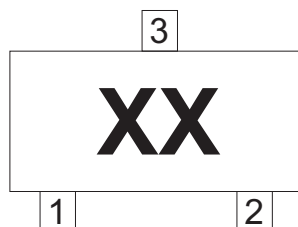

xx/xxx = Product type marking code

### Suggested PAD Layout

SIZE	SOT-323	
	(mm)	(inch)
A	0.80	0.031
B	0.50	0.020
C	1.30	0.051
D	2.20	0.087

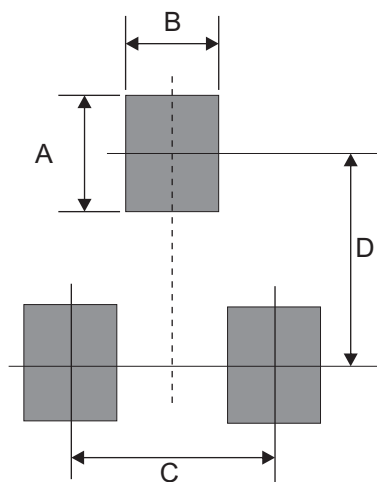

### Standard Packaging

Case Type	REEL PACK	
	REEL ( pcs )	Reel Size (inch)
SOT-323	3,000	7