

## Excellent Integrated System Limited

Stocking Distributor

Click to view price, real time Inventory, Delivery & Lifecycle Information:

[Molex Connector Corporation](#)  
[0387036502](#)

For any questions, you can email us directly:

[sales@integrated-circuit.com](mailto:sales@integrated-circuit.com)

MATERIAL NO.	NUMBER OF CIRCUITS 'XX'	DIM. 'A'	DIM. 'B'
38703-6502	02	14.6 [58]	8.26 [325]
38703-6503	03	22.9 [90]	16.51 [650]
38703-6504	04	31.1 [123]	24.77 [975]
38703-6505	05	39.4 [155]	33.02 [1300]
38703-6506	06	47.6 [188]	41.28 [1625]
38703-6507	07	55.9 [220]	49.53 [1950]
38703-6508	08	64.1 [253]	57.79 [2275]
38703-6509	09	72.4 [285]	66.04 [2600]
38703-6510	10	80.6 [318]	74.30 [2925]
38703-6511	11	88.9 [350]	82.55 [3250]
38703-6512	12	97.2 [383]	90.81 [3575]
38703-6513	13	105.41 [415]	99.06 [3900]
38703-6514	14	113.7 [448]	107.32 [4225]
38703-6515	15	121.9 [480]	115.57 [4550]
38703-6516	16	130.2 [513]	123.83 [4875]
38703-6517	17	138.4 [545]	132.08 [5200]
38703-6518	18	146.7 [578]	140.34 [5525]
38703-6519	19	154.9 [610]	148.59 [5850]
38703-6520	20	163.2 [643]	156.85 [6175]
38703-6521	21	171.5 [675]	165.10 [6500]
38703-6522	22	179.7 [708]	173.36 [6825]
38703-6523	23	188.0 [740]	181.61 [7150]
38703-6524	24	196.2 [773]	189.87 [7475]
38703-6525	25	204.5 [805]	198.12 [7800]
38703-6526	26	212.7 [838]	206.38 [8125]
38703-6527	27	221.0 [870]	214.63 [8450]
38703-6528	28	229.2 [903]	222.89 [8775]
38703-6529	29	237.5 [935]	231.14 [9100]
38703-6530	30	245.7 [968]	239.40 [9425]

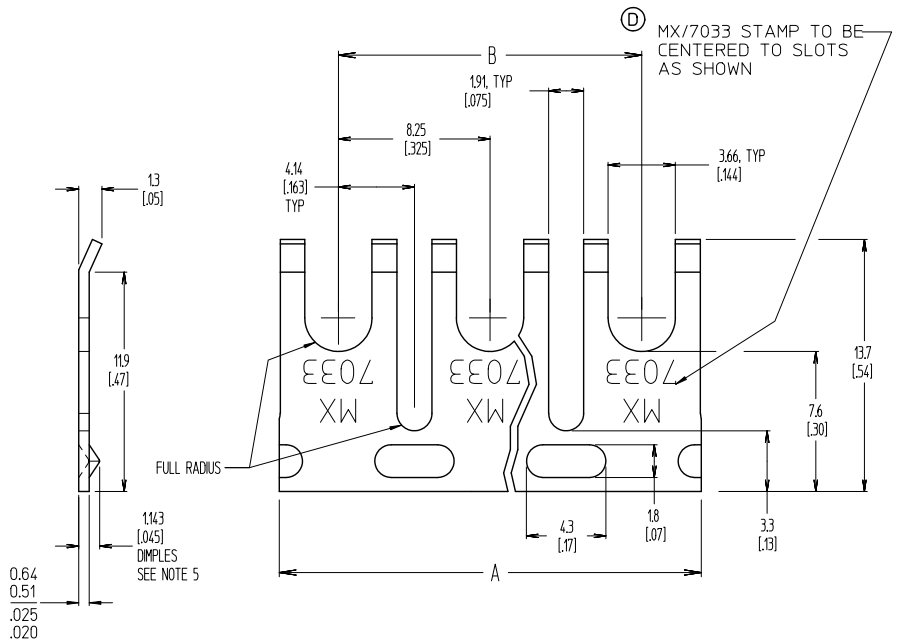

- NOTES:
1. MATERIAL: SEE TABLE
  2. FINISHES: SEE TABLE
  3. INCHES SHOWN IN BRACKETS [XXX].
  4. USED ON: SERIES 7000
  5. THE DIMPLE HEIGHT MAY VARY TO MAINTAIN PART STRAIGHTNESS TO WITHIN 0.8 [03]/25.4 [1.00], AND HOLD THE LONG SLOT WIDTH TO 1.91 [0.75].
  6. PART IS ROHS COMPLIANT.

ITEM	QTY.	DESCRIPTION	MATERIAL	FINISH
1	1	TERMINAL JUMPER	BRASS	NICKEL

<b>MX STAMP WAS BEAU</b> EC NO: WNA2012-0084 DRAWN BY: DRWINSTONE 2011/08/04 CHECKED BY: CHKDOB RUPERT 2011/08/04 APPR: JMDRPHY 2011/08/13 DESCRIPTION: JUMPER REV:	<b>QUALITY SYMBOLS</b> ▽=0 ▽=0	<b>GENERAL TOLERANCES (UNLESS SPECIFIED)</b> <table border="1"> <tr><th></th><th>mm</th><th>INCH</th></tr> <tr><td>4 PLACES</td><td>± .005</td><td>± .0005</td></tr> <tr><td>3 PLACES</td><td>± .005</td><td>± .0005</td></tr> <tr><td>2 PLACES</td><td>± 0.13</td><td>± .01</td></tr> <tr><td>1 PLACE</td><td>± 0.3</td><td>± .01</td></tr> </table>		mm	INCH	4 PLACES	± .005	± .0005	3 PLACES	± .005	± .0005	2 PLACES	± 0.13	± .01	1 PLACE	± 0.3	± .01	<b>DIMENSION STYLE</b> MM/IN	<b>SCALE</b> 5:1	<b>DESIGN UNITS</b> INCH	THIRD ANGLE PROJECTION
		mm	INCH																		
	4 PLACES	± .005	± .0005																		
	3 PLACES	± .005	± .0005																		
2 PLACES	± 0.13	± .01																			
1 PLACE	± 0.3	± .01																			
DRAFT WHERE APPLICABLE MUST REMAIN WITHIN DIMENSIONS		<table border="1"> <tr><th>DRAWN BY</th><th>DATE</th></tr> <tr><td>W. HOWARD</td><td>2003/12/12</td></tr> <tr><th>CHECKED BY</th><th>DATE</th></tr> <tr><td>R. KEMP</td><td>2003/12/12</td></tr> <tr><th>APPROVED BY</th><th>DATE</th></tr> <tr><td>P. WALTZ</td><td>2003/12/12</td></tr> </table>	DRAWN BY	DATE	W. HOWARD	2003/12/12	CHECKED BY	DATE	R. KEMP	2003/12/12	APPROVED BY	DATE	P. WALTZ	2003/12/12	<b>TITLE</b> JUMPER, TERMINAL (EDGE-ON TYPE)						
DRAWN BY	DATE																				
W. HOWARD	2003/12/12																				
CHECKED BY	DATE																				
R. KEMP	2003/12/12																				
APPROVED BY	DATE																				
P. WALTZ	2003/12/12																				
SEE CHART		<b>MOLEX INCORPORATED</b> DOCUMENT NO. SD-38703-001																			
SIZE B THIS DRAWING CONTAINS INFORMATION THAT IS PROPRIETARY TO MOLEX INCORPORATED AND SHOULD NOT BE USED WITHOUT WRITTEN PERMISSION		SHEET NO. 1 OF 1																			