

## Excellent Integrated System Limited

Stocking Distributor

Click to view price, real time Inventory, Delivery & Lifecycle Information:

[Molex Connector Corporation](#)  
[0455870003](#)

For any questions, you can email us directly:

[sales@integrated-circuit.com](mailto:sales@integrated-circuit.com)

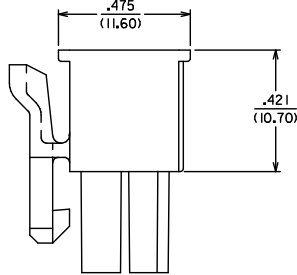
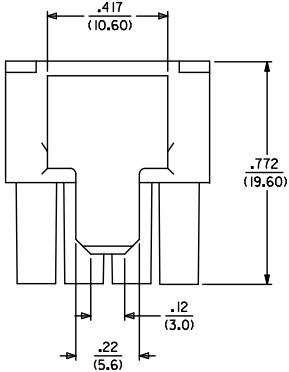
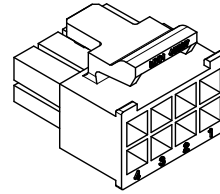
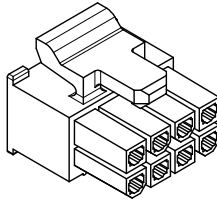
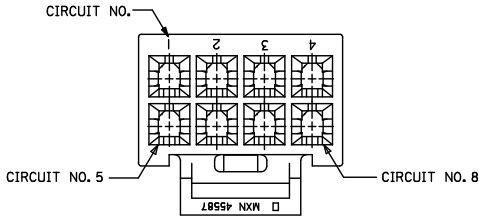

455870003  
FIRST GENERATION POLARIZATION

NOTES:

- 1) MATERIAL: HOUSING: NYLON, UL94V-0, COLOR: BLACK
- 2) FINISH: NONE
- 3) PRODUCT SPECIFICATION: PS-5556-001
- 4) PACKAGING: PER PK-5557-002
- 5) 455870003 RECEPTACLE HOUSING MATES WITH 455860001 AND 455860004 HEADER ASSEMBLIES; 455870002 RECEPTACLE HOUSING MATES WITH 455860002 HEADER ASSEMBLY.
- 6) PART TO BE USED WITH MOLEX FEMALE TERMINAL #5556.
- 7) ALL DIMENSIONS ARE REFERENCE UNLESS OTHERWISE SPECIFIED WITH A TOLERANCE.
- 8) PART IS NOT DESIGNED FOR CURRENT SHARING.
- 9) PARTS ARE NOT TO BE MATED OR UNMATED WHILE CIRCUITS ARE LIVE.
- 10) RIB INDICATES CIRCUIT NUMBER 1.
- 11) PART CONFORMS TO CLASS "B" REQUIREMENTS OF COSMETIC SPECIFICATION PS-45499-002.
- 12) WIRES ARE TO BE DRESSED IN SUCH A MANNER TO ALLOW THE TERMINALS TO FLOAT FREELY IN THE POCKET

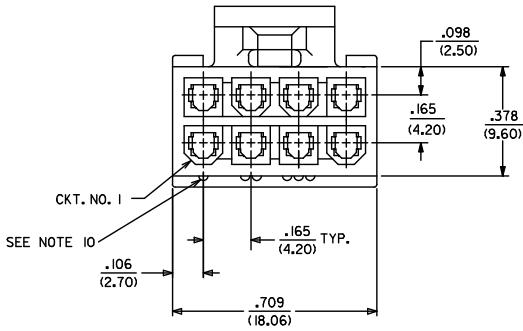

CIRCUIT SIZE	PART NO.	POLARIZATION TYPE
8	455870003	FIRST GENERATION
	455870002	SECOND GENERATION

REMOVE -0004 EC NO: UCP2014-1505 DRAWING QTY: 2013/10/03 CHKD: BELL 2013/10/03 APPR: SMITH 2013/11/04	QUALITY SYMBOLS	GENERAL TOLERANCES (UNLESS SPECIFIED)	DIMENSION STYLE IN/MM	SCALE 4:1	DESIGN UNITS METRIC	TITLE	8 CKT. RECEPT. HOUSING SPECIAL POLARIZATION MINI-FIT JR. SERIES <b>molex</b> SD-45587-001	SHEET NO. 1 OF 2
	∇=0 ∇=0 ∇=0	4 PLACES ± --- ± --- 3 PLACES ± --- ± .010 2 PLACES ± .25 ± .015 1 PLACE ± .38 ± --- 0 PLACE ± ±	DRAWN BY CLS DATE 2003/07/15 CHECKED BY GEP DATE 2003/07/15 APPROVED BY F-SMITH DATE 2011/03/01	DRAWN BY CLS DATE 2003/07/15 CHECKED BY GEP DATE 2003/07/15 APPROVED BY F-SMITH DATE 2011/03/01	THIRD ANGLE PROJECTION	MATERIAL NO. DOCUMENT NO.		
	ANGULAR ± 5 ° DRAFT WHERE APPLICABLE MUST REMAIN WITHIN DIMENSIONS	SEE CHART	THIS DRAWING CONTAINS INFORMATION THAT IS PROPRIETARY TO MOLEX INCORPORATED AND SHOULD NOT BE USED WITHOUT WRITTEN PERMISSION	MATERIAL NO. DOCUMENT NO.	SD-45587-001			
	REV C2	SIZE C	THIS DRAWING CONTAINS INFORMATION THAT IS PROPRIETARY TO MOLEX INCORPORATED AND SHOULD NOT BE USED WITHOUT WRITTEN PERMISSION	MATERIAL NO. DOCUMENT NO.	SD-45587-001			

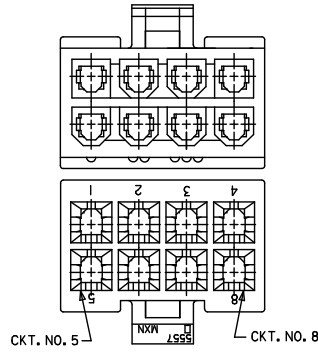

455870002  
SECOND GENERATION POLARIZATION

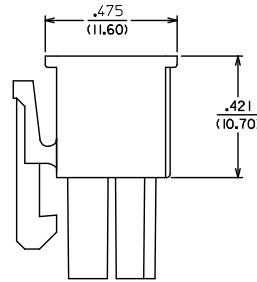
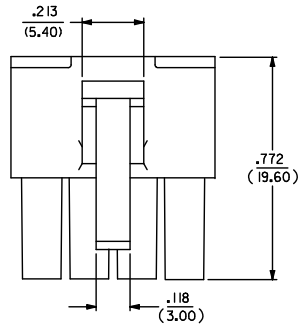

SEE SHEET 1 EC NO: UCP204-1505 DRAWING NO: 2013/10/03 CHKD: BELL APPR: SMITH 2013/11/04	QUALITY SYMBOLS ▽=0 ▽=0 ▽=0	GENERAL TOLERANCES (UNLESS SPECIFIED)		DIMENSION STYLE IN/MM		SCALE 4:1	DESIGN UNITS METRIC	THIRD ANGLE PROJECTION
		mm	INCH	DRAWN BY CLS	DATE 2013/07/15	TITLE 8 CKT. RECEPT. HOUSING SPECIAL POLARIZATION MINI-FIT JR. SERIES		
C2	DESCRIPTION REV	4 PLACES ± .005	± .005	CHECKED BY GEP	DATE 2013/07/15			
		3 PLACES ± .010	± .010	APPROVED BY FSMITH	DATE 2011/03/01			
		2 PLACES ± .015	± .015	MATERIAL NO.		DOCUMENT NO.	SHEET NO.	
		1 PLACE ± .038	± .038	SEE CHART		SD-45587-001	2 OF 2	
		0 PLACE ± .000	± .000	THIS DRAWING CONTAINS INFORMATION THAT IS PROPRIETARY TO MOLEX INCORPORATED AND SHOULD NOT BE USED WITHOUT WRITTEN PERMISSION				