

Excellent Integrated System Limited

Stocking Distributor

Click to view price, real time Inventory, Delivery & Lifecycle Information:

[Molex Connector Corporation](#)
[0461146200](#)

For any questions, you can email us directly:

sales@integrated-circuit.com

NO OF SIGNALS	MATERIAL NUMBER	COMPLIANT P/N PLATING	DM A	DM B	DM C
12	46114-6120	TN	53.01/2.087	53.51/2.107	
16	46114-6160	TN	55.55/2.187	56.05/2.207	
20	46114-6200	TN	58.09/2.287	58.59/2.307	
24	46114-6240	TN	60.63/2.287	61.13/2.407	5.45/215
28	46114-6280	TN	63.17/2.387	63.67/2.507	
32	46114-6320	TN	65.71/2.487	66.21/2.607	
36	46114-6360	TN	68.25/2.587	68.75/2.707	
40	46114-6400	TN	70.79/2.787	71.29/2.807	

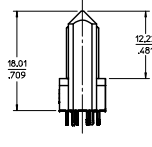
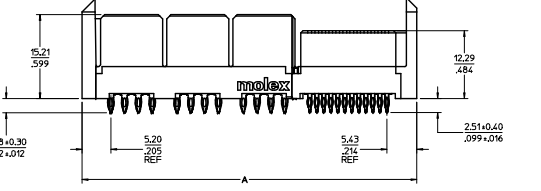
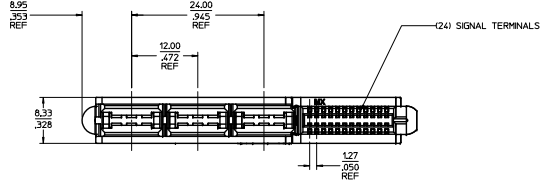

- NOTES:
 1. MATERIAL: HOUSING: LCP, 94-V0, COLOR: BLACK, POWER CONTACTS: COPPER ALLOY, SIGNAL CONTACTS: COPPER ALLOY.
 2. FINISH: SELECT GOLD - 0.75 μM/30 μ INCHES, SELECTED TIN - 250 μM/1000 μ INCHES, BOTH OVER NICKEL - 125 μM/50 μ INCHES.
 3. POWER TERMINALS ARE LUBRICATED IN CONTACT AREA.
 4. PARTS ARE ROHS COMPLIANT.
 5. MATES TO MOLEX P/N 45985-SERIES OR EDGE CARD 157/062.
 6. PRODUCT SPECIFICATION PS-46114-001.
 7. PACKAGING PER PK-46114-003.

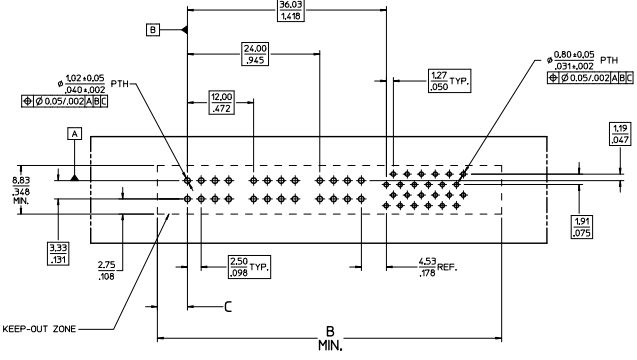
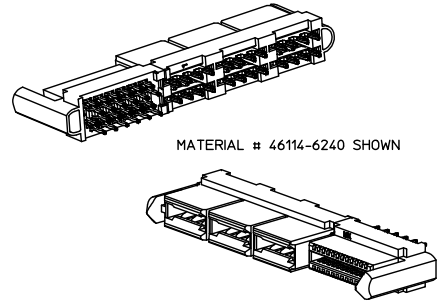

PCB COMPONENT SIDE
par 2-of-top2
SCALE 3:1

QUALITY SYMBOLS	GENERAL TOLERANCES (UNLESS SPECIFIED)	DIMENSION STYLE		SCALE	DESIGN UNITS	THIRD ANGLE PROJECTION
		MM/IN	MM/IN			
▽=0	4 PLACES ±	mm	INCH	3:1	METRIC	THIRD ANGLE PROJECTION
▽=0	3 PLACES ±	±0.10				
▽=0	2 PLACES ±	±0.25				
▽=0	1 PLACE ±	±				
▽=0	0 PLACE ±	±				

ADD DIMENSION EC NO. 10/2005-0571	DRW:RABANDURA	20/08/19	QUALITY SYMBOLS	GENERAL TOLERANCES (UNLESS SPECIFIED)	DIMENSION STYLE	SCALE	DESIGN UNITS	THIRD ANGLE PROJECTION
CHKD: APARTEL	APPROVED BY	2005/06/20	▽=0	4 PLACES ±	MM/IN	3:1	METRIC	THIRD ANGLE PROJECTION
DATE	DATE		▽=0	3 PLACES ±				
			▽=0	2 PLACES ±				
			▽=0	1 PLACE ±				
			▽=0	0 PLACE ±				
				ANGULAR ±1/2°				
				DRAFT WHERE APPLICABLE MUST REMAIN WITHIN DIMENSIONS				
				SEE CHART				
				THIS DRAWING CONTAINS INFORMATION THAT IS PROPRIETARY TO MOLEX INCORPORATED AND SHOULD NOT BE USED WITHOUT WRITTEN PERMISSION				

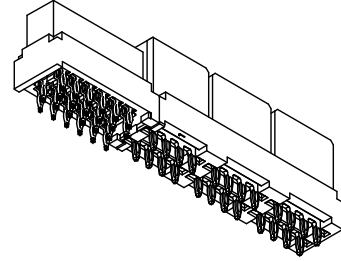
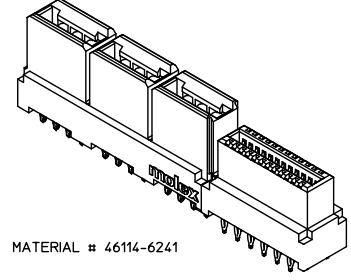
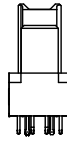
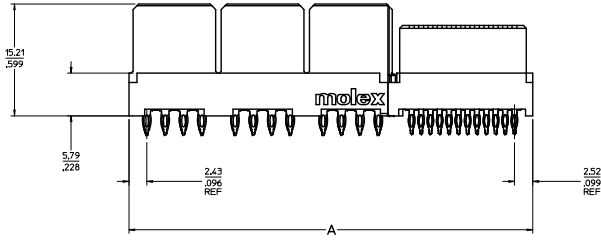
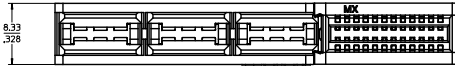

NO OF SIGNALS	MATERIAL NUMBER	COMPLIANT PIN PLATING	DM A	DM B	DM C
12	46114-6121	TIN	47.34/1.864	47.84/1.883	
16	46114-6161	TIN	49.88/1.964	50.38/1.983	
20	46114-6201	TIN	52.42/2.064	52.92/2.083	
24	46114-6241	TIN	54.96/2.164	55.46/2.183	2.69/106
28	46114-6281	TIN	57.50/2.264	58.00/2.283	
32	46114-6321	TIN	60.04/2.364	60.54/2.383	
36	46114-6361	TIN	62.58/2.464	63.08/2.483	
40	46114-6401	TIN	65.12/2.564	65.62/2.583	

SEE SHEET 1 ECN NO. IFE7005-0571 DRAWN BY: DORAN/ANDARA 20/11/09 CHECKED: JCMERCI APPROVED BY: JCMERCI DATE: 20/11/09	QUALITY SYMBOLS	GENERAL TOLERANCES (UNLESS SPECIFIED)	DIMENSION STYLE	SCALE	DESIGN UNITS	THIRD ANGLE PROJECTION
		mm INCH	MM/IN	4:1	METRIC	
	▽=0	4 PLACES ± --- ± ---	DRAWN BY: MKARADIMAS DATE: 20/05/11/08	TITLE	LPH VERTICAL RECEPTACLE ASSEMBLY 6 CIRCUIT PWR CONNECTOR, PRESS FIT	
	▽=0	3 PLACES ± --- ± .010	CHECKED BY: APATEL DATE: 10/13/06			
▽=0	2 PLACES ± 0.25 ± ---	APPROVED BY: JCMERCI DATE: 20/09/12/03	DOCUMENT NO.	SD-46114-600		
▽=0	1 PLACE ± --- ± ---	ANGULAR ±1/2°	MATERIAL NO.	SEE CHART	SHEET NO.	2 OF 3
▽=0	0 PLACE ± --- ± ---	DRAFT WHERE APPLICABLE MUST REMAIN WITHIN DIMENSIONS	SIZE	THIS DRAWING CONTAINS INFORMATION THAT IS PROPRIETARY TO MOLEX INCORPORATED AND SHOULD NOT BE USED WITHOUT WRITTEN PERMISSION		

NO OF SIGNAL	DIM. D
12	8.00/.315
16	10.54/.415
20	13.08/.515
24	15.62/.615
28	18.16/.715
32	20.70/.815
36	23.24/.915
40	25.78/1.015

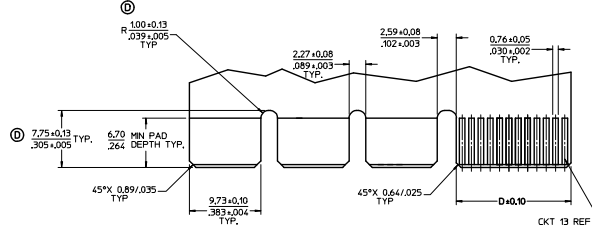
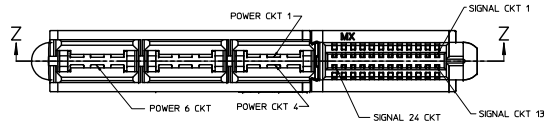
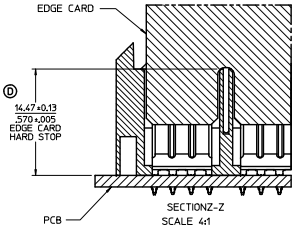

RECOMMENDED EDGE CARD LAYOUT
EDGE CARD THICKNESS: 157/.062 ± 0.15/.006
PLATING: GOLD 30 μ INCHES MIN.
OVER 150 μ INCHES NICKEL.

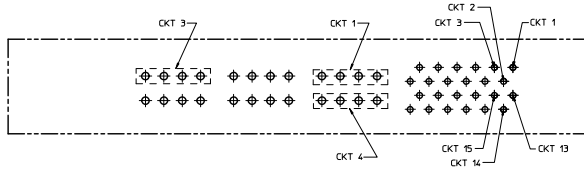

PCB LAYOUT: COMPONENT SIDE
SEE SH1 FOR DIMENSIONS

SEE SHEET 1 SEC. NO. 0461146200-0571 DRAWN BY DR. BHANDARA 20/08/19 CHKD. APAPATEL 20/08/19 APPR. JCOMERC	QUALITY SYMBOLS	GENERAL TOLERANCES (UNLESS SPECIFIED)	DIMENSION STYLE	SCALE	DESIGN UNITS	THIRD ANGLE PROJECTION	
	∇=0 4 PLACES ± --- ± --- ∇=0 3 PLACES ± --- ± .010 ∇=0 2 PLACES ± 0.25 ± --- ∇=0 1 PLACE ± --- ± --- ∇=0 0 PLACE ± --- ± ---	mm INCH ± --- ± --- ± .010 ± --- ± --- ± --- ± --- ± --- ± ---	DRAWN BY DATE MKARADIMAS 2005/11/28 CHECKED BY DATE APATEL 10/13/06 APPROVED BY DATE JCOMERC 2009/12/03	MM/IN 4:1	METRIC	◎	TITLE LPH VERTICAL RECEPTACLE ASSEMBLY 6 CIRCUIT PWR CONNECTOR PRESS FIT
	ANGULAR 1/2° DRAFT WHERE APPLICABLE MUST REMAIN WITHIN DIMENSIONS	SEE CHART THIS DRAWING CONTAINS INFORMATION THAT IS PROPRIETARY TO MOLEX INCORPORATED AND SHOULD NOT BE USED WITHOUT WRITTEN PERMISSION	MATERIAL NO. DOCUMENT NO. SD-46114-600	SHEET NO. 3 OF 3			
	mouser INCORPORATED AND SHOULD NOT BE USED WITHOUT WRITTEN PERMISSION						