

Excellent Integrated System Limited

Stocking Distributor

Click to view price, real time Inventory, Delivery & Lifecycle Information:

[Molex Connector Corporation](#)
[0520186216](#)

For any questions, you can email us directly:

sales@integrated-circuit.com

DWG. NO. SD-52018-003

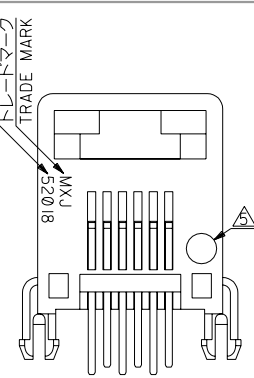
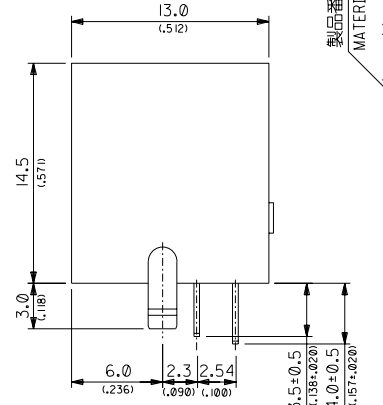
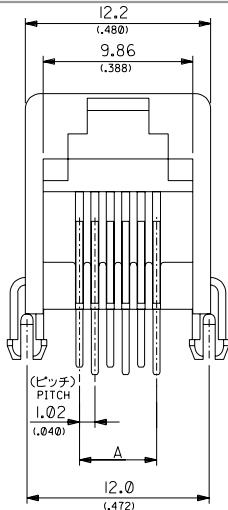

- 注) NOTES
1. 材質 MATERIAL
ハウジング: ガラス入りポリエステル UL94V-0
HSG.: POLYESTER G.F.15% UL94V-0
ターミナル: リン青銅
TERM.: PHOSPHOR BRONZE
 2. メッキ仕様 PLATING
接点部: 金メッキ 表参照
CONTACT AREA: GOLD PER TABLE
半田付け部: 錫メッキ 1.0µmMIN.
SOLDER AREA: TIN 1.0 MICROMETER MINIMUM.
下地メッキ: ニッケルメッキ 1.0µmMIN.
UNDERPLATE: NICKEL 1.0 MICROMETER MINIMUM.
- 6.4*6は両側の基板穴を除く。
DIM B INDICATES FIRST P.C.HOLE REQUIRED PER PART NUMBER.
FOR PARTIALLY LOADED ASSEMBLIES P.C.HOLE PATTERN IS REDUCED FROM EACH END.
 4. 推奨基板厚: t=1.6±0.05
RECOMMENDED P.C.B. THICKNESS: 1.6±0.05
 - △ 金メッキ厚表示
COLOR CODING TO INDICATE GOLD PLATING
黄色: 0.1µmMIN. YELLOW: 0.1 MICROMETER MINIMUM.
緑色: 0.38µmMIN. GREEN: 0.38 MICROMETER MINIMUM.
オレンジ色: 0.76µmMIN. ORANGE: 0.76 MICROMETER MINIMUM.
無色: 1.27µmMIN. UNMARKED: 1.27 MICROMETER MINIMUM.
 6. ハウジングの色は、グレー。
HOUSING COLOR IS GRAY.
 7. 本製品は52018-6*5の給フリースである。
THIS PRODUCT IS LEAD FREE OF 52018-6**5.

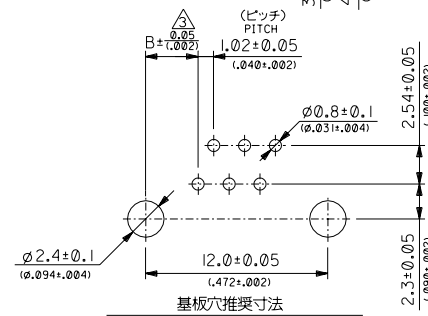

RECOMMENDED P.C.B. LAYOUT (ジャック取付け側) (JACK ASS'Y SIDE)

6	6	5.08 (2.00)	3.46 (1.36)	1.27 / (50)	52018-6646
				0.76 / (30)	-6636
6	4	3.05 (1.20)	4.48 (1.76)	0.38 / (15)	-6626
				0.1 / (4)	-6616
				1.27 / (50)	-6446
6	2	1.02 (0.40)	5.49 (2.16)	0.76 / (30)	-6236
				0.38 / (15)	-6226
				0.1 / (4)	52018-6216

POSITION	極数	A	B	金メッキ厚 um/(µMIN)	製品番号
	CIRCUITS			GOLD PLATING THK(MIN.) um/(µMIN)	MATERIAL No.
MODEL NO.		52018-6**6		DIMENSIONS:	
SCALE		4:1		SHT REV	
DESIGN UNITS		mm INCH		BY DATE	
DRAWN BY & DATE		M.NAGATA '04/05/14		TITLE: MODULAR JACK HOUSING ASS'Y -LEAD FREE-	
CHECKED BY & DATE		K.TOJO '04/05/14		MOLEX INCORPORATED	
APPROVED BY & DATE		M.SASAO '04/05/14		MATERIAL NO. DRAWING NO.	
CAD FILENAME		SD-52018-003.S01		SD-52018-003	
ANGLE 角度		±3°		SHEET NO. 1 OF 1	
GENERAL TOLERANCES: (UNLESS SPECIFIED)		SCALE 4:1		SIZE B	
10 UNDER 未満		+0.2 (0.08)		EN-02J(097) MXJ-54	
10 OVER 30 UNDER 未満		+0.25 (0.10)			
30 OVER 未満		+0.3 (0.12)			

DO NOT SCALE DRAWING

DESIGN NO.	0
DRWN: CH'K: APPR:	
DESIGN NO.	
DRWN: CH'K: APPR:	
DESIGN NO.	
DRWN: CH'K: APPR:	
DESIGN NO.	
DRWN: CH'K: APPR:	
DESIGN NO.	
DRWN: CH'K: APPR:	
REV	0
INS. RANGE	
検査外径	

MATERIAL 材料	注参照 SEE NOTES
FINISH 仕上げ	注及び表参照 SEE NOTES AND CHART
WIRE RANGE 適用電線範囲	
INS. RANGE 検査外径	

GENERAL TOLERANCES: (UNLESS SPECIFIED)	SCALE 4:1	DESIGN UNITS mm INCH	MODEL NO. 52018-6**6	DIMENSIONS: mm INCH mm INCH mm ONLY	SHT REV BY DATE
10 UNDER 未満	+0.2 (0.08)	DRAWN BY & DATE M.NAGATA '04/05/14	TITLE: MODULAR JACK HOUSING ASS'Y -LEAD FREE-		
10 OVER 30 UNDER 未満	+0.25 (0.10)	CHECKED BY & DATE K.TOJO '04/05/14	MOLEX INCORPORATED		
30 OVER 未満	+0.3 (0.12)	APPROVED BY & DATE M.SASAO '04/05/14	MATERIAL NO. SD-52018-003	DRAWING NO. SD-52018-003	SHEET NO. 1 OF 1
ANGLE 角度	±3°	CAD FILENAME SD-52018-003.S01	SIZE B		
THIS DRAWING CONTAINS INFORMATION THAT IS PROPRIETARY TO MOLEX INCORPORATED AND SHOULD NOT BE USED WITHOUT WRITTEN PERMISSION.					