

## Excellent Integrated System Limited

Stocking Distributor

Click to view price, real time Inventory, Delivery & Lifecycle Information:

[Molex Connector Corporation](#)  
[0719892003](#)

For any questions, you can email us directly:

[sales@integrated-circuit.com](mailto:sales@integrated-circuit.com)

13 12 11 10 9 8 7 6 5 4 3 2 1

ITEM NUMBER	ENGINEERING NUMBER	DESCRIPTION
051-25-1007	71989-2002	CARRIER ATTACHED
051-25-2003	71989-2003	TRIMMED TO LENGTH

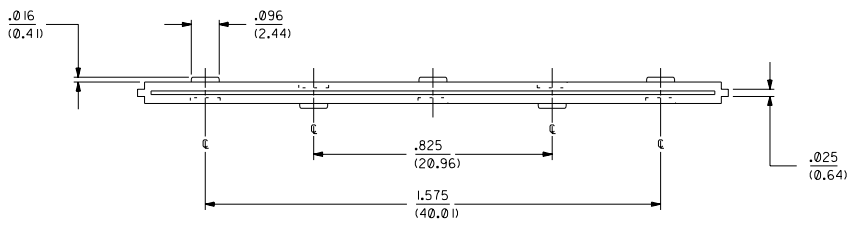
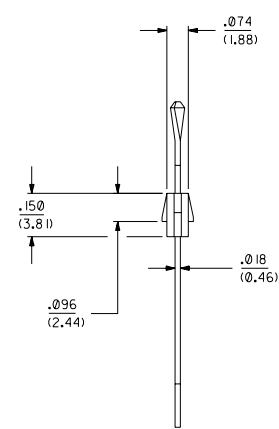
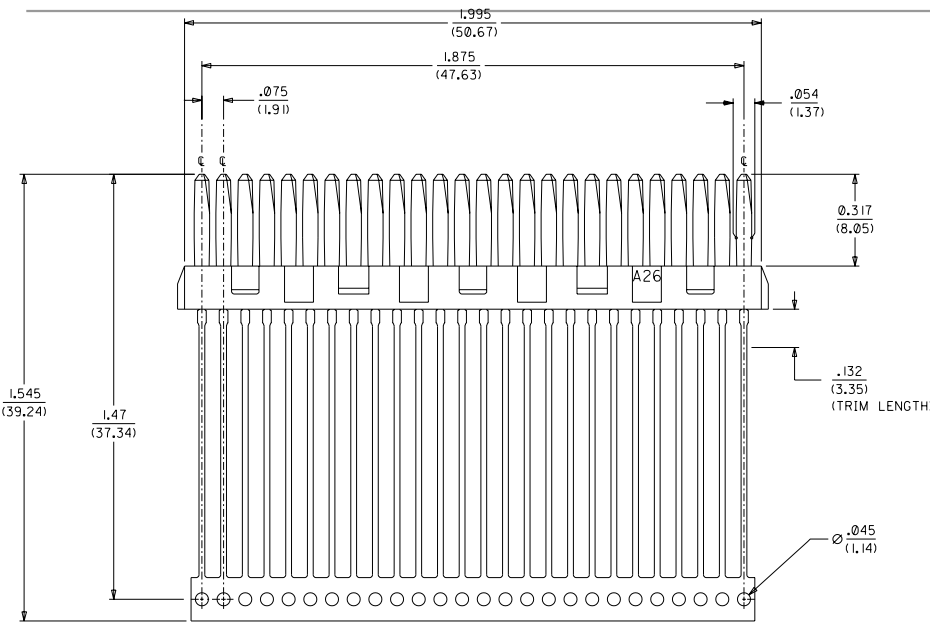

- NOTES:
- 1) INSULATOR MATERIAL IS LIQUID CRYSTAL POLYMER (LCP), RATED U.L. 94 V-0, COLOR IS BLACK
  - 2) TERMINAL MATERIAL IS PHOSPHOR BRONZE.
  - 3) TERMINAL PLATING IS .000030/(0.00076) MINIMUM GOLD IN CONTACT AREA AND .000100/(0.00254) MINIMUM TIN ON SOLDERTAILS, WITH NICKEL UNDERPLATE OVERALL.  
 \*THE PRIMARY SHIPPING CARTON WILL BE LABELED "COMPLIANT TO ROHS DIRECTIVE 2002/95/EC AND ELV ANNEX II OF DIRECTIVE 2000/53/EC". CARTONS WITHOUT THIS LABEL MAY CONTAIN PRODUCT WITH LEAD.
  - 4) ALL DIMENSIONS ARE SHOWN FOR REFERENCE ONLY.
  - 5) THIS COMPONENT CONFORMS TO PRODUCT SPECIFICATION PS-70660.
  - 6) PACKAGE PER SPECIFICATION PK-70873-0233.

B	ADDED PK SPEC UCF2004-1858 RWHITE 04/03/23
A	INITIAL RELEASE PER 1011989-0221 SCHMIDG 98/09/29

DIMENSIONS SHOWN (METRIC) INCH UNLESS OTHERWISE SPECIFIED TOLERANCES: ANGULAR ± 1/2°		MFG. SH. REV. LTR. REVISIONS															
<table border="1"> <tr> <th>PLACES</th> <th>INCH</th> <th>METRIC</th> </tr> <tr> <td>3 PLACES</td> <td>± .0001</td> <td>± .0025</td> </tr> <tr> <td>2 PLACES</td> <td>± .0002</td> <td>± .0050</td> </tr> <tr> <td>1 PLACE</td> <td>± .0005</td> <td>± .0127</td> </tr> </table>		PLACES	INCH	METRIC	3 PLACES	± .0001	± .0025	2 PLACES	± .0002	± .0050	1 PLACE	± .0005	± .0127	<table border="1"> <tr> <td>REVISE ONLY ON CAD SYSTEM</td> <td>REV. 0</td> </tr> </table>		REVISE ONLY ON CAD SYSTEM	REV. 0
PLACES	INCH	METRIC															
3 PLACES	± .0001	± .0025															
2 PLACES	± .0002	± .0050															
1 PLACE	± .0005	± .0127															
REVISE ONLY ON CAD SYSTEM	REV. 0																
<table border="1"> <tr> <td>DATE</td> <td>1/98</td> <td>DATE</td> <td>09/21</td> </tr> <tr> <td>BY</td> <td>SCHMIDG</td> <td>BY</td> <td>0221</td> </tr> </table>		DATE	1/98	DATE	09/21	BY	SCHMIDG	BY	0221	<table border="1"> <tr> <td>TITLE</td> <td>.075 PITCH LFH INSERT-MOLDED TERMINAL STRIP, 26 CKT. MALE (SALES DWG.)</td> </tr> <tr> <td>PART NO.</td> <td>SDA-71989-2002</td> </tr> <tr> <td>SEE CHART</td> <td></td> </tr> </table>		TITLE	.075 PITCH LFH INSERT-MOLDED TERMINAL STRIP, 26 CKT. MALE (SALES DWG.)	PART NO.	SDA-71989-2002	SEE CHART	
DATE	1/98	DATE	09/21														
BY	SCHMIDG	BY	0221														
TITLE	.075 PITCH LFH INSERT-MOLDED TERMINAL STRIP, 26 CKT. MALE (SALES DWG.)																
PART NO.	SDA-71989-2002																
SEE CHART																	
<table border="1"> <tr> <td>DRW. BY</td> <td>SCHMIDG</td> <td>CHK. BY</td> <td>KER</td> </tr> <tr> <td>APP'D.</td> <td>KER</td> <td>SCALE</td> <td>4:1</td> </tr> </table>		DRW. BY	SCHMIDG	CHK. BY	KER	APP'D.	KER	SCALE	4:1	<table border="1"> <tr> <td>FILE NAME</td> <td>5719892003</td> </tr> <tr> <td>THIS DRAWING CONTAINS INFORMATION THAT IS PROPRIETARY TO MOLEX INC. AND SHOULD NOT BE USED WITHOUT WRITTEN PERMISSION.</td> <td>CPPI C</td> </tr> </table>		FILE NAME	5719892003	THIS DRAWING CONTAINS INFORMATION THAT IS PROPRIETARY TO MOLEX INC. AND SHOULD NOT BE USED WITHOUT WRITTEN PERMISSION.	CPPI C		
DRW. BY	SCHMIDG	CHK. BY	KER														
APP'D.	KER	SCALE	4:1														
FILE NAME	5719892003																
THIS DRAWING CONTAINS INFORMATION THAT IS PROPRIETARY TO MOLEX INC. AND SHOULD NOT BE USED WITHOUT WRITTEN PERMISSION.	CPPI C																

13 12 11 10 9 8 7 6 5 4 3 2 1