

Excellent Integrated System Limited

Stocking Distributor

Click to view price, real time Inventory, Delivery & Lifecycle Information:

[Molex Connector Corporation](#)
[0986581223](#)

For any questions, you can email us directly:

sales@integrated-circuit.com

20 19 18 17 16 15 14 13 12 11 10 9 8 7 6 5 4 3 2 1

FORME ADMISE
ALLOWED VERSION

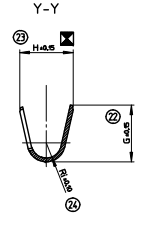
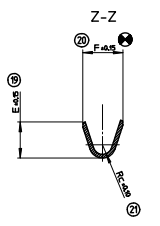
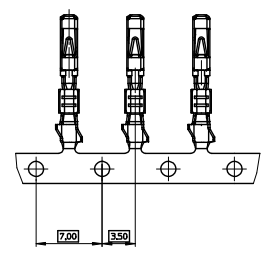
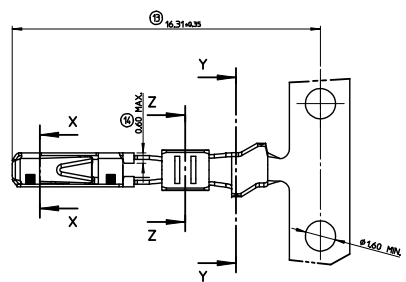
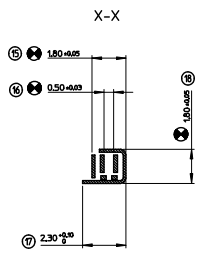
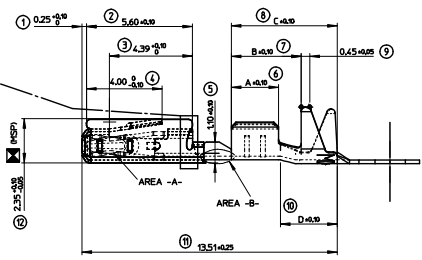

MOLEX REFERENCE	AREA -A- (GAP AREA)	AREA -B-	CRIMPING AREA	Wire size range	Longeurs Length	Serriesage Conductor Wire Crimp	Serriesage Insulat Isolation Crimp	Poids Weight
TIN PLATED VERSION 0986581211			HOT TIN DIP Sn = 1.0 to 3.0 Hh	0.22 to 0.60 mm2		A-250 E-190 F-240 Rc-050	G-290 H-280 Ri-080	0.1600 g
GOLD PLATED VERSION 0986581221	Au= 0.4 Hh MIN. Ni= 1.0 Hh MIN.		Sn = 1.0 to 5.0 Hh MIN. Ni = 1.0 Hh MIN.					
GOLD PLATED VERSION 0986581231	Au= 0.4 Hh MIN. Ni= 1.0 Hh MIN.	Au= 0.4 Hh MIN. Ni= 1.0 Hh MIN.	Sn = 1.0 to 5.0 Hh MIN. Ni = 1.0 Hh MIN.					
TIN PLATED VERSION 0986581212			HOT TIN DIP Sn = 1.0 to 3.0 Hh	0.75 mm2		A-280 E-225 F-225 Rc-050	G-290 H-280 Ri-080	
GOLD PLATED VERSION 0986581222	Au= 0.4 Hh MIN. Ni= 1.0 Hh MIN.		Sn = 1.0 to 5.0 Hh MIN. Ni = 1.0 Hh MIN.					
GOLD PLATED VERSION 0986581232	Au= 0.4 Hh MIN. Ni= 1.0 Hh MIN.	Au= 0.4 Hh MIN. Ni= 1.0 Hh MIN.	Sn = 1.0 to 5.0 Hh MIN. Ni = 1.0 Hh MIN.					
TIN PLATED VERSION 0986581213			HOT TIN DIP Sn = 1.0 to 3.0 Hh	0.22 to 0.50 mm2		A-250 E-180 F-180 Rc-040	G-230 H-230 Ri-070	
GOLD PLATED VERSION 0986581223	Au= 0.4 Hh MIN. Ni= 1.0 Hh MIN.		Sn = 1.0 to 5.0 Hh MIN. Ni = 1.0 Hh MIN.					
GOLD PLATED VERSION 0986581233	Au= 0.4 Hh MIN. Ni= 1.0 Hh MIN.	Au= 0.4 Hh MIN. Ni= 1.0 Hh MIN.	Sn = 1.0 to 5.0 Hh MIN. Ni = 1.0 Hh MIN.					

NOTE:

- MATERIAL: CONTACT BODY: HIGH CONDUCTIVE COPPER ALLOY. SLEEVE: STAINLESS STEEL.
- PACKAGING SPECIFICATION: PK-98658-006.
- CRIMPING PARAMETERS AND CRIMPING TOOL DEFINITION: SEE CS-98658-001.

INDICATION DIMENSIONS S.P.C DENOTES S.P.C DIMENSIONS
 INDICATION DIMENSIONS DETERMINANT LES CAPABILITIES MACHINE DENOTES DIMENSIONS DETERMINANT LES MACHINES ABILITIES
 INDICATION DIMENSIONS FONCTIONNELLES DENOTES FUNCTIONAL DIMENSIONS
 QUANTITE PAR FEUILLE INDIVIDUELLE QUANTITY PER INDIVIDUAL SHEET
 * = 2 * = 4 * = 0

REVISIONS 1. LOCATION SLEVE MOVED EC NO. 0204-0377 2014/03/07 2. DRINK/PLESSIS 2014/03/07 3. CHIKOMANDRE 2014/03/07 4. APPROVED/LOCOS 2014/03/07	GENERAL TOLERANCES (UNLESS SPECIFIED) mm INCH 4 PLACES ±--- ±--- 3 PLACES ±--- ±--- 2 PLACES ±.0 ±.0 1 PLACE ±.0 ±.0 0 PLACE ±.0 ±	DIMENSION STYLE MM ONLY DRAWN BY JTAMSON 1999/06/01 CHECKED BY MANDRE 1999/10/14 APPROVED BY CBOUCHAN 1999/10/14	SCALE 10:1 DESIGN UNITS METRIC FIRST ANGLE PROJECTION	
	MATERIAL NO. SEE CHART INCORPORATED AND SHOULD NOT BE USED WITHOUT WRITTEN PERMISSION	DOCUMENT NO. SD-98658-004	SHEET NO. 1 OF 1	TITLE MOX 0.63 TERMINAL RECEPTACLE TERMINAL GENERIC CONTROL DRAWING molex
	ANGULAR ±1/2° DRAFT WHERE APPLICABLE MUST REMAIN WITHIN DIMENSIONS	THIS DRAWING CONTAINS INFORMATION THAT IS PROPRIETARY TO MOLEX		

19 18 17 16 15 14 13 12 11 10 9 8 7 6 5 4 3 2 1