

Excellent Integrated System Limited

Stocking Distributor

Click to view price, real time Inventory, Delivery & Lifecycle Information:

[Molex Connector Corporation](#)
[0431783002](#)

For any questions, you can email us directly:

sales@integrated-circuit.com

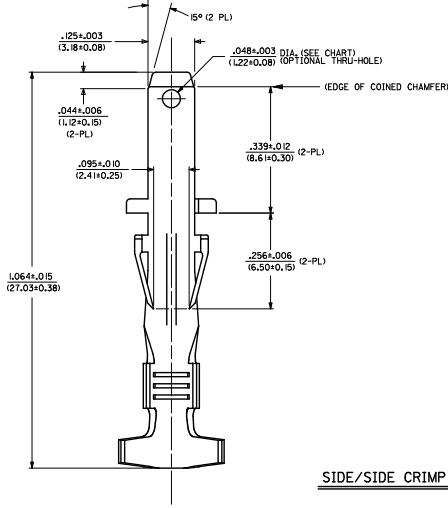
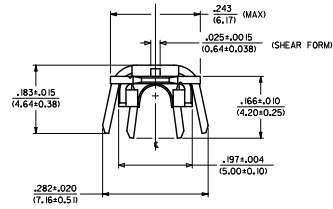

SIDE/SIDE CRIMP

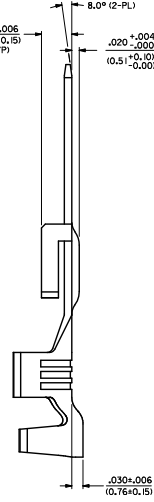

MATERIAL NUMBER	FINISH	HOLE
43178-3001	999	NOT USED
43178-3002	1901	NOT USED
43178-3003	F542	NOT USED

NOTES

- MATERIAL: BRASS
- FINISH: 999 - UNPLATED
1901 - 20 MICRONS MIN. HOT TIN DIP
F542 - 15 MICRONS MIN. SELECT GOLD IN CONTACT AREA, 50 MICRONS TIN-LEAD IN CRIMP AREA, NICKEL UNDERPLATE OVERALL.
- PRODUCT SPECIFICATION: PS-44441-001
- TERMINAL FOR USE WITH:
DOUBLE 18 AWG. UL 1015 STYLE WIRE (CRIMPED SIDE X SIDE)

REVISE NOTE #4 EC NO. LCP2700-2741 DRAWING NO. 2000/0103 CHKD-BELL 2000/0103 APPR-SPR 2000/0103 DESIGNED BY DESIGNED BY	QUALITY SYMBOLS	GENERAL TOLERANCES (UNLESS SPECIFIED)	DIMENSION STYLE IN/MM	SCALE 8:1	DESIGN UNITS INCH	THIRD ANGLE PROJECTION
	▽=0	4 PLACES ±.010	mm	DRAWN BY MAB	DATE 1995/06/16	TITLE TERMINAL CRIMP MALE TAB .125/(3.18)X.020/(0.51) SABRE - F.B.S. - T.P.A.
	▽=0	3 PLACES ±.010	INCH	CHECKED BY KBP	DATE 1995/06/16	MATERIAL NO. SEE CHART
	▽=0	2 PLACES ±0.25 ±.014		APPROVED BY FSMASH	DATE 29/09/99	DOCUMENT NO. SD-43178-3***
		1 PLACE ±0.35 ±.014	ANGULAR ±1/2°			SHEET NO. 1 OF 1
		DRAFT WHERE APPLICABLE MUST REMAIN WITHIN DIMENSIONS		THIS DRAWING CONTAINS INFORMATION THAT IS PROPRIETARY TO MOLEX INCORPORATED AND SHOULD NOT BE USED WITHOUT WRITTEN PERMISSION		