

Excellent Integrated System Limited

Stocking Distributor

Click to view price, real time Inventory, Delivery & Lifecycle Information:

[ASSMANN WSW Components](#)
[V-1100-SMD/A](#)

For any questions, you can email us directly:

sales@integrated-circuit.com

RoHS compliant

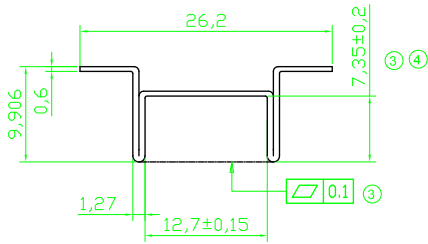
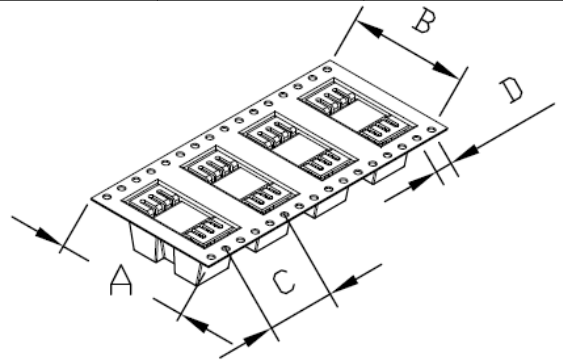
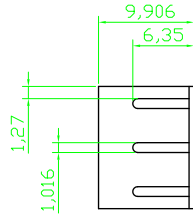
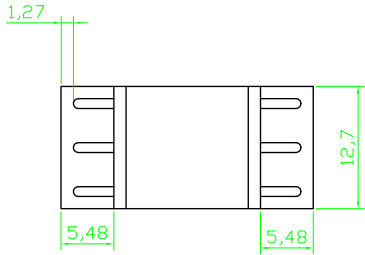

Tolerances: unless otherwise specified ±0,3

Material: Copper, 06mm thick
Finished: Tin plated

③ Tape & Reel
1Reel = 250PCS

	A	B	C	D
	44,0	40,40	24,0	4,0

Option	Verpackung / Packaging	Wärmewiderstand / Thermal resistance (K/W)
-	Tape & Reel / 250 pcs/reel	23
L	Loose Bulk	23

				Date	Name	Customer-No.
⑤	Modify drawing layout	10.03.2010	Alex	Drawn	19.06.02	Hellwig
④	change dimension	27.07.09	N.Schulz	Approved	10.03.2010	A.Plate
③	Update	14.05.09	N.Schulz			
②	Update	19.06.02	N.Schulz			
①	Neuanlage	19.06.02	N.Schulz			
Id.	Modification	Date	Name			ASSMANN WSW-No. V1100 SMD/A x
						Drawing-No. ASS 0518 HS
						Replace
						Sheet

1

2

3

4

5

6

7