

## Excellent Integrated System Limited

Stocking Distributor

Click to view price, real time Inventory, Delivery & Lifecycle Information:

[Phoenix Contact](#)  
[1771176](#)

For any questions, you can email us directly:  
[sales@integrated-circuit.com](mailto:sales@integrated-circuit.com)



Extract from the online catalog

## HC-B 6-SMLD/1PG16

Order No.: 1771176

Photo shows product without screw connection



<http://eshop.phoenixcontact.de/phoenix/treeViewClick.do?UID=1771176>

Box mounting base, with single locking latch, height 52 mm, with screw connection, 1x Pg16, with protective covers

### Commercial data

EAN	4017918035914
Pack	10 pcs.
Customs tariff	85389099
Weight/Piece	0.27098 KG
Catalog page information	Page 481 (PC-2009)

### Product notes

WEEE/RoHS-compliant since:  
03/01/2006



<http://www.download.phoenixcontact.com>  
Please note that the data given here has been taken from the online catalog. For comprehensive information and data, please refer to the user documentation. The General Terms and Conditions of Use apply to Internet downloads.

### Technical data

#### General data

Design	B6
Height	52 mm
Width	52 mm
Length	84 mm
Housing type	Box mounting base with cover

HC-B 6-SMLD/1PG16 Order No.: 1771176

<http://eshop.phoenixcontact.de/phoenix/treeViewClick.do?UID=1771176>

Locking type	With single locking latch
Type of the screw connection	1x Pg16
Pg screw connection	With
Wrench size, union nut	22 mm
Cable exit	Conductor exit direction to the left (looking into the open single locking latch)
External cable diameter	7.5 mm ... 15 mm
Protective cover	Yes
Degree of protection	IP65
Ambient temperature (operation)	-40 °C ... 125 °C
Housing material	Aluminum, die-cast
Housing surface material	Powder-coated, gray
Seal material	NBR
Cable gland material	Nickel-plated brass
Cable seal material	NBR
Locking latch material	High-grade steel, handle: PA-GF
Material grip body interlock	PA-GF
Material, protective cover	PA

### Certificates / Approvals



Certification

GOST

### Diagrams/Drawings

Dimensioned drawing

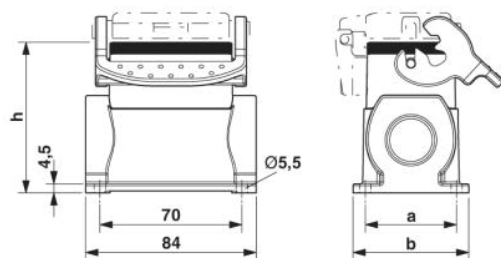

HC-B 6-SMLD/1PG16 Order No.: 1771176  
<http://eshop.phoenixcontact.de/phoenix/treeViewClick.do?UID=1771176>

---

**Address**

PHOENIX CONTACT Inc., USA  
586 Fulling Mill Road  
Middletown, PA 17057, USA  
Phone (800) 888-7388  
Fax (717) 944-1625  
<http://www.phoenixcon.com>



© 2010 Phoenix Contact  
Technical modifications reserved;