

Excellent Integrated System Limited

Stocking Distributor

Click to view price, real time Inventory, Delivery & Lifecycle Information:

[Phoenix Contact](#)
[2287135](#)

For any questions, you can email us directly:
sales@integrated-circuit.com



Extract from the online catalog

DFLK-D 9 SUB/B

Order No.: 2287135

The illustration shows version DFLK-D37 SUB/B



<http://eshop.phoenixcontact.de/phoenix/treeViewClick.do?UID=2287135>

VARIOFACE panel feed-through module, for direct coupling of single signal lines of up to 2.5 mm², with D-Subminiature socket strip, 9 pos.

Commercial data	
EAN	4017918056032
Pack	5 pcs.
Customs tariff	85369010
Weight/Piece	0.04545 KG
Catalog page information	Page 288 (IF-2009)

Product notes

WEEE/RoHS-compliant since:
12/21/2007



<http://www.download.phoenixcontact.com>
 Please note that the data given here has been taken from the online catalog. For comprehensive information and data, please refer to the user documentation. The General Terms and Conditions of Use apply to Internet downloads.

Technical data

General data	
Nominal voltage U _N	125 V AC/DC
Max. current carrying capacity per branch	2.5 A
Max. total current of all branches	22.5 A
Number of positions	9
Width	39 mm

DFLK-D 9 SUB/B Order No.: 2287135

<http://eshop.phoenixcontact.de/phoenix/treeViewClick.do?UID=2287135>

Height	33 mm
Depth	58.4 mm
Status display	No
Ambient temperature (operation)	-20 °C ... 50 °C
Ambient temperature (storage/transport)	-20 °C ... 70 °C
Mounting position	Any
Assembly instructions	In rows with zero spacing
Standard - Electrical safety	Air and creepage distances DIN EN 50178
Pollution degree	2
Surge voltage category	II

Connection data

Connection 1	PCB connection
Connection in acc. with standard	IEC / EN
Type of connection	Screw connection
Conductor cross section solid min.	0.2 mm ²
Conductor cross section solid max.	4 mm ²
Conductor cross section stranded min.	0.2 mm ²
Conductor cross section stranded max.	2.5 mm ²
Conductor cross section AWG/kcmil min.	24
Conductor cross section AWG/kcmil max	12
Stripping length	8 mm
Screw thread	M3
Connection 2	D-SUB connection
Type of connection	D-SUB socket
Number of positions	9

Certificates / Approvals

Certification

CUL, GOST, UL

CUL

Nominal voltage U_N	125 V
Nominal current I_N	2.5 A

DFLK-D 9 SUB/B Order No.: 2287135

<http://eshop.phoenixcontact.de/phoenix/treeViewClick.do?UID=2287135>

AWG/kcmil	30-12
UL	
Nominal voltage U_N	125 V
Nominal current I_N	2.5 A
AWG/kcmil	30-12

Accessories

Item	Designation	Description
Cable/conductor		
2302434	CABLE D-SUB-S-S-S/.../.../...	Shielded round cable, assembled with two D-SUB male connectors, variable cable length
2302340	CABLE D-SUB-S/.../.../...	Shielded round cable, assembled with one D-SUB male and one female connector, variable cable length
2299987	CABLE-D 9SUB/B/S/ 50/ KONFEK/S	Round shielded cable set, with 9-pos. D-SUB female and male connectors, cable length: 0.5 m
2299990	CABLE-D 9SUB/B/S/100/ KONFEK/S	Round shielded cable set, with 9-pos. D-SUB female and male connectors, cable length: 1 m
2300009	CABLE-D 9SUB/B/S/150/ KONFEK/S	Round shielded cable set, with 9-pos. D-SUB female and male connectors, cable length: 1.5 m
2302010	CABLE-D 9SUB/B/S/200/ KONFEK/S	Round shielded cable set, with 9-pos. D-SUB female and male connectors, cable length: 2 m
2302023	CABLE-D 9SUB/B/S/300/ KONFEK/S	Round shielded cable set, with 9-pos. D-SUB female and male connectors, cable length: 3 m
2302036	CABLE-D 9SUB/B/S/400/ KONFEK/S	Round shielded cable set, with 9-pos. D-SUB female and male connectors, cable length: 4 m
2302049	CABLE-D 9SUB/B/S/600/ KONFEK/S	Round shielded cable set, with 9-pos. D-SUB female and male connectors, cable length: 6 m

DFLK-D 9 SUB/B Order No.: 2287135

<http://eshop.phoenixcontact.de/phoenix/treeViewClick.do?UID=2287135>

Diagrams/Drawings

Dimensioned drawing

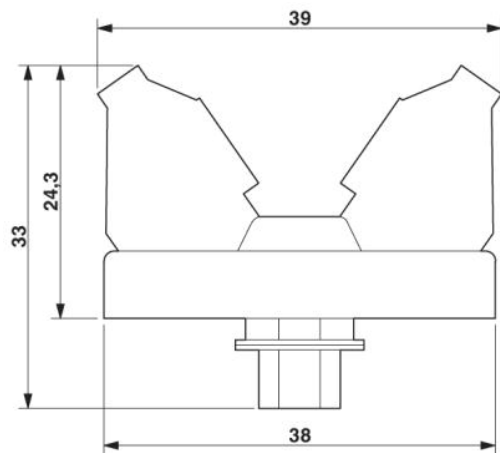
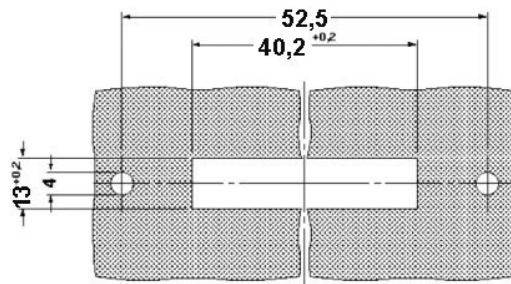
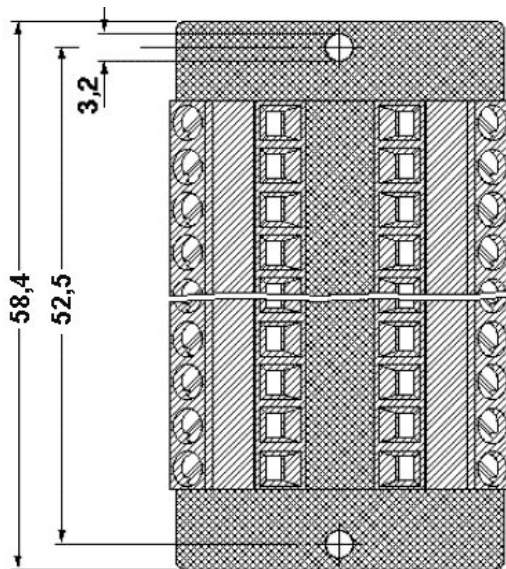

DFLK-D 9 SUB/B Order No.: 2287135

<http://eshop.phoenixcontact.de/phoenix/treeViewClick.do?UID=2287135>

Address

PHOENIX CONTACT Deutschland GmbH
Flachsmarktstr. 8
32825 Blomberg, Germany
Phone +49 5235 3 12000
Fax +49 5235 3 41200
<http://www.phoenixcontact.de>



© 2010 Phoenix Contact
Technical modifications reserved;