

Date	SYM	REVISION RECORD	AUTH	DR.	CK.
03/15/03	A	TIN PLATED WAS NICKEL PLATED	T.B.	B.S.	
2/25/06	B	ADDED "ROHS COMPLIANT"	T.B.	B.S.	
11/21/14	C	UPDATED TO ROHS 2 COMPLIANT	T.B.	B.S.	

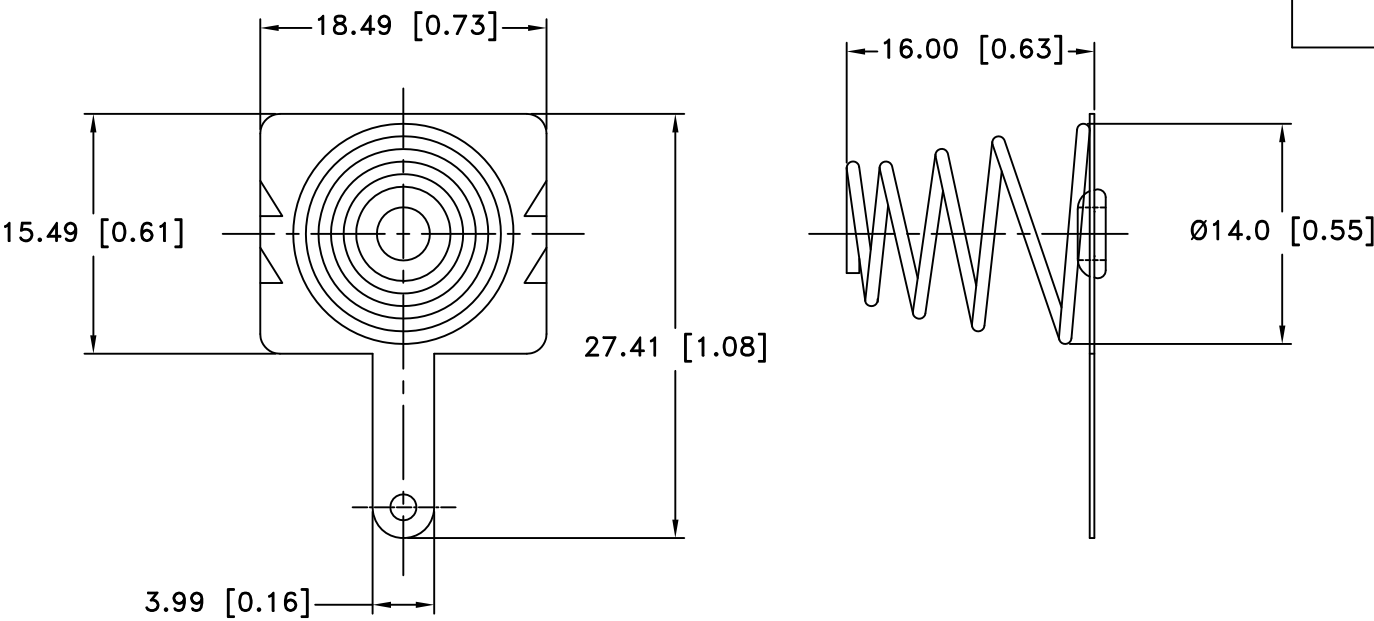

- NOTES:
- 1. BASE: STEEL, 0.3mm (0.012") THICK. TIN PLATED.
 - 2. SPRING: STEEL, 0.8mm (0.032") THICK. NICKEL PLATED.
 - 3. ROHS 2 COMPLIANT

Tolerance (Except as noted)	<div><div><div></div><div></div><div></div></div><div>MPD</div></div> <div>Memory Protection Devices, Inc 200 Broad Hollow Road, Farmingdale, New York 11735</div>		
decimal ±.5 (.020)		Scale	Drawn By B.S. Approved By T.B.
Fractional ± .8 (.030)	Title SNT8 "C" CELL BATTERY CONTACT		
Angular ± 3°	Date 11/21/14	Drawing Number SNT8-2	