

Excellent Integrated System Limited

Stocking Distributor

Click to view price, real time Inventory, Delivery & Lifecycle Information:

[Cinch Connectivity Solutions](#)
[108-1702-101](#)

For any questions, you can email us directly:
sales@integrated-circuit.com

Banana Plug - Insulated Side Set Screw Solderless

INCHES (MILLIMETERS)
CUSTOMER DRAWINGS AVAILABLE UPON REQUEST

SPECIFICATIONS

Plug Body: Brass per QQ-B-626D

Plug Spring: Nickel silver per QQ-C-585

Finish: Nickel

Insulated Handle: Nylon 6/6 per ASTM D4066

RATINGS

Current: 15 amps

Breakdown Voltage: 35 Vrms minimum

Contact Resistance: 0.010 ohms maximum

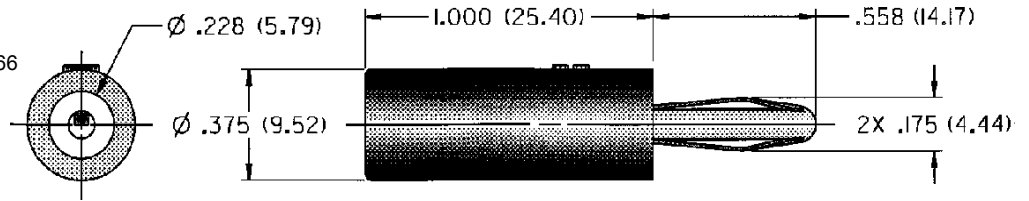

NICKEL PLATING

108-1702-101 Red

**For Standard Banana Jack: .166 (4.23) Diameter
For Low Voltage (50 WVDC) Applications**

FEATURES:

- Fast solderless connection of up to 16 gauge wire
- Set screw for dependable connections with low voltage
- Nylon UL approved for self extinguishing