

Excellent Integrated System Limited

Stocking Distributor

Click to view price, real time Inventory, Delivery & Lifecycle Information:

[Bel Fuse Inc.](#)
[PL30-9](#)

For any questions, you can email us directly:
sales@integrated-circuit.com

DASH NO	CABLES ACCOMMODATED	ASSEMBLE PER
-8	8227 BELDEN	TAI-140
-9	TWC-7B-2/TWC-124-2	TAI-121
-10	RG-22/754E AT&T	TAI-140
-11	760 AT&T	TAI-140
-12	16 PEVL AT&T/ VIAL GENERAL	TAI-139
-25	T-43M GENERAL	TAI-121
-27	202-3927 MICRODOT	TAI-121
-29	TWC-7B-1/TWC-124-1A	TAI-121
-45	10602 RAYCHEM	TAI-140
-46	9860 BELDEN	TAI-140
-47	M17/176-00002	TAI-121
-49	TWAC-7B-1F2	TAI-140
-54	89207 BELDEN	TAI-121
-55	89272 BELDEN	TAI-121

FIG 1

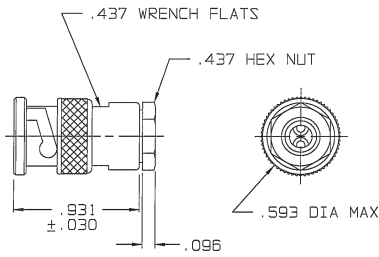

-9 SHOWN

-9, -25, -27, -29, -45, -47 & -49

FIG 2

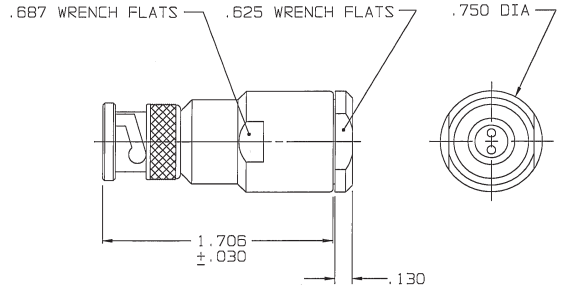

-8 SHOWN

-8, -10, -11, -12, -46 & -54

6. EXAMPLE OF COMPLETE PART NO:

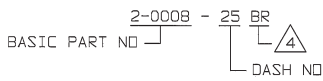

5. EXAMPLE OF COMPLETE MODEL NO:

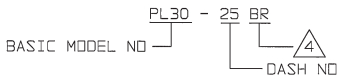

IF BEND RELIEF SPRING REQD, (SEE FIG 3) ADD SUFFIX "BR" TO DASH NO (NOT AVAILABLE WITH CABLE GROUPS -8, -10, -11, -12, -46 & -54)

3. TWINAXIAL BNC TYPE, TWO PIN CABLE PLUG

2. FINISH: TFS-1A (NICKEL)

1. ALL DIM ARE IN INCHES

FIG 3

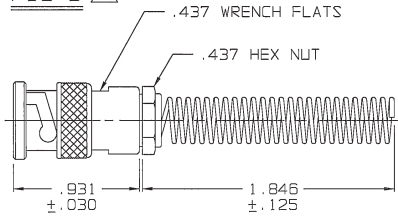

-9BR SHOWN

-9, -25, -27, -29, -45, -47 & -49

RED INDICATES ORIGINAL

REVISIONS		2-0008	SH 1
REV	DESCRIPTION	DATE	APPROVED
AD	REVISED PER ECD 15446	5/10/04	WJ

<small> DATA CONTAINED IN THIS DOCUMENT IS UNCLASSIFIED EXCEPT WHERE SHOWN OTHERWISE AND SHALL NOT BE CONTROLLED, RELEASED, USED OR DISSEMINATED IN ANY MANNER WITHOUT THE WRITTEN PERMISSION OF TROMPETER ELECTRONICS, INC. </small>	<small> TROMPETER RF connectivity </small>
<small> DISCREPANCY FOR: PL 30-9 DIMENSIONS ARE IN INCHES UNLESS OTHERWISE SPECIFIED UNLESS OTHERWISE SPECIFIED </small>	<small> TITLE: PL30 SIZE: B 14949 DRAWING NO: 2-0008 SCALE: 2/1 DATE: 2/18/05 SHEET: 1C </small>