

Excellent Integrated System Limited

Stocking Distributor

Click to view price, real time Inventory, Delivery & Lifecycle Information:

[Bel Fuse Inc.](#)
[27-9105](#)

For any questions, you can email us directly:
sales@integrated-circuit.com

PART NUMBER	ITEM ① BODY	ITEM ② CONTACT	ITEM ③ INSULATOR	ITEM ④ CRIMP SLEEVE	ITEM ⑤ CUPLING NUT
27-9105	BRASS NICKEL PLATED	BRASS GOLD PLATED	DELRIN	BRASS NICKEL PLATED	ZINC NICKEL PLATED

受控 CONTROLLED DOCUMENT					
编号 P/N	27-9105	版本 Rev	01	日期 Rel'd Date	May8,09

DRAWING NO.	27-9105
REVISIONS	
01	OFFICIAL RELEASE
04-05-09	Thomas C...

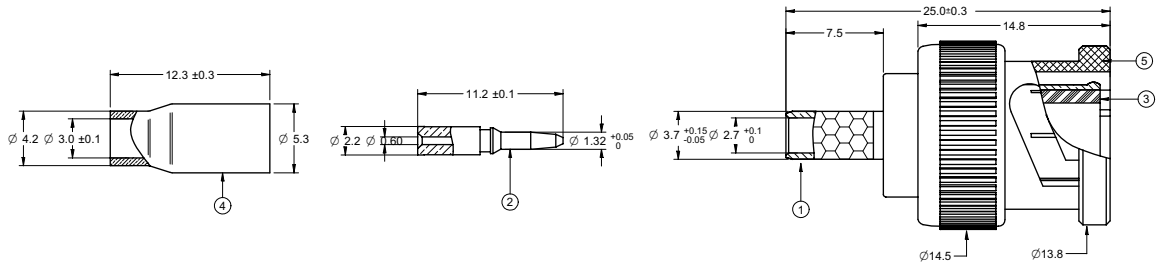

- NOTES:
1. IMPEDANCE: 50 OHMS NOMINAL
 2. FREQUENCY RANGE: 0-4 GHz
 3. CABLE ACCEPTABILITY: RG174, RG187, RG188, RG316
 4. CABLE RETENTION: 20lbs MIN
 5. RECOMMENDED TEMPERATURE RANGE: -55 °C TO +85 °C
 6. FURTHER TECHNICAL DETAIL: REFER TO EMERSON DOCUMENT P/N 27-0000

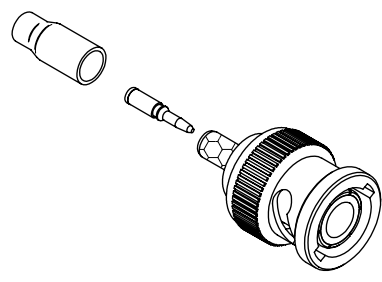

THIS DRAWING TO BE INTERPRETED
PER ANS Y 14.5M - 1994

COMPANY CONFIDENTIAL

TOLERANCE UNLESS OTHERWISE SPECIFIED	DRAWN BY TERRY W	DATE 04-05-09	TITLE BNC MALE CRIMP FOR RG174/U
DECIMALS	CHECKED BY TERRY W	DATE 04-05-09	
X	APPROVED BY THOMAS	DATE 04-05-09	
XX			
XXX			
ANGLES	U/M	mm	
THIS DRAWING WAS PRODUCED BY COMPUTER, DO NOT SCALE DRAWING OR UPDATE MANUALLY.			SHEET 1 OF 1
			DRAWING NO. 27-9105
			SIZE C

5 4 3 2 1