



Distributor of Harwin Inc.: Excellent Integrated System Limited

Datasheet of M22-6361242 - Connector Receptacle, Bottom or Top Entry 24 Position 0.079"
(2.00mm) Gold Surface Mount

Contact us: sales@integrated-circuit.com Website: www.integrated-circuit.com

Excellent Integrated System Limited

Stocking Distributor

Click to view price, real time Inventory, Delivery & Lifecycle Information:

[Harwin Inc.](#)

[M22-6361242](#)

For any questions, you can email us directly:

sales@integrated-circuit.com

Customer Information Sheet

DRAWING No.: M22-636XXXX SHEET 2 OF 2

Contact us: sales@integrated-circuit.com or www.integrated-circuit.com

ALL DIMENSIONS IN mm

ORDER CODE: **M22-636XXXX**
 No. OF CONTACTS PER ROW: 02 TO 20
 FINISH:
 42 - SELECTIVE GOLD FLASH & 100% TIN
 46 - 100% TIN

RECOMMENDED PCB LAYOUT
 (TOLERANCE = ±0.05)

∅ 1.00±0.05 TYP
 ∅ 0.85^{+0.05}₀ TYP

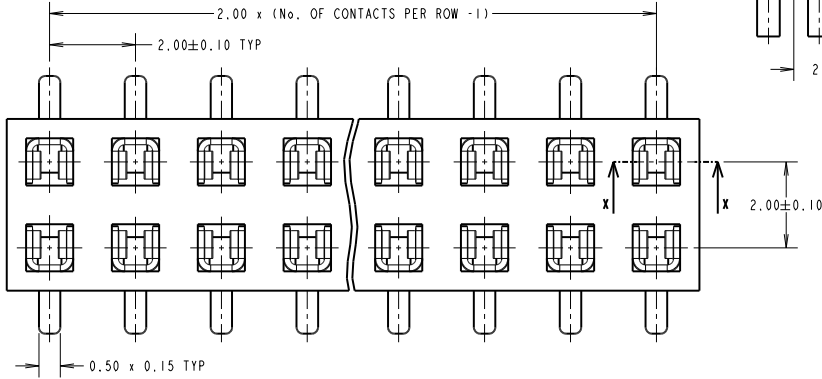
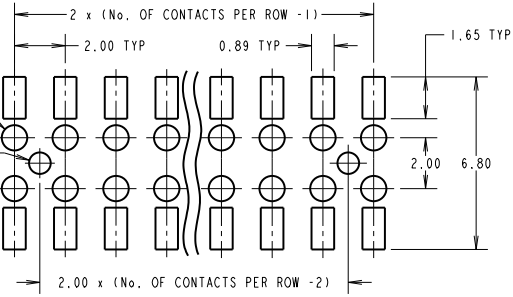

SPECIFICATION:
 MATERIAL = PA9T, UL94V-0, BLACK
 CONTACTS = PHOSPHOR BRONZE
 FINISH:
 42 = NICKEL ALL OVER WITH GOLD FLASH
 ON CONTACT AREA AND 100% TIN ON TAILS
 46 = 100% TIN OVER NICKEL
 ELECTRICAL:
 CURRENT RATING = 2A
 CONTACT RESISTANCE = 20mΩ MAX
 INSULATION RESISTANCE = 1000MΩ MIN
 DIELECTRIC WITHSTANDING = 500V AC MIN
 MECHANICAL:
 INSERTION FORCE = 1.77N MAX
 WITHDRAWAL FORCE = 0.25N MIN
 ENVIRONMENTAL:
 TEMPERATURE RANGE = -40°C TO +105°C
 PACKING:
 TUBE
 FOR COMPLETE SPECIFICATION, SEE COMPONENT
 SPECIFICATION C018XX (LATEST ISSUE).

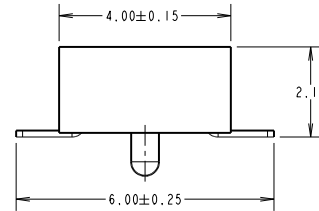
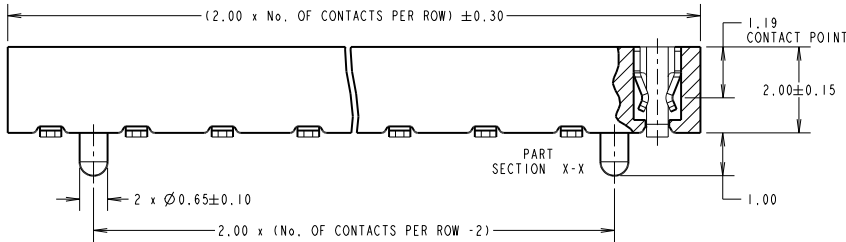

MSP	10	15.06.15	12803
NAME	ISS.	DATE	C/NOTE
APPROVED: M.PERREN			
CHECKED: S.BENNETT			
DRAWN: D.BECK			
CUSTOMER REF.:			
ASSEMBLY DRG.:			

NOTES:
 1. ALL TOLERANCES ARE ±0.25, UNLESS OTHERWISE STATED.

 www.harwin.com technical@harwin.com	<p>THIS DRAWING AND ANY INFORMATION OR DESCRIPTIVE MATTER SET OUT HEREON ARE CONFIDENTIAL AND COPYRIGHT PROPERTY OF THE HARWIN GROUP AND MUST NOT BE DISCLOSED, LOANED, COPIED OR USED FOR MANUFACTURING, TENDERING OR FOR ANY OTHER PURPOSE WITHOUT THEIR WRITTEN PERMISSION.</p>	<p>TOLERANCES</p> <p>= ±1.0mm</p> <p>X.X = ±0.50mm</p> <p>X.XX = ±0.10mm</p> <p>X.XXX = ±0.01mm</p> <p>ANGLES = ±°</p> <p>UNLESS STATED</p>	<p>MATERIAL:</p> <p>SEE ABOVE</p>	<p>TITLE:</p> <p>2mm PITCH D1L SMT VERTICAL LOW PROFILE SOCKET ASSEMBLY</p>
		<p>FINISH:</p> <p>S/AREA:</p> <p>mm²</p>	<p>DRAWING NUMBER:</p> <p>M22-636XXXX</p>	<p>SHT</p> <p>2 OF 2</p>