

Excellent Integrated System Limited

Stocking Distributor

Click to view price, real time Inventory, Delivery & Lifecycle Information:

[Harwin Inc.](#)
[K3600-91](#)

For any questions, you can email us directly:
sales@integrated-circuit.com

HIGH CURRENT CABLE CONNECTORS

A choice of 2 and 3 way high reliability Power Connectors with crimp and solder-bucket terminations.



- 10 Amp current rating
- Fully polarised housings
- Latching for strain-relief
- Back Potting for Sealing Protection Ratings of IP55, combined with "O" ring for IP67. Order Code K3605-00
- Supplied loose for customer assembly
- Standard colour grey. Contact Technical Sales for other colours and plating options
- For Tooling see below
- Wire size: 18 AWG

MALE HOUSING

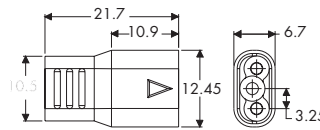

Order Code

2 way K3600-91

3 way K3700-91

FEMALE HOUSING

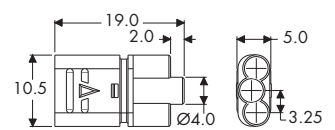

Order Code

2 way K3601-91

3 way K3701-91

CONTACTS

MALE SOLDER BUCKET

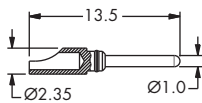

Tin Plated Order Code

K3602-06

FEMALE SOLDER BUCKET

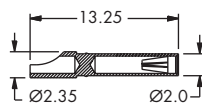

Tin Shell, Tin Contact Order Code

K3603-T6

MALE CRIMP CONTACT

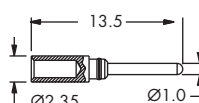

Tin Plated Order Code

K3606-06

FEMALE CRIMP CONTACT

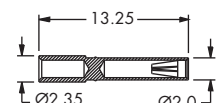

Tin Shell, Tin Contact Order Code

K3607-T6

CRIMP BARREL SIZE

Wire Size (AWG)	Crimp Tool Setting	Pull-off Force (Newtons)
18	8	142N

Insertion/Withdrawal Tool Order Code:
ZK3610-00

Order Code:
M22520/2-01
(Use with Positioner)

Positioner Order Code:
ZK3609-00
(Use with Crimp Tool)

WIRE STRIPPING DETAILS

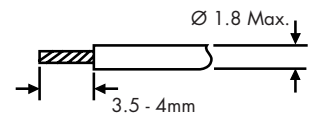

TOOLING FOR POWERFIT SERIES

Extraction Tool Order Code: **ZKF-021**

HAND CRIMP TOOL

Order Code: **ZKF-020**

SEMI AUTOMATED TOOLING

Machine Order Code: **ZGP-PEO**

Contact Order Code	AWG	Mini Applicator	Spares
KF-4400006	16-20	ZKF-022	ZKF-023
KF-4410006	22-24	ZKF-024	ZKF-025
KF-4600006	16-20	ZKF-022	ZKF-023
KF-4610006	22-24	ZKF-024	ZKF-025
KF-4620006	26-28	ZKF-026	ZKF-027