

## Excellent Integrated System Limited

Stocking Distributor

Click to view price, real time Inventory, Delivery & Lifecycle Information:

[Harwin Inc.](#)  
[R4751-02](#)

For any questions, you can email us directly:  
[sales@integrated-circuit.com](mailto:sales@integrated-circuit.com)

DRAWING NUMBER  
 R4751-02 —  
 R4757-02



THIRD ANGLE PROJECTION

DO NOT SCALE

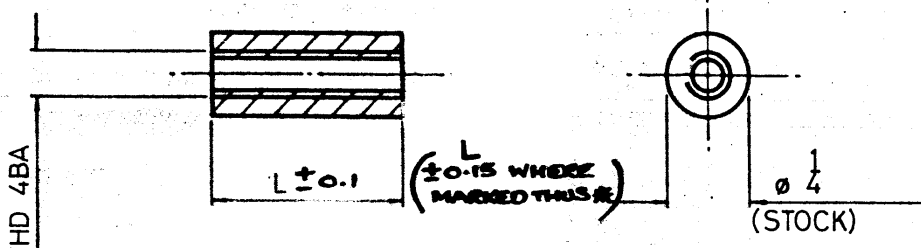

|    |         |                          |
|----|---------|--------------------------|
| 14 | 2.10.91 | 1890                     |
| 13 | 1/81    | 1081                     |
| 12 | 8/2/86  | 932                      |
| 11 | 5.3.79  | FINISH WAS DTD 9/9       |
| 10 | 1-11-78 | WAS REVISION TO R4751-02 |

|          |                              |        |        |
|----------|------------------------------|--------|--------|
| R4757-02 | 864.298                      | 1.000  | *25.4  |
| R4756-02 | 761.224                      | .875   | *22.22 |
| R4755-02 | 657.825                      | .750   | *19.05 |
| R4754-02 | 554.751                      | .625   | *15.88 |
| R4753-02 | 451.352                      | .500   | 12.70  |
| R4752-02 | 347.952                      | .375   | 9.52   |
| R4751-02 | 244.878                      | .250   | 6.35   |
| PART NO  | SURFACE AREA MM <sup>2</sup> | IN     | mm     |
|          |                              | L ±0.1 |        |

NOTE  
 1 THD. TO BE MANU. IN ACCORDANCE WITH BS93 1951 NORMAL CLASS  
 2. 0.25 CHAMFER FOR LEAD IN ON THREAD. REMOVE ALL BURRS.

|               |             |
|---------------|-------------|
| ISS. DATE     | CHANGE      |
| APPD.         |             |
| CHKD.         |             |
| DRAWN         |             |
| OLD REF.      | R4051-R4057 |
| ASSY. DRAWING |             |

**HARWIN ENGINEERS S.A.**  
 PORTSMOUTH PO6 1RT

MATERIAL BRASS BS2874 C2121  
 TITLE  
 THREADED SPACER - ROUND

FINISH(NICKEL PLATE) F0203  
 TOLERANCES  
 FRAC. ± 1/64 DEC ± .005. MM ±  
 DIMS. IN INCH(mm) SCALE —

DRAWING NUMBER  
 R4751-02 —  
 R4757-02