



## **Excellent Integrated System Limited**

Stocking Distributor

Click to view price, real time Inventory, Delivery & Lifecycle Information:

[Essentra Components \(formerly Richco, Inc.\)](#)  
[NMS-306](#)

For any questions, you can email us directly:  
[sales@integrated-circuit.com](mailto:sales@integrated-circuit.com)

PART NO.	"A"	"B"	THREAD	"C"
NMS-306	.25 (6.4)	.10 (2.5)	M3	.22 (5.7)
NMS-308	.31 (8.0)			
NMS-310	.39 (10.0)			
NMS-312	.48 (12.1)	.11 (2.8)	M4	.29 (7.4)
NMS-408	.31 (8.0)			

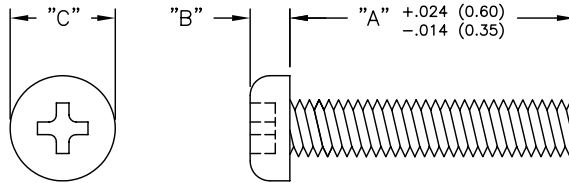

NOTES:

- MATERIAL: NYLON 6/6 (RMS-01).
- COLOR: NATURAL.

TITLE: NYLON METRIC SCREWS		DWG IN IN (MM)		FINAL	
TOLERANCES UNLESS NOTED .XX=±.010 .XXX=±.005 FRAC=±1/64 ANG=±1°		FILE # NMS	DWN: P.B.	APP:	
RE: RICHCO, INC.		DT: 07-24-95		DT:	
PO BOX 804238, CHICAGO, 60680 (773) 539-4060		PART #		PRINT TYPE	
SEE TABLE		CA			
B	SEE CO 200041 FOR CHANGES	SK	09.28.07		
A	CHANGED FILE NO.	SM	08.16.02		
REV	DESCRIPTION	ENGR	DATE		