



Excellent Integrated System Limited

Stocking Distributor

Click to view price, real time Inventory, Delivery & Lifecycle Information:

[Essentra Components \(formerly Richco, Inc.\)](#)
[SRSG6-04-01](#)

For any questions, you can email us directly:
sales@integrated-circuit.com

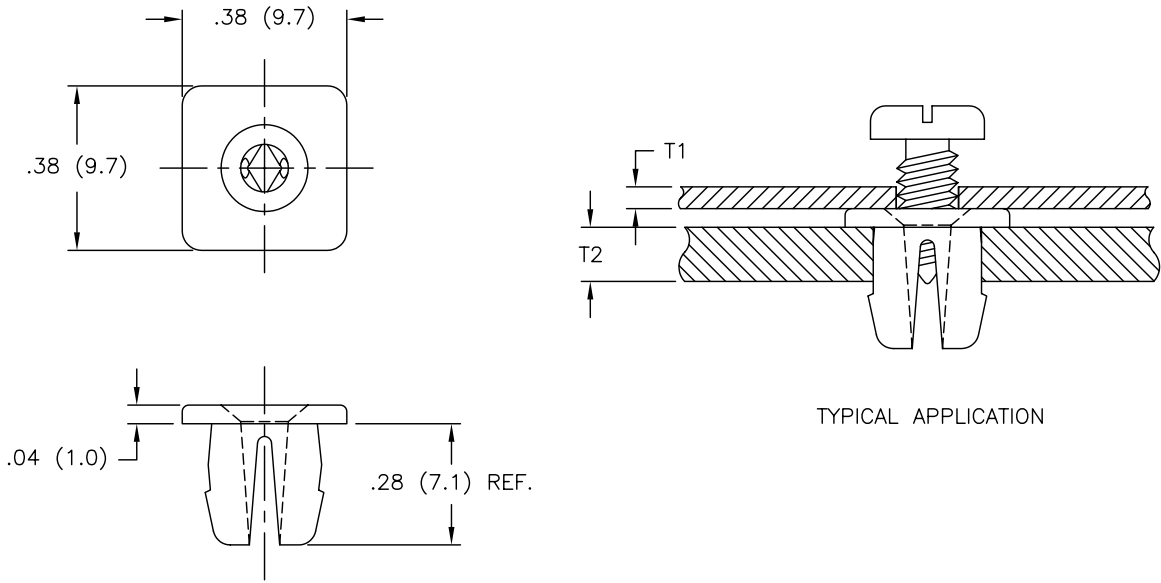

NOTES:

1. MATERIAL: NYLON 66 (RMS-01), NAT.
2. PANEL THICKNESS RANGE T2:
.031-.125 (0.79-3.18)
3. SCREW SIZE: #6 SELF TAPPING
4. RECOMMENDED SCREW LENGTH=
T1 + .32 (8.1)
5. MOUNTING HOLE: .245 - .255
(6.22-6.48) SQUARE

| | | |
|-----|----------------------------------|-------------|
| A | CHANGED FILE NO. AND TITLE BLOCK | SM 05.16.01 |
| REV | DESCRIPTION | ENGR DATE |

| | | | | | | | |
|--|------------------|--|------|-------------|---------------|-------------------|--|
| TITLE: SELF RETAINING SCREW GROMMET | | | | | | DWG IN IN (MM) | |
| TOLERANCES UNLESS NOTED .XX=±.010 .XXX=±.005 FRAC=1/64 ANG=1° | FILE # SRSG | DWN: P.B. | APP: | FINAL | | | |
| | MAT'L: SEE NOTES | DT: 07-08-94 | DT: | PART # | PRINT TYPE | | |
| | RE: RICHCO, INC. | RICHCO INC. PO BOX 804238, CHICAGO, 60680 (773) 539-4060 | | SRSG6-04-01 | CA | | |