



Excellent Integrated System Limited

Stocking Distributor

Click to view price, real time Inventory, Delivery & Lifecycle Information:

[Essentra Components \(formerly Richco, Inc.\)](#)
[UMS-16-45](#)

For any questions, you can email us directly:
sales@integrated-circuit.com

PART NO.		MAXIMUM BUNDLE DIA.	RADIUS "R"
W/O TAPE	W/TAPE		
UMS-16-45	UMS-16-45A-RT	1 (25.4)	1/2 (12.7)
UMS-24-45	UMS-24-45A-RT	1-1/2 (38.1)	3/4 (19.1)
UMS-32-45	UMS-32-45A-RT	2 (50.8)	1 (25.4)

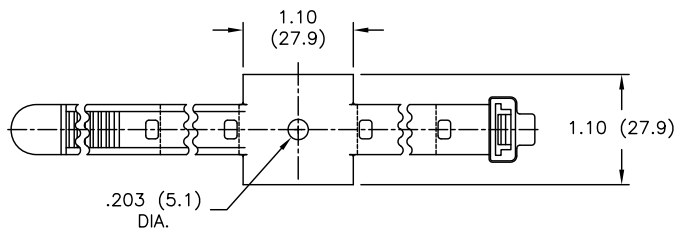
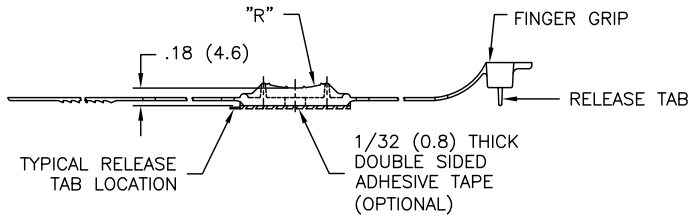
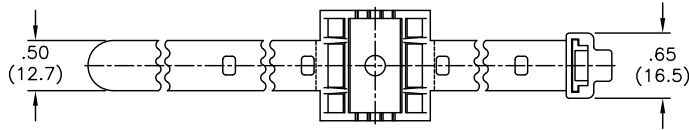

RICHCO RIVET NO.	PANEL THICKNESS RANGE
SR5045	UP TO 0.018 (0.5)
SR5055	.018 TO .058 (0.5-1.5)
SR5065	.058 TO .097 (1.5-2.5)
SR5075	.097 TO .137 (2.5-3.5)
SR5085	.137 TO .176 (3.5-4.5)
SR5095	.176 TO .215 (4.5-5.5)
SR5105	.215 TO .255 (5.5-6.5)

NOTES:

1. MATERIAL: NYLON 6/6 (RMS-45).
2. COLOR: BLACK.
3. FOR MOUNTING USE SNAP RIVETS "SR-SERIES", #6 SCREW OR ACRYLIC ADHESIVE TAPE (RMS-15).

TITLE: UNIVERSAL MOUNTING STRAP		DWG IN IN (MM)		FINAL	
TOLERANCES UNLESS NOTED .XX=±.010 .XXX=±.005 FRAC=±1/64 ANG=±1°		FILE # UMS	DWN: P.B.	APP:	
RE: RICHCO, INC.		DT: 01-18-95 DT:		PART # SEE TABLE	
		RICHCO INC. PO BOX 804238, CHICAGO, 60680 (773) 539-4060		PRINT TYPE CA	

REV	DESCRIPTION	ENGR	DATE
D	SEE CO 200171 FOR CHANGES	SK	04.29.08
C	SEE ECN #551 FOR CHANGES	SM	01.07.03
B	CHANGED TAPE NOTE AND FILE NO.	SM	12.11.01
A	CHANGED RMS-73 TO RMS-45	JB	04.22.96