



Excellent Integrated System Limited

Stocking Distributor

Click to view price, real time Inventory, Delivery & Lifecycle Information:

[Visual Communications Company, LLC](#)
[7511A53](#)

For any questions, you can email us directly:

sales@integrated-circuit.com



| REV | ECR NO./DESCRIPTION | DATE |
|-----|-----------------------------------|---------|
| A | 14794 NEW RELEASE | 7/7/97 |
| B | 14820 WAS Ø.160 HM | 7/14/97 |
| C | 14848 CHANGED TO SALES DWG. HM | 7/23/97 |

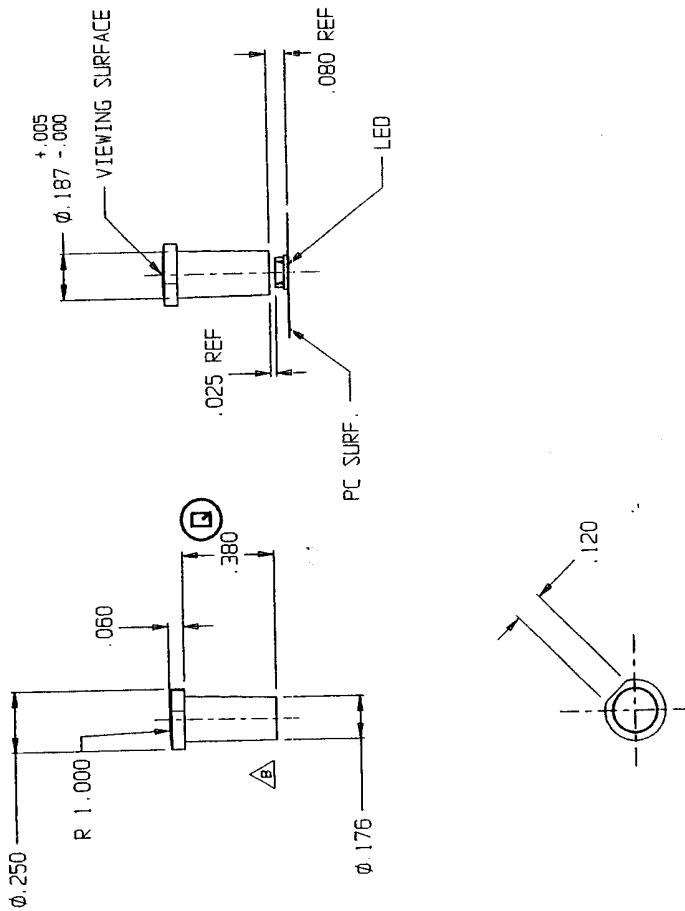

FOR INSPECTION USE ONLY
 SPC DOCUMENTATION REQ. (X R CHARTS)

DATE: OCT 10 2000

DIST: S

| | |
|---|---------------------------------------|
| PART NO. - | TITLE |
| MODEL NO. 7511A53 | VERTICAL LIGHTPIPE |
| MATERIAL: SEE NOTE | CHICAGO MINIATURE LAMP INC. |
| FINISH: NOTED | 147 CENTRAL AVE. HACKENSACK, NJ 07601 |
| TOLERANCE UNLESS OTHERWISE SPECIFIED: DRAWN H. MARINO | SCALE: 2 : 1 |
| INCHES .0005 ± .010 | CHECKED NS 10-5-98 |
| ANGLE ± 1 DEG. | ENG. APPR NS 10-5-98 |
| | REV: B13679 C |

THIS DWG IS THE PROPERTY OF CHICAGO MINIATURE LAMP INC. AND IS PROPRIETARY IN GENERAL AND IN DETAIL. IT SHALL NOT BE COPIED OR ITS CONTENTS REVEALED TO OUTSIDE PARTIES WITHOUT THE WRITTEN CONSENT OF CHICAGO MINIATURE LAMP INC.

DO NOT SCALE

- NOTES:
1. LIGHTPIPE TO BE MOLDED IN A CLEAR 94-V0 POLYCARBONATE.
 2. PART TO BE FREE OF BUBBLES AND BLACK SPECKS THAT MAY INHIBIT LIGHT OUTPUT WHEN VIEWED AT THE NORMAL VIEWING ANGLE.
 3. VIEWING SURFACE TO HAVE A #24 CHARVILLE FINISH
 4. LED SHOWN FOR REFERENCE

END DWG

SHEET -