

## Excellent Integrated System Limited

Stocking Distributor

Click to view price, real time Inventory, Delivery & Lifecycle Information:

[Molex Connector Corporation](#)  
[1300130099](#)

For any questions, you can email us directly:

[sales@integrated-circuit.com](mailto:sales@integrated-circuit.com)

MATERIAL NUMBER	OLD PART NUMBER	FINISH LENGTH
130013-0099	1R2G06A20A120	1.0 <sup>+</sup> .75-0 [3M+19.1-0]

VOLTAGE RATING	600 VAC/VDC
AMPERAGE RATING	13A
PROJECTION	IP67
OPERATING TEMPERATURE	-20° C TO 105° C
UL CERTIFICATIONS	UL RECOGNIZED, FILE NO. E152210
CSA CERTIFICATIONS	CSA CERTIFIED, FILE NO. LR6837

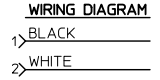
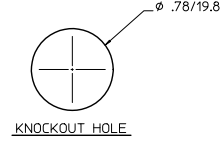
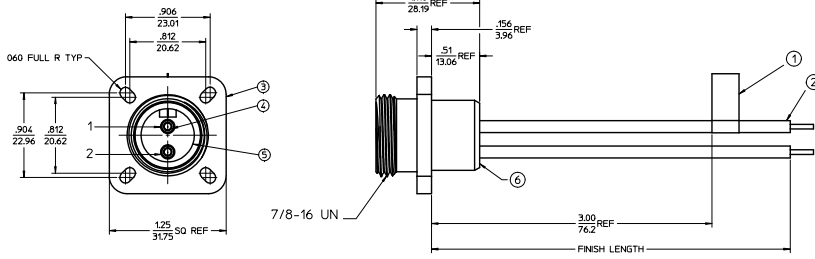
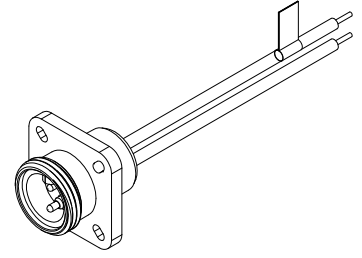

ITEM.	QTY.	COMPONENT	MATERIAL	FINISH
1	1	FLAG LABEL	PLASTIC FILM	BLACK/YELLOW
2	2	CONDUCTOR-16 AWG. 26X+30 COPPER STRANDING 600V	PVC	SEE WIRING DIAGRAM
3	1	RECEPTACLE SHELL	ALUMINUM	ANODIZED
4	2	CONTACT PIN	COPPER ALLOY	GOLD PLATED
5	1	2 POLE INSERT	PVC	YELLOW
6	1	POTTING	EPOXY	BLACK

CREATE DOC EC NO. WA2200-0423 DRAWN BY RUPERT 2010/01/08 CHECKED BY WOODMAN 2010/01/14 APPROVED BY JFMURPHY 2010/01/14 DATE	QUALITY SYMBOLS 0 0	GENERAL TOLERANCES (UNLESS SPECIFIED): 4 PLACES ±.005 INCH 3 PLACES ±.005 INCH 2 PLACES ±0.013 INCH 1 PLACE ±.005 INCH ANGULAR ±1/2°	DIMENSION STYLE IN/MM	SCALE 2:1	DESIGN UNITS INCH	THIRD ANGLE PROJECTION	
	DRAWN BY RUPERT	DATE 01/07/2010	TITLE MALE FLANGE RECEPTACLE MINI-CHANGE 2P 16AWG PVC				
	CHECKED BY WOODMAN	DATE 01/07/2010	APPROVED BY JFMURPHY	DATE 2010/01/14	MATERIAL NO. SEE CHART	DOCUMENT NO. SD-130013-015	SHEET NO. 1 OF 1
	DRAFT WHERE APPLICABLE MUST REMAIN WITHIN DIMENSIONS						

MOLEX INCORPORATED

THIS DRAWING CONTAINS INFORMATION THAT IS PROPRIETARY TO MOLEX INCORPORATED AND SHOULD NOT BE USED WITHOUT WRITTEN PERMISSION