

Excellent Integrated System Limited

Stocking Distributor

Click to view price, real time Inventory, Delivery & Lifecycle Information:

[E-Switch](#)
[100SP5T1B1M2REH](#)

For any questions, you can email us directly:

sales@integrated-circuit.com

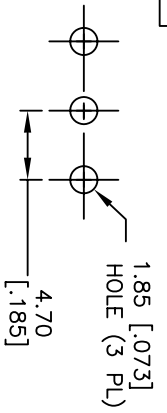

RECOMMENDED P.C.B. LAYOUT

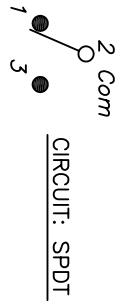

SWITCH FUNCTION		
POS. 1	POS. 2	POS. 3
2-3	OPEN	2-1

<DN>=MOMENTARY

NOTES:

1. ALL DIMENSIONS IN MM. [INCH]
2. GENERAL TOLERANCE: X.XX=±0.4 X.XX=±0.25
3. TERM. NOS. FOR REF. ONLY
4. RATING: 0.4V @20V AC or DC max.
5. FIXED TERMINAL/MOVING CONTACT:
Copper Alloy w/GOLD Plate over Nickel plate.
6. ELECTRICAL LIFE: 50,000 make-and-break cycles at full load.
7. INSULATION RESISTANCE: 1,000M ohm min.
8. DIELECTRIC STRENGTH: 1000V RMS @sea level
9. OPERATING TEMP.: -30°C to +85°C
10. ▲ DENOTES CRITICAL PARAMETER.
11. HARDWARE TO BE SHIPPED BULK:
T100000 - HEXNUT - QTY 2
T100011 - LOCKWASHER - QTY 1
T100015 - LOCKRING - QTY 1

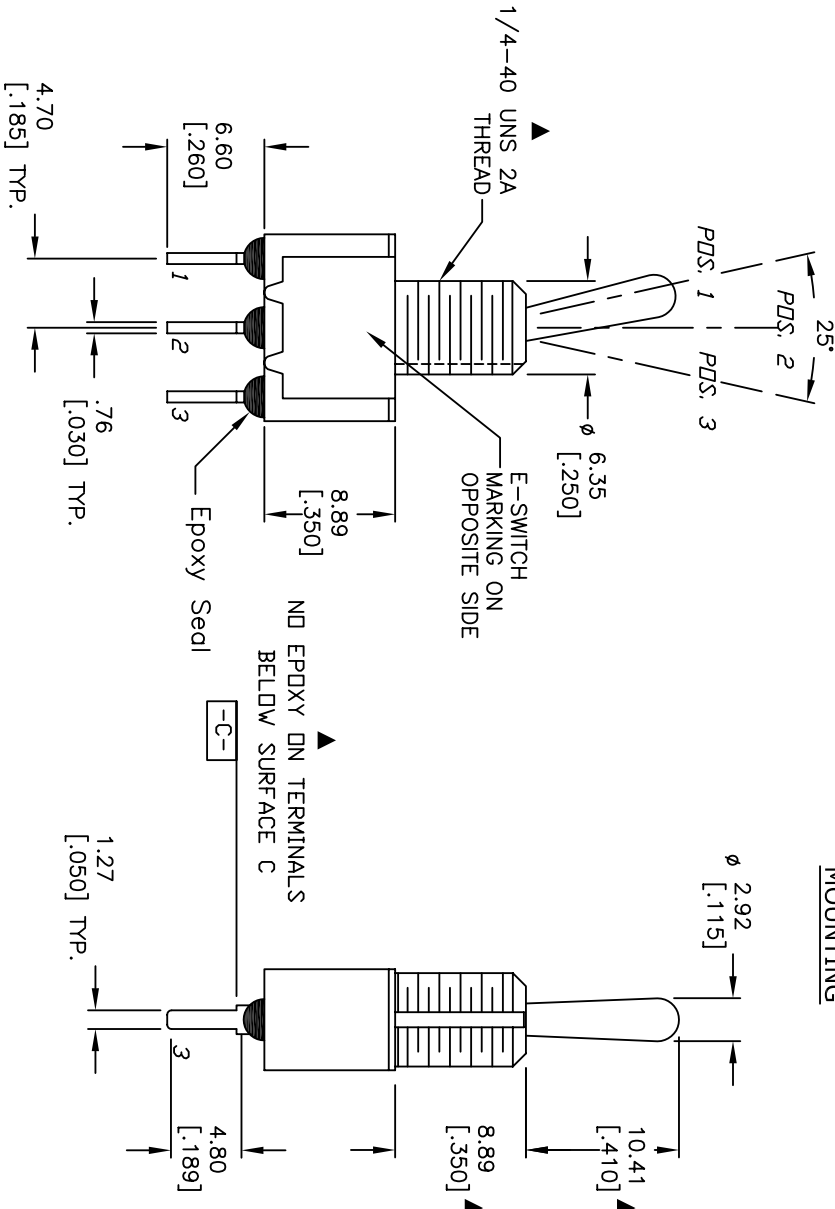
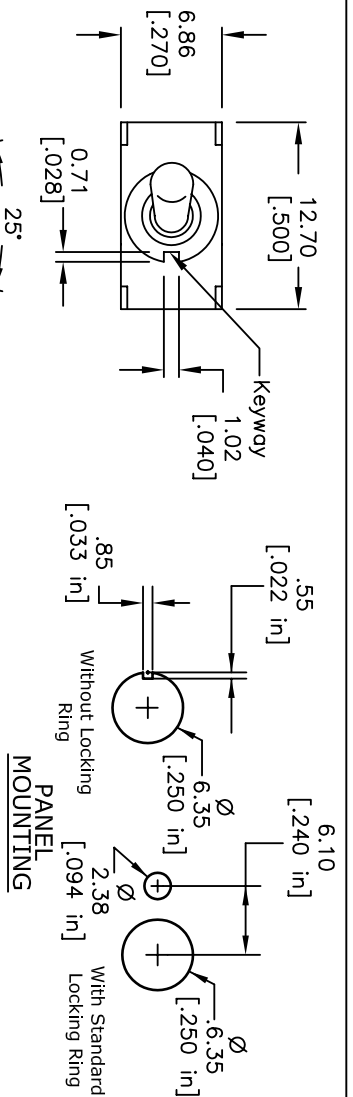

REV. A	18436	RELEASE FOR PRODUCTION	3/17/09	BLR	TITLE	SCALE	DATE	DR	DWG	REV
	PCR No.	DESCRIPTION	DATE	CHKD	100SP5T1B1M2REH	2:1	2/17/09	BLR	ST115006	A
<p>THE INFORMATION CONTAINED IN THIS DOCUMENT IS PROPRIETARY TO E-SWITCH AND IS NOT TO BE COPIED OR TRANSFERRED</p>										