

Excellent Integrated System Limited

Stocking Distributor

Click to view price, real time Inventory, Delivery & Lifecycle Information:

[Knowles](#)

[CI-30050-000](#)

For any questions, you can email us directly:

sales@integrated-circuit.com

CI-30050-000
SHT 1.1

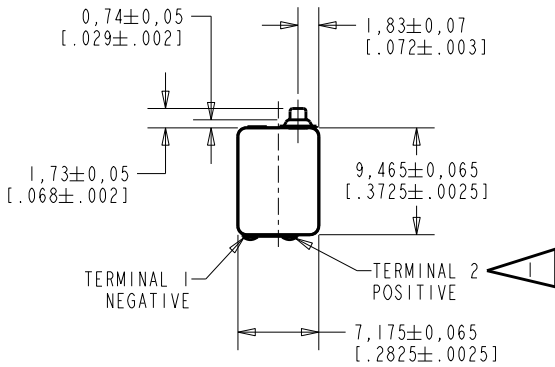

NOTES:

▲ A POSITIVE GOING VOLTAGE AT TERMINAL 2, RELATIVE TO TERMINAL 1, CAUSES A DECREASE IN PRESSURE AT THE SOUND OUTLET.

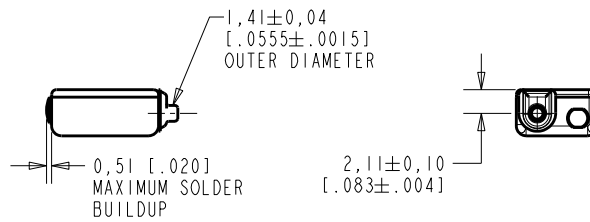
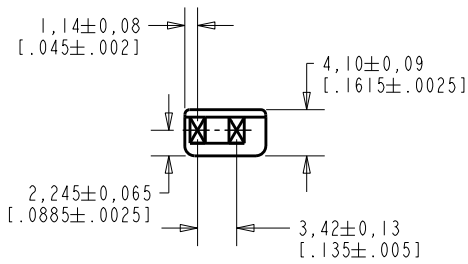

DIMENSIONS IN MILLIMETERS [INCHES]

Revision	C.O. #	Implementation Date	RELEASE LEVEL	REVISION
B	CI0111948	12-31-10	Active	B
A	CI0104716	9-13-06		
SCALE: 2:1			DR. BY	DATE
DO NOT SCALE DRAWING			SDZ	9-13-06
TITLE: RECEIVER			CK. BY	DATE
OUTLINE DRAWING			GJP	9-29-06
CI-30050-000			APP. BY	DATE
SHT 1.1			GJP	9-29-06

KNOWLES ELECTRONICS
ITASCA, ILLINOIS U.S.A.

NO DAMPING

CI-30050-000
SHEET 2.1

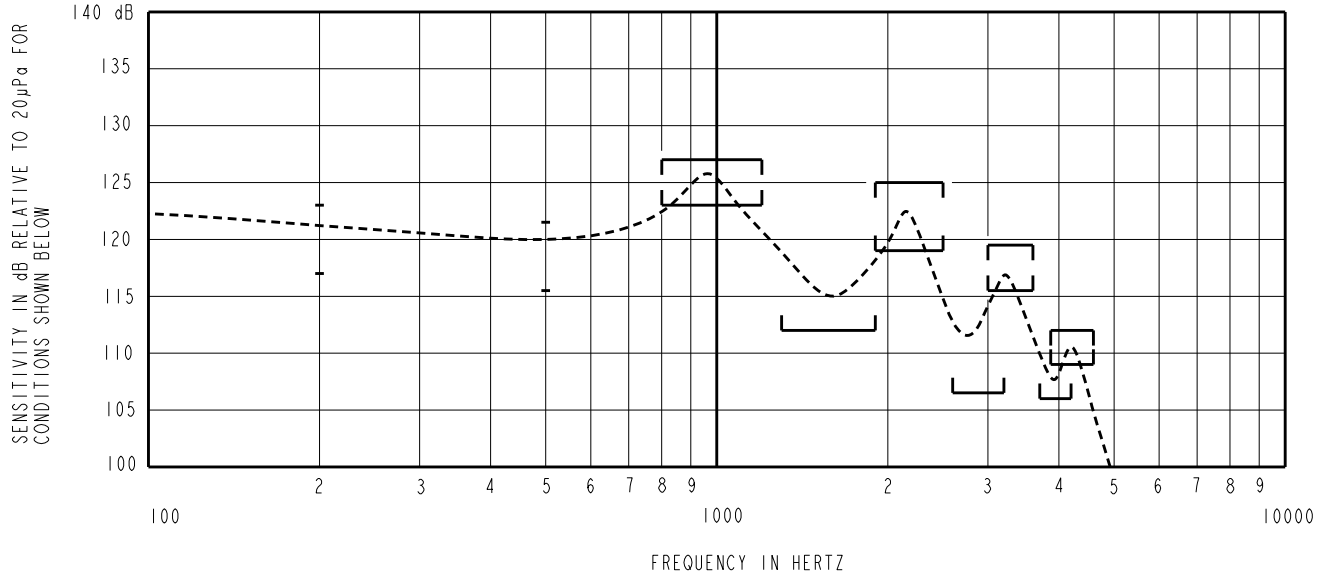

ACOUSTICAL

SENSITIVITY*
 DEVICE WILL PRODUCE THE SPL LISTED BELOW WITH THE TEST CONDITIONS DESCRIBED IN TABLE 3. NOMINAL SENSITIVITY AT 500 Hz IS dB RELATIVE TO 20µPa. ALL OTHER VALUES IN dB RELATIVE TO THE SENSITIVITY AT 500 Hz.

FREQUENCY (Hz)	MINIMUM	NOMINAL	MAXIMUM
200	-1.5	+1.5	+4.5
500	-3.0	+18.5	+3.0
800-1200 PEAK 1	+4.5	+6.5	+8.5
1300-1900 VALLEY 1	-6.5	---	---
1900-2500 PEAK 2	+0.5	+3.5	+6.5
2600-3200 VALLEY 2	-12.0	---	---
3000-3600 PEAK 3	-3.0	-1.0	+1.0
3700-4200 VALLEY 2	-12.5	---	---
4100-4600 PEAK 4	-9.5	-8.0	-6.5

TABLE 1.

TOTAL HARMONIC DISTORTION*
 DEVICE WILL NOT EXCEED TOTAL HARMONIC DISTORTION LEVELS LISTED BELOW.

FREQUENCY (Hz)	DRIVE (V RMS)	DC BIAS (MA)	LIMIT (%)
350	.148 V	0	5
500	.148 V	0	5
500	.412 V	0	10

TABLE 2.

TEST CONDITIONS

NOMINAL SOURCE VOLTAGE	.148 Vrms, 0 Vdc BIAS
SOURCE IMPEDANCE	< 1 Ω
TUBING	8 mm (.315) LONG X 1 mm (.039) ID 28 mm (1.10) LONG X 1.5 mm (.059) ID 25 mm (.984) LONG X 2 mm (.079) ID 18 mm (.710) LONG X 3 mm (.118) ID
COUPLER CAVITY	2 CC SIMULATED ANSI S3.6 TYPE HA-3 (IEC 60318-5)

TABLE 3.

ELECTRICAL

DC RESISTANCE	9.2Ω ±10%
IMPEDANCE @ 500Hz	25Ω ±20%

TABLE 4.

ISOLATION: THE CASE WILL BE ELECTRICALLY ISOLATED FROM THE COIL CIRCUIT*

MECHANICAL

PORT LOCATION: IS

SOLDER TYPE: SAC305 (LEAD FREE)

TEMPERATURE

OPERATING: SENSITIVITY WILL NOT VARY MORE THAN +1/-3 dB FROM -17°C TO 63°C

STORAGE: -40°C TO 63°C

MECHANICAL SHOCK

LEAK TEST AFTER AGING (NO LEAK AFTER ANY OF THE ABOVE TESTS)