

## Excellent Integrated System Limited

Stocking Distributor

Click to view price, real time Inventory, Delivery & Lifecycle Information:

[Molex Connector Corporation](#)

[15-05-7011](#)

For any questions, you can email us directly:

[sales@integrated-circuit.com](mailto:sales@integrated-circuit.com)

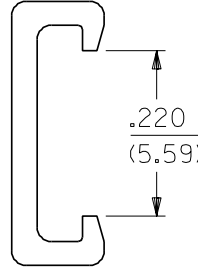
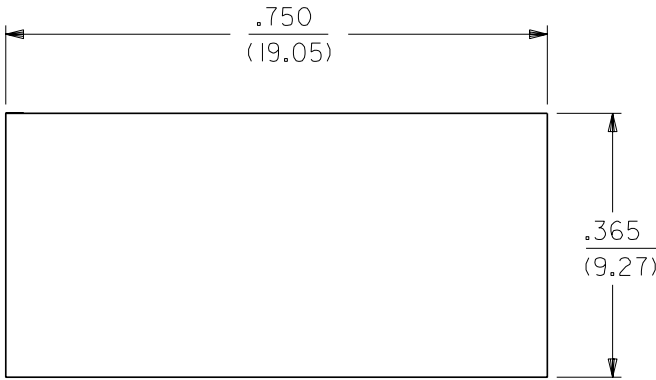

NOTES:

- 1) MATERIAL: POLYESTER. 94V-0
- 2) PS-70156-\*\*\*\* APPLIES

C	TRANSFER TO INDIA ECN UDT1999-0929 SCHAFFER 99/04/30
B2	ADDED PART NO. PER ECN U6-0935 02/08/96 DRS
B1	REVISED NOTES PER ECN U2-0580 10/26/92 DRS
B	REVISED AND REDRAWN PER ECR NO. 8966 01/21/87 SEC

MFG.	SH.	REV.	LTR.	REVISIONS
------	-----	------	------	-----------

PART NUMBER	ENG. NUMBER	COLOR
15-05-7011	70156-3000	BLACK
15-05-7015	70156-3001	WHITE

DIMENSIONS SHOWN (METRIC) INCH		
UNLESS OTHERWISE SPECIFIED TOLERANCES: ANGULAR ± 1/2°		
	INCH	METRIC
3 PLACE	± ---	---
2 PLACE	± ---	± ---
1 PLACE	---	± ---
DRAFT WHERE APPLICABLE MUST REMAIN WITHIN DIMENSIONS		
DRWG. BY	SEC	CHK'D. BY
APP'D. BY		KWS
		SCALE 5 : 1

▽ = 0	▼ = 0	REVISE ONLY ON CAD SYSTEM
TITLE COVER FEED-THRU STYLE FOR 70156 & 71156 ASSEMBLIES		
<b>molex</b>	<b>MOLEX INCORPORATED</b>	SHEET NO. 1 OF 1
LISLE,ILL. 60532 U.S.A.		DATE 01/21/87
PART NO. SEE CHART	DRWG. NO. SD-70156-3000	
FILE NAME SD70156X3 DGN	THIS DRAWING CONTAINS INFORMATION THAT IS PROPRIETARY TO MOLEX INC. AND SHOULD NOT BE USED WITHOUT WRITTEN PERMISSION.	
	DIV. CD	SIZE A

6 5 4 3 2 1