

## Excellent Integrated System Limited

Stocking Distributor

Click to view price, real time Inventory, Delivery & Lifecycle Information:

[Molex Connector Corporation](#)

[22-04-1081](#)

For any questions, you can email us directly:

[sales@integrated-circuit.com](mailto:sales@integrated-circuit.com)

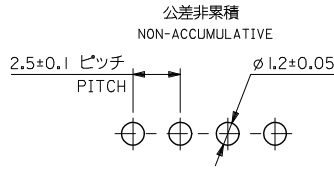
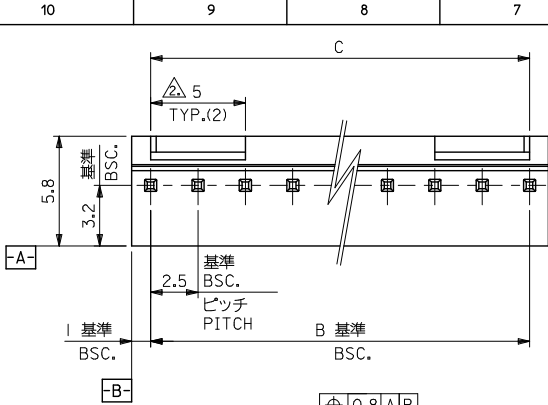

基板取付穴推奨寸法  
RECOMMENDED P.C.BOARD HOLE DIM.

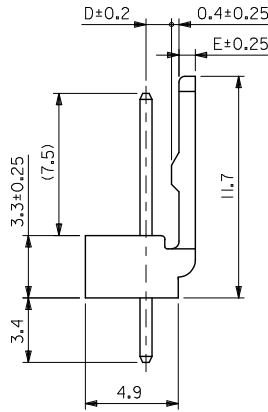
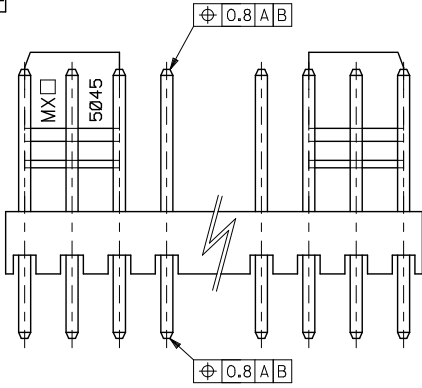

注) NOTE.

1. 材料

MATERIAL

ピン : 0.635x14.2 黄銅、銅下地銀メッキ  
ウエハー: ポリアミド, UL94V-0  
WAFFER: POLYAMIDE, UL94V-0

△ 6種以上に適用

TO BE APPLIED FOR 6 CKT. AND MORE THEN 6 CKT.

3. 5種以下はロック部スリットなし

NO SLIT IS PROVIDED FOR 5 CKT. AND LESS THAN 5 CKT.

4. ELV 及び RoHS 適合品

ELV AND RoHS COMPLIANT

1.35	0.85	47.5 <sup>+0.1</sup> <sub>-0.25</sub>	47.5	22 04 1201	20
		45 <sup>+0.1</sup> <sub>-0.25</sub>	45	↑ 1191	19
		42.5 <sup>+0.1</sup> <sub>-0.25</sub>	42.5	1181	18
		40 <sup>+0.1</sup> <sub>-0.25</sub>	40	1171	17
		37.5 <sup>+0.1</sup> <sub>-0.25</sub>	37.5	1161	16
		35 <sup>+0.1</sup> <sub>-0.25</sub>	35	1151	15
		32.5 <sup>+0.1</sup> <sub>-0.25</sub>	32.5	1141	14
		30 <sup>+0.1</sup> <sub>-0.25</sub>	30	1131	13
		27.5 <sup>+0.1</sup> <sub>-0.25</sub>	27.5	1121	12
		25 <sup>+0.1</sup> <sub>-0.25</sub>	25	1111	11
		22.5 <sup>+0.1</sup> <sub>-0.25</sub>	22.5	1101	10
		20 <sup>+0.1</sup> <sub>-0.25</sub>	20	1091	9
		17.5 <sup>+0.1</sup> <sub>-0.25</sub>	17.5	1081	8
		15 <sup>+0.1</sup> <sub>-0.25</sub>	15	1071	7
		12.5 <sup>+0.1</sup> <sub>-0.25</sub>	12.5	1061	6
		10 <sup>+0.1</sup> <sub>-0.25</sub>	10	1051	5
1.35	0.85	7.5 <sup>+0.1</sup> <sub>-0.25</sub>	7.5	1041	4
1.2	1	5 <sup>+0.1</sup> <sub>-0.25</sub>	5	1031	3
1.2	1	2.5 <sup>+0.1</sup> <sub>-0.25</sub>	2.5	22 04 1021	2
D	E	C	B	ORDER No. 極数 CKT.	

REVISED EC NO. J2012-0973 DRAWN BY 2012/01/30 CHIKIDAKAWA APPROXIMATE 2013/06/13	GENERAL TOLERANCES (UNLESS SPECIFIED)		DIMENSION STYLE	SCALE	DESIGN UNITS	THIRD ANGLE PROJECTION	
			MM ONLY	5:1	METRIC		
	DESCRIPTION	10 UNDER	± 0.4	DRAWN BY	DATE	TITLE	KK 2.5 WAFER ASS'Y WITH LOCK
		10 OVER 30 UNDER	± 0.45	K. KOHAMA	2000/03/28		
		30 OVER	± 0.5	T. YAMAGUCHI	2000/03/30		
	ANGULAR	± 3 °	APPROVED BY	DATE			
	DRAFT WHERE APPLICABLE MUST REMAIN WITHIN DIMENSIONS		MATERIAL NO.	DOCUMENT NO.		SHEET NO.	
			SEE CHART		SD-5045-NA	1 OF 1	
	THIS DRAWING CONTAINS INFORMATION THAT IS PROPRIETARY TO MOLEX INCORPORATED AND SHOULD NOT BE USED WITHOUT WRITTEN PERMISSION						