

Excellent Integrated System Limited

Stocking Distributor

Click to view price, real time Inventory, Delivery & Lifecycle Information:

[Molex Connector Corporation](#)
[0190690091](#)

For any questions, you can email us directly:

sales@integrated-circuit.com

10	9	8	7	6	5	4	3	2	19069
MATERIAL NO. LOOSE PIECE	ENG. NO.	MATERIAL NO. TAPE MOUNTED	ENG. NO.	STUD SIZE	±.003 "S"	"W" MAX.	"C" MIN.	"L" MAX.	
190690091	BB-118-10	-----	-----	10	.198 (5.03)	.544 (13.82)	.535 (13.59)	1.010 (25.65)	
190690092	BB-118-14	190690133	BB-118-14T	14	.265 (6.73)				
190690093	BB-118-38	190690094	BB-118-38T	38 (A)	.390 (9.91)				
190690096	BB-118-56	190690097	BB-118-56T	56 (A)	.328 (8.33)				
190690098	BB-123-02	190690134	BB-123-02T	2	.094 (2.39)	.260 (6.60)	.209 (5.31)	.560 (14.22)	
190690099	BB-123-04	190690100	BB-123-04T	4	.119 (3.02)				
190690101	BB-123-06	190690102	BB-123-06T	6	.146 (3.71)				
190690103	BB-123-08	190690104	BB-123-08T	8	.173 (4.39)				
190690105	BB-125-10	190690106	BB-125-10T	10	.198 (5.03)	.477 (12.11)	.388 (9.86)	.837 (21.26)	
190690107	BB-125-14	190690108	BB-125-14T	14	.265 (6.73)				
190690109	BB-125-56	190690110	BB-125-56T	56	.328 (8.33)				
190690112	BB-137-06	190690113	BB-137-06T	6	.146 (3.71)				
190690114	BB-137-08	190690115	BB-137-08T	8	.173 (4.39)	.322 (8.18)	.275 (6.98)	.645 (16.38)	
190690116	BB-137-10	190690117	BB-137-10T	10	.198 (5.03)				
190690119	BB-139-04	-----	-----	4	.119 (3.02)				
190690120	BB-139-06	190690138	BB-139-06T	6	.146 (3.71)				
190690121	BB-139-08	190690122	BB-139-08T	8	.173 (4.39)	.352 (8.94)	.305 (7.75)	.696 (17.68)	
190690123	BB-139-10	190690124	BB-139-10T	10	.198 (5.03)				

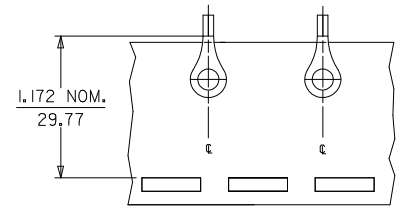

ENG. NO.
BB-118-**-** ONLY

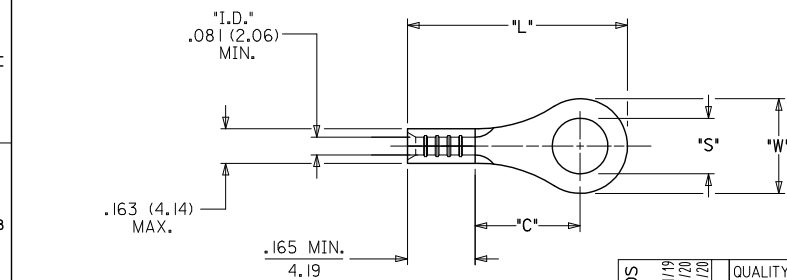
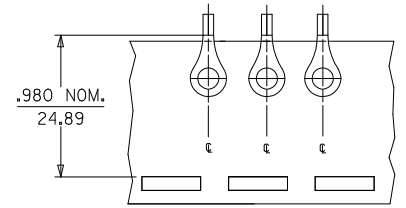

SALES DRAWING

- NOTE(S):
- MATERIAL: COPPER (.031/0.79 THICK) PLATING: ELECTROPLATE TIN
 - WIRE SIZE: 16-14 AWG²
1.0 - 2.5 MM
 - (A) 3. PARTS ARE ROHS COMPLIANT.

FIX SWAPPED STUDS EC NO: WNA2009-0338 DRAWN BY: DOROTHY DAHL 2008/11/19 CHKD: JACQUEL 2008/11/20 APPR: JACQUEL 2008/11/20 REV: A1	QUALITY SYMBOLS	GENERAL TOLERANCES (UNLESS SPECIFIED) <table border="1"> <tr> <th></th> <th>mm</th> <th>INCH</th> </tr> <tr> <td>4 PLACES</td> <td>± .005</td> <td>± .0005</td> </tr> <tr> <td>3 PLACES</td> <td>± .013</td> <td>± .005</td> </tr> <tr> <td>2 PLACES</td> <td>± 0.13</td> <td>± .01</td> </tr> <tr> <td>1 PLACE</td> <td>± 0.25</td> <td>± .01</td> </tr> <tr> <td colspan="3">ANGULAR ± .005°</td> </tr> </table>		mm	INCH	4 PLACES	± .005	± .0005	3 PLACES	± .013	± .005	2 PLACES	± 0.13	± .01	1 PLACE	± 0.25	± .01	ANGULAR ± .005°			DIMENSION STYLE	SCALE	DESIGN UNITS	THIRD ANGLE PROJECTION
			mm	INCH																				
	4 PLACES		± .005	± .0005																				
	3 PLACES		± .013	± .005																				
2 PLACES	± 0.13	± .01																						
1 PLACE	± 0.25	± .01																						
ANGULAR ± .005°																								
	IN/MM	---	INCH																					
	DRAWN BY: DLM	DATE: 2003/02/21	TITLE: RING TONGUE TERMINAL KRIMPTITE 16-14 AWG	MOLEX INCORPORATED DOCUMENT NO. SD-19069-013 SHEET NO. 1 OF 1																				
	CHECKED BY: SB	DATE: 2003/02/21																						
	APPROVED BY: RWD	DATE: 2003/02/21	MATERIAL NO. SEE CHART	THIS DRAWING CONTAINS INFORMATION THAT IS PROPRIETARY TO MOLEX INCORPORATED AND SHOULD NOT BE USED WITHOUT WRITTEN PERMISSION																				