

## Excellent Integrated System Limited

Stocking Distributor

Click to view price, real time Inventory, Delivery & Lifecycle Information:

[FCI](#)  
[HM2P07PDE320N9](#)

For any questions, you can email us directly:  
[sales@integrated-circuit.com](mailto:sales@integrated-circuit.com)

LOADING PATTERN MATING SIDE

f	0	0	0	0	0	0	0	0	0	0	0	0	0	0	0	0	0	0	0	0
e	4	4	4	4	4	4	4	4	4	4	4	4	4	4	6	5	6	5	6	6
d	4	4	4	4	4	4	4	4	4	4	4	4	4	4	6	5	6	5	6	6
c	4	4	4	4	4	4	4	4	4	4	4	4	4	4	6	5	6	5	6	6
b	4	4	4	4	4	4	4	4	4	4	4	4	4	4	6	5	6	5	6	6
a	4	4	4	4	4	4	4	4	4	4	4	4	4	4	6	5	6	5	6	6
z	0	0	0	0	0	0	0	0	0	0	0	0	0	0	0	0	0	0	0	0
p	0	5	0																	
s	1																			

LOADED CONNECTOR ASSEMBLY (FOR EXAMPLE)

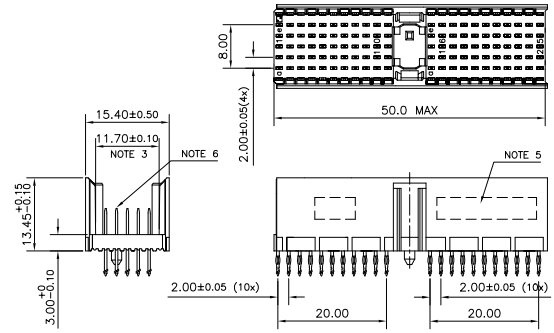

CONTACT OVERVIEW

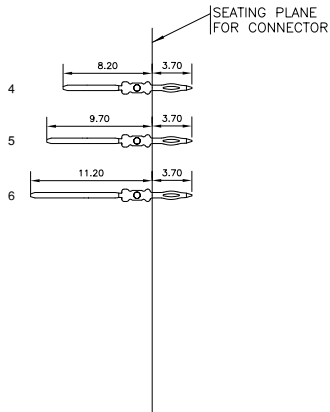

LAY-OUT P.C.B.-HOLE

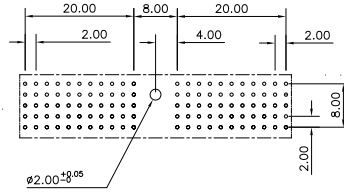

**HM2P07PDE320---** LEAD FREE INDICATOR : LF = LEAD FREE (DIGIT 15 & 16)

PLATING CODE (DIGIT 13 AND 14)  
(REF DRW NO. BS, C , 201844 , 003)

**NOTES**

- THIS PRODUCT IS CSA APPROVED.
- THIS PRODUCT IS UL RECOGNIZED.
- MEASURED AT THE BOTTOM.
- MATERIAL CONTACT: PHOSPHORBRONZE  
HOUSING: CREAM WHITE GLASS FILLED POLYESTER UL-94V0
- CONNECTOR PRINTED WITH P/N AND DATE CODE.
- FOR ACTUAL CONTACT LOADINGS, SEE LOADING PATTERN MATING SIDE.
- SHAPE OF CONNECTOR HOUSING CAN ALTER DEPENDING ON PRODUCTION LOCATION
- THE PRODUCT (LF) MEETS EUROPEAN UNION DIRECTIVES AND OTHER COUNTRY REGULATIONS AS DESCRIBED IN GS-22-008
- FOR RECOMMENDED PTH DIMENSIONS REFER DRAWING : BS, A , 201572 , 001 CATALOG NO: HM2P07PDE320----

mat'l. code	SEE NOTE 4			surface	tolerance	projection	product family
ltr	ecn no	dr	date	ISO 1302	ISO 406 ISO 1101	⊕	MILLIPACS
A	ID4-0027	MINI	2004/04/07	tolerances unless otherwise specified		MM	title
B	ID5-0188	MINI	2005/10/13	angles	0±0.2		<b>MPACS 5+2R STR HDR PF CONN TYPE A</b>
C	ID6-0090	MINI	2006/06/27	linear	00±0.1	scale	
		dr	MINI K. VANDANATH	0°±1"			dwg no
		enrg	BIJU K. PAUL				sheet 1 of 1
		chr	BIJU K. PAUL				BS, C , 203028, 126
		appd	BIJU K. PAUL				A3
sheet	revision						
index	sheet	c	1				