

Excellent Integrated System Limited

Stocking Distributor

Click to view price, real time Inventory, Delivery & Lifecycle Information:

[FCI](#)
[HM2P09PKJ3T5GFLF](#)

For any questions, you can email us directly:
sales@integrated-circuit.com

LOADING PATTERN MATING SIDE

f	6	6	6	6	6	0	K	K	K
e	4	4	4	4	4	0	7	7	7
d	4	4	4	4	4	0	7	7	7
c	4	4	4	4	4	0	7	7	7
b	4	4	4	4	4	0	7	7	7
a	4	4	4	4	4	0	7	7	7
z	6	6	6	6	6	0	K	K	K
P	0								
S	1								
		0	5						
				1	0				

LOADED CONNECTOR ASSEMBLY
(FOR EXAMPLE)

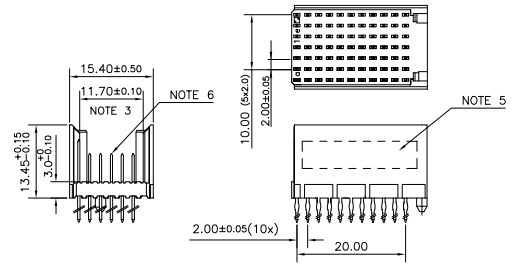

CONTACT OVERVIEW

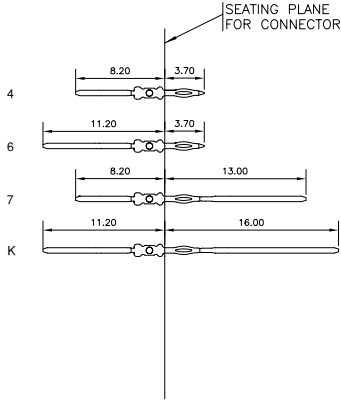

LAY-OUT P.C.B.-HOLE

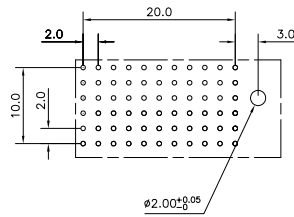

HM2P09PKJ3T5 --- LEAD FREE INDICATOR : LF = LEAD FREE (DIGIT 15 & 16)
PLATING CODE (DIGIT 13 AND 14) (REF DRW NO. BS.C , 201844 , 003)

NOTES

- THIS PRODUCT IS CSA APPROVED.
 - THIS PRODUCT IS UL RECOGNIZED.
 - MEASURED AT THE BOTTOM.
 - MATERIAL CONTACT: PHOSPHORBRONZE
HOUSING: CREAM WHITE GLASS FILLED POLYESTER UL-94V0
 - CONNECTOR PRINTED WITH P/N AND DATE CODE.
 - FOR ACTUAL CONTACT LOADINGS, SEE LOADING PATTERN MATING SIDE.
 - SHAPE OF CONNECTOR HOUSING CAN ALTER DEPENDING ON PRODUCTION LOCATION
 - THE PRODUCT (LF) MEETS EUROPEAN UNION DIRECTIVES AND OTHER COUNTRY REGULATIONS AS DESCRIBED IN GS-22-008
 - FOR RECOMMENDED PTH DIMENSIONS REFER DRAWING : BS, A , 201572 , 001
- CATALOG NO: HM2P09PKJ3T5----

mat'l. code	SEE NOTE 4	surface	ISO 1302	tolerance	ISO 406 ISO 1101	projection	product family	MILLIPACS
ltr	ecn no	dr	date	tolerances unless otherwise specified		MM	title	
A	07-0037	MINI	2007-03-16	angles	0±0.2	MM	MPACS 5+2R STR HDR PF CONN TYPE C	
				linear	00±0.1	scale		
				dr	MINI K VANDANATH	2007-03-16	dwg no	sheet 1 of 1
				enrg	BIJU K PAUL	2007-03-16	BS, C , 203028, 759	size
				chr	BIJU K PAUL	2007-03-16	type	Product Customer Drawing
				appd	BIJU K PAUL	2007-03-16		
sheet index	revision sheet	A	1					