

## Excellent Integrated System Limited

Stocking Distributor

Click to view price, real time Inventory, Delivery & Lifecycle Information:

[Harting](#)  
[09241206579](#)

For any questions, you can email us directly:  
[sales@integrated-circuit.com](mailto:sales@integrated-circuit.com)



# DIN 41 612 · complementary type 3B

Number of contacts

# 20

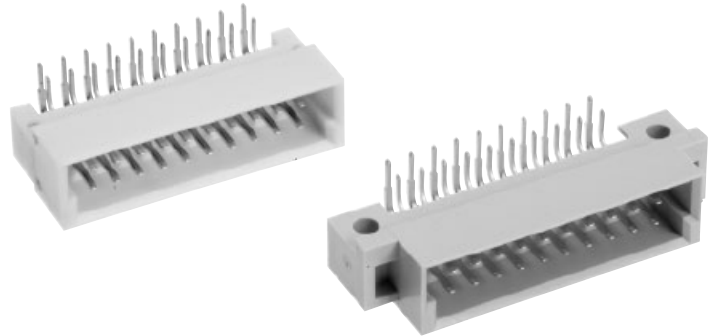

Male connectors

Identification	Number of contacts	Contact arrangement	Part No.	Performance levels according to IEC 60 603-2.		
			<b>3</b>	<b>2</b>	<b>1</b>	
Male connector with angled solder pins with fixing flange	20		Performance level 3 on request	09 24 120 6921 09 24 320 6921 <sup>b)</sup>		
with fixing flange, SMC	20			09 24 120 6919 <sup>d)</sup>		
without fixing flange	20			09 24 120 6571	Performance level 1 on request	
without fixing flange, SMC	20			09 24 120 6579 <sup>d)</sup>		
Male connector with straight solder pins with fixing flange	20			09 24 120 6922		

## Dimensions

with fixing flange      without fixing flange

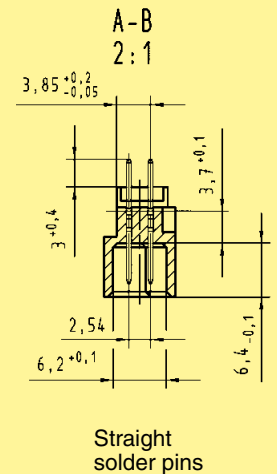
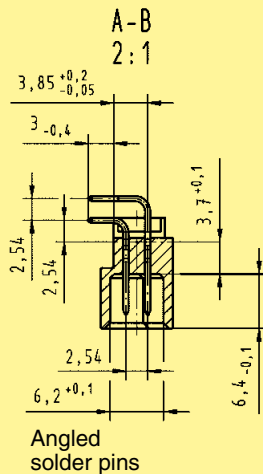
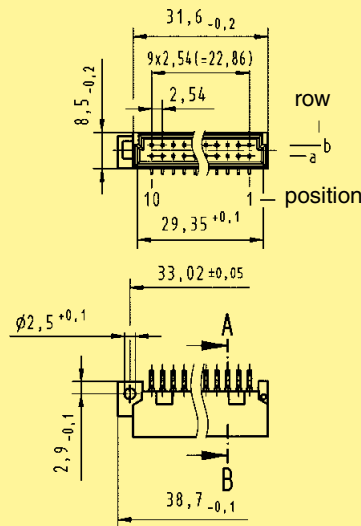

## Board drillings

Mounting side

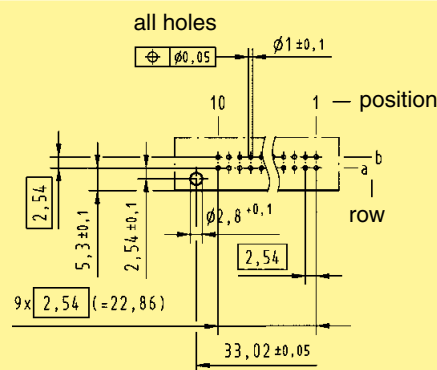

## Cross section of solder terminations

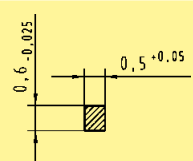

Cross area (A) of contacts  
row a, b: A = 0.29 - 0.33 mm<sup>2</sup>

Dimensions in mm

DIN Signal up to 2 A