

Excellent Integrated System Limited

Stocking Distributor

Click to view price, real time Inventory, Delivery & Lifecycle Information:

[Harting](#)
[09060006451](#)

For any questions, you can email us directly:
sales@integrated-circuit.com

Alle Rechte vorbehalten. All rights reserved.

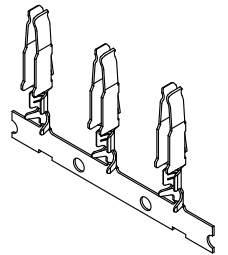
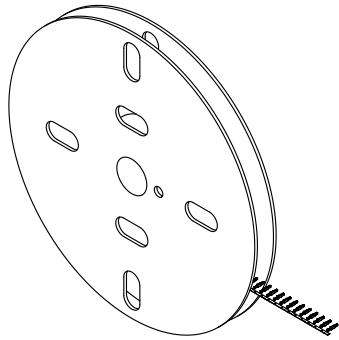
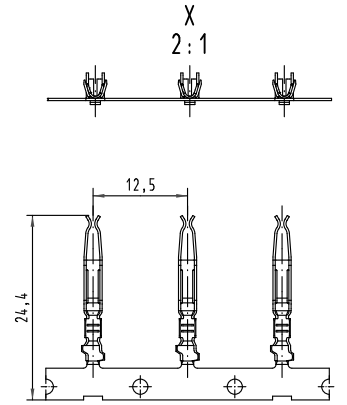
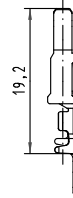
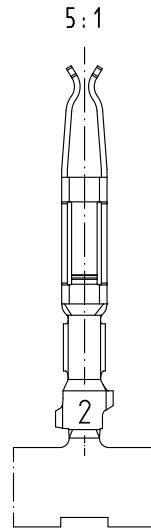
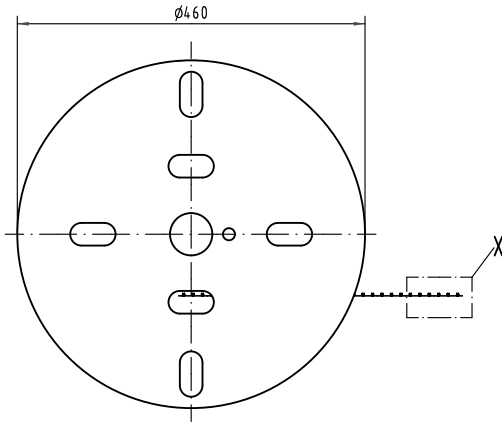
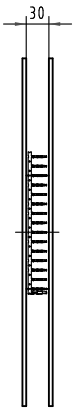

All Dimensions in mm Original Size DIN A 3			Techn. Character. Det. Name Detail: 16.01.06 LeH. Insp. 16.01.06 kFoe Stand.			Nicht tolerierte Maß/Free size tolerances <i>complementary IEC 60603-2</i> Bauform/Type F-C modul Federkontakt Crimpkontakt 2 für 0,14 - 0,56mm ² 2500 Kontakte auf Haspel verzinkt female contact crimp contour 2 for 0,14 - 0,56mm ² 2500 contacts on reel tin plated		
35449	19.11.08	Hage.	HARTING Electronics GmbH & Co. KG D-32339 ESPELKAMP			TB 09 06 000 6451		
33227								
Mod.	Dat.	Name	Sub.					