



Distributor of Harting: Excellent Integrated System Limited

Datasheet of 09641247236 - D-Sub Connector Plug, Male Pins 9 Position Through Hole, Right Angle Solder

Contact us: sales@integrated-circuit.com Website: www.integrated-circuit.com

Excellent Integrated System Limited

Stocking Distributor

Click to view price, real time Inventory, Delivery & Lifecycle Information:

[Harting](#)

[09641247236](#)

For any questions, you can email us directly:

sales@integrated-circuit.com

Contact us: sales@integrated-circuit.com Website: www.integrated-circuit.com

D

C

B

A

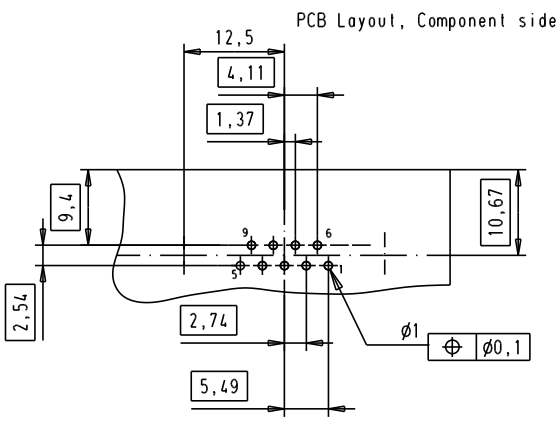
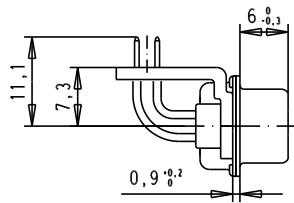
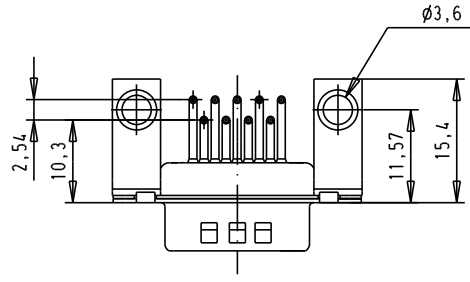
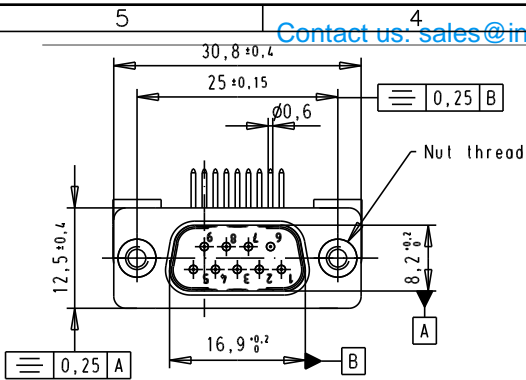

SPECIFICATION

Mating Cycles	500
Filter type	C
Capacitance	1000pf±20%
Working Voltage	100v
Current rating	7,5A
Insulation Resistance	>1GΩ

Minimum Insertion Loss

FREQUENCY (MHz)	ATTENUATION dB
5	1dB
10	3dB
50	12dB
100	20dB
500	34dB
1000	30dB

09641247237	M3
09641247236	4-40UNC-2B
Part number	Nut thread

31864	23/01/04	AF
31058	8-JUL-02	CV
Mod.	Dat.	Name

Detail.	8-JUL-02	Name	CV
Insp.			
Stand.			
HARTING EURL F-95972 Paris			

All Dim. in mm
Orig. Size DIN A 4

D-Sub, male, angled, 9 Poles, turned solder pin in plated shell and metal bracket with nut

TB 0964124723x

Mo?/Lab/
Scale
1.5:1

Blatt/ Page
3 / 4