



## Excellent Integrated System Limited

Stocking Distributor

Click to view price, real time Inventory, Delivery & Lifecycle Information:

[Panasonic Electronic Components](#)

[LNJ411K84RU](#)

For any questions, you can email us directly:

[sales@integrated-circuit.com](mailto:sales@integrated-circuit.com)

Approved	Checked	Designed	DEVELOPMENT SPECIFICATION					
<i>T. Shoda</i>	<i>M. W. J.</i>	<i>T. Takata</i>	P/N: LNJ411K84RU				TEMPORARY	
T	Y	P	E	Amber Light Emitting Diode				
APPLICATION				Indicators				
MATERIAL				InGaAlP				
OUTLINE				Attached				
ABSOLUTE		P	*I <sub>FP</sub>	I <sub>FDC</sub>	V <sub>R</sub>	Topr	Tslg	
MAXIMUM		55	60	20	4	-30~+85	-40~+100	
RATINGS		mW	mA	mA	V	°C	°C	
CONDITION				Ta=25±3°C				
Test Specification								
Item	Symbol	Condition	Typ	Limit		Unit		
				Min	Max			
Forward Voltage	V <sub>F</sub>	I <sub>F</sub> =10mA	2.0		2.5	V		
Reverse Leakage Current	I <sub>R</sub>	V <sub>R</sub> =4V			100	μA		
Luminous Intensity	I <sub>0</sub>	I <sub>F</sub> =10mA DC	17	9.0		mcd		
Peak Emission Wavelength	λ <sub>p</sub>	I <sub>F</sub> =10mA DC	595			nm		
Spectral Line Half Width	Δλ	I <sub>F</sub> =10mA DC	15			nm		
<p>*1. The Condition of I<sub>FP</sub> is duty 10%. Pulse width 1ms</p> <p>*2. Tolerance of luminous intensity: ±20%.</p>								
NOTE								
<p>★1. Please contact the Panasonic local office if you design at low current (below 1mA DC) or pulse current operation and have any questions.</p> <p>★2. Soldering conditions.....Refer to Handling note.</p> <p>★3. Compositions of the lead ..... Cu/Ni/Au plating</p> <p>★4. Beware of destruction by static electricity in handling the LED.</p> <p>★5. Circuit to operate LED.</p>								
					(A) Recommended circuit.			
					(B) The difference of brightness between the LED could be found due to the V <sub>F</sub> characteristics of each LED.			
Jul. 25, 2001								

Approved	Checked	Designed	DEVELOPMENT SPECIFICATION	TEMPORARY
<i>T. Taketa</i>	<i>M. H.</i>	<i>T. Taketa</i>		

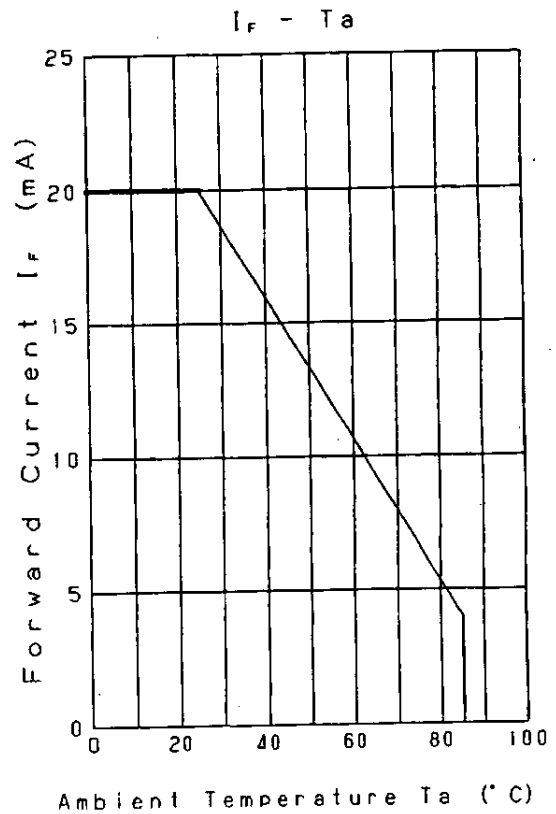
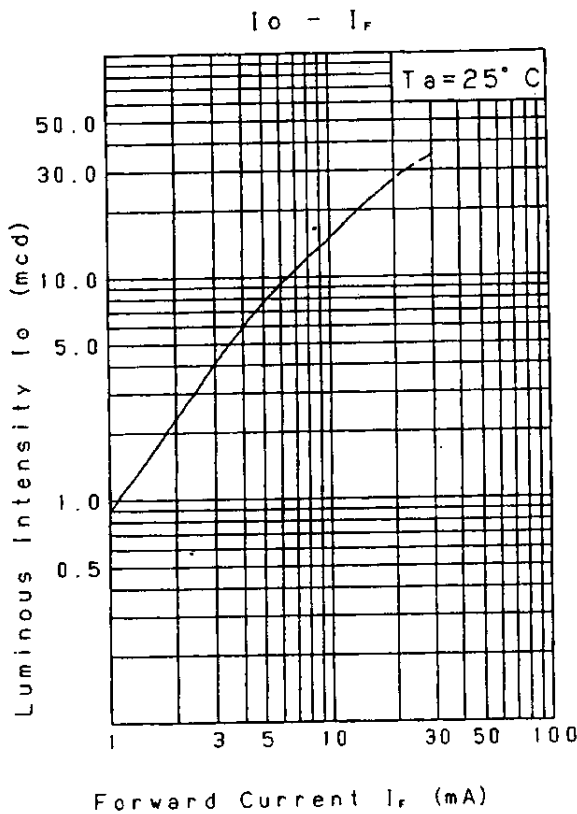
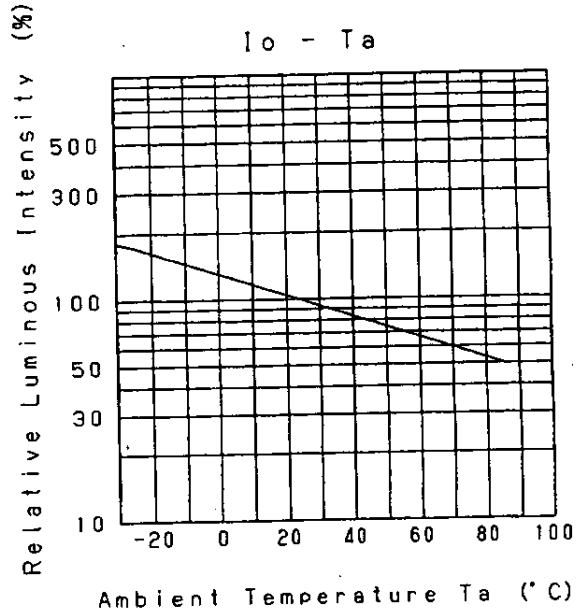
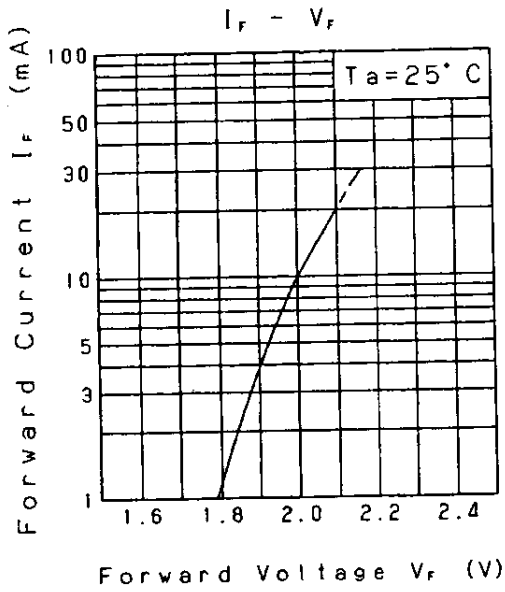

Jul. 25. 2001			
---------------	--	--	--

Approved <i>T. Okada</i>	Checked <i>M. Ito</i>	Designed <i>T. Takata</i>	DEVELOPMENT SPECIFICATION  P/N: LNJ411K84RU	TEMPORARY

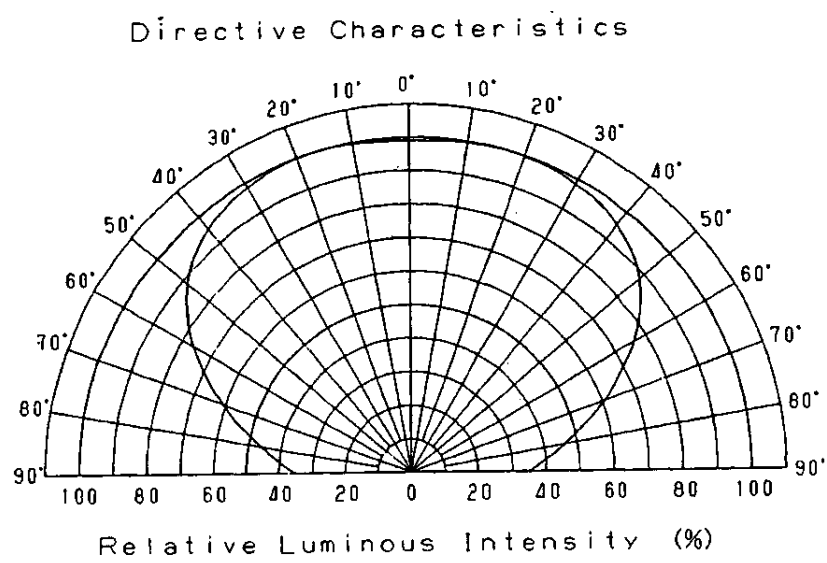
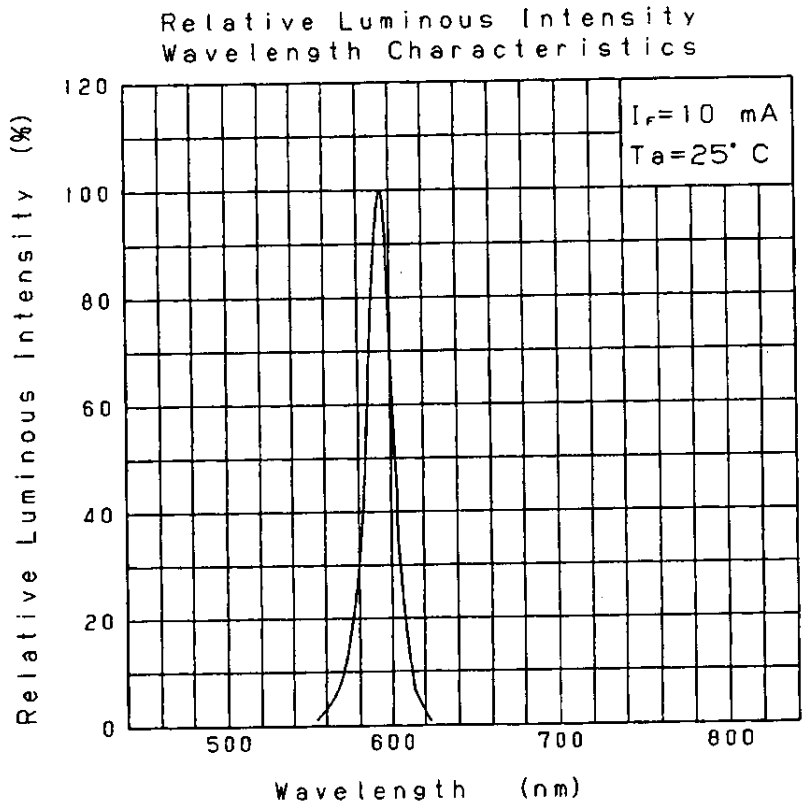

Apr. 20. 2001			
---------------	--	--	--

Approved	Checked	Designed	DEVELOPMENT SPECIFICATION (OUTLINE) P/N: LNJ411K84RU
<i>T. Shoda</i>	<i>M. Kuri</i>	<i>T. Takata</i>	

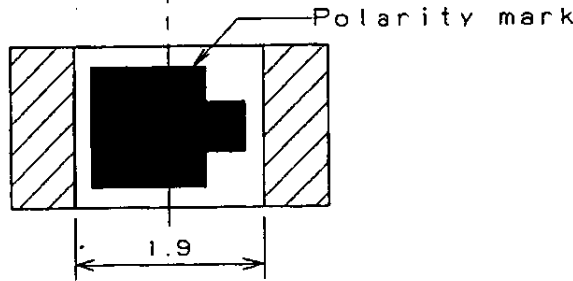
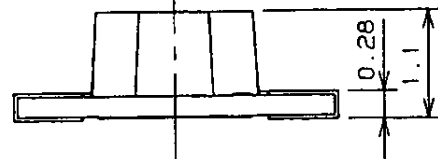
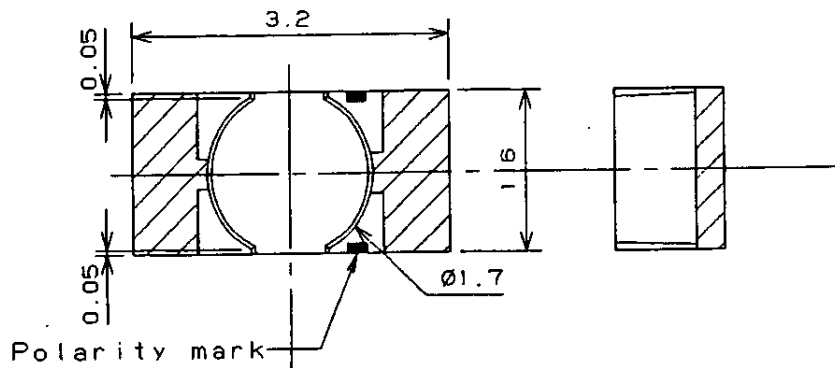

Recommended Land Layout

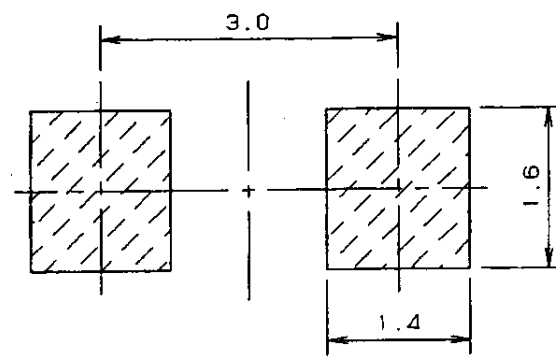

Polarity

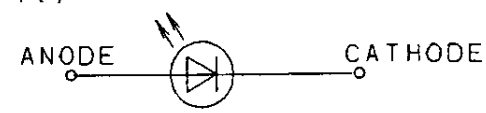

- (NOTE)  
 1. Unit: mm  
 2. Tolerance unless specified is  $\pm 0.15$ .  
 3. indicate Au terminal.

Jul. 25. 2001		
---------------	--	--