

Excellent Integrated System Limited

Stocking Distributor

Click to view price, real time Inventory, Delivery & Lifecycle Information:

[NorComp](#)
[972-009-01S-031](#)

For any questions, you can email us directly:
sales@integrated-circuit.com

DESCRIPTION: 972 SERIES D-SUB SLIM-LINE BACKSHELL

BACKSHELL KIT INCLUDES:

- (1) BACKSHELL
- (2) 4-40 THUMBSCREWS
- (1) PLASTIC STRAIN RELIEF
- (1) METAL STRAIN RELIEF CLAMP
- (2) STRAIN RELIEF SCREWS

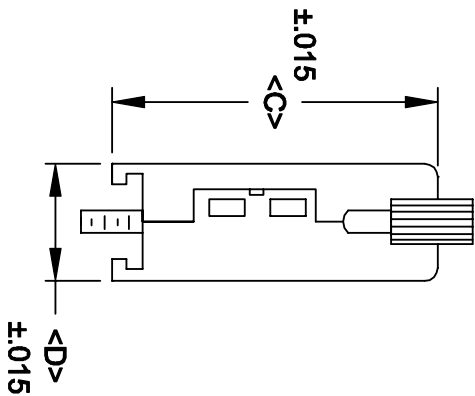
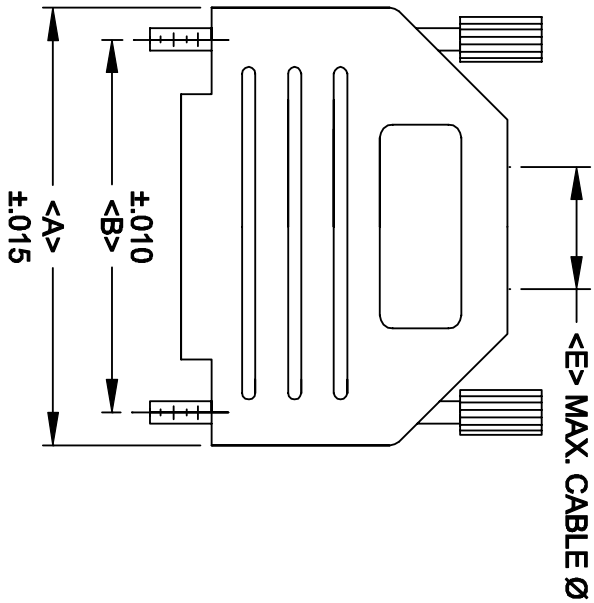

POS.	A B C D E				
	9	1.240	.984	1.339	.591
	31.50	24.99	34.00	15.00	11.50
15	1.575	1.312	1.339	.591	.453
	40.00	33.32	34.00	15.00	11.50
25	2.106	1.852	1.575	.591	.453
	53.50	47.04	40.00	15.00	11.50
37	2.795	2.500	1.575	.591	.453
	71.00	63.50	40.00	15.00	11.50

972-XXX-01S-XX1

SERIES _____

POSITIONS _____

009

015

025

037

MATERIAL _____

01S = PLASTIC/SLIM LINE

COLOR: _____

01 = BLACK

02 = WHITE

03 = GREY

04 = GREEN

05 = BROWN

06 = RED

07 = BLUE

08 = YELLOW

09 = BEIGE

10 = IVORY

11 = DEC GREY

PUT-UPS _____

1 = KIT

MATERIAL: HIGH TEMPERATURE

ABS PLASTIC - U.L.94V-2
MANY COLORS AVAILABLE



THESE DRAWINGS AND SPECIFICATIONS ARE THE PROPERTY OF NorComp AND SHALL NOT BE REPRODUCED, COPIED OR USED AS THE BASIS FOR THE MANUFACTURE OF APPARATUS WITHOUT WRITTEN PERMISSION.

DRAWN: PAM JENKINS
CHECKED: _____
DATE: 12-6-01

SCALE: _____ SHEET 1 OF 1

REV 2

NorComp

DWG NO. 972-XXX-01S-XX1