

Excellent Integrated System Limited

Stocking Distributor

Click to view price, real time Inventory, Delivery & Lifecycle Information:

[FCI](#)
[10039748-001LF](#)

For any questions, you can email us directly:

sales@integrated-circuit.com

PRODUCT NO	DIM L	RECOMMENDED P.C. BOARD THICKNESS
10039748-001LF	2.70	1.57mm (0.062")/2.36mm (0.093")
10039748-002LF	3.60	2.36mm (0.093")

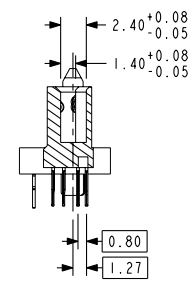
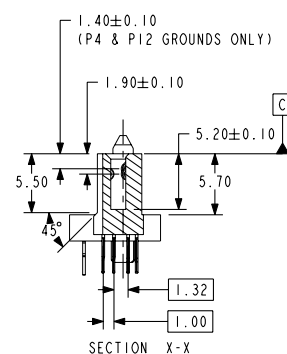
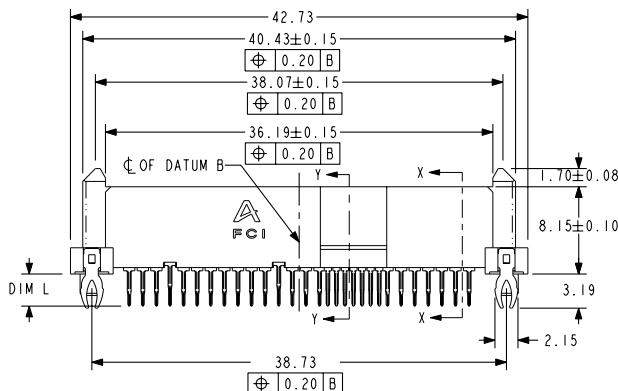
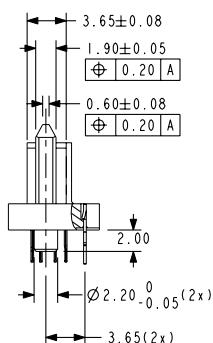
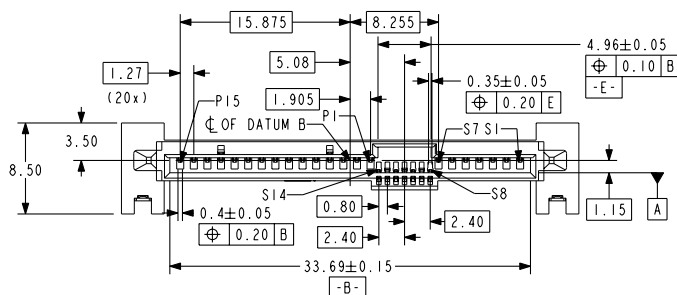

www.fciconnect.com				surface	tolerance	projection	size	scale
Dr	YEO SS	19OCT05	Product family	SAS	±0.20	MM	A4	2:1
Eng	YEO SS	06DEC05	Spec ref		+/- 2°			
Chr	YEO SS	06DEC05	Material				ECN	S05-0360
Appr	JOEY NG	06DEC05						
SAS RECEPTACLE TH (WIDE BASE)				deg no	10039748		Rev. A	
catalog no				CUSTOMER		sheet 1 of 2		

rev	ecn no	dr	date
A	S05-0360	YSS	06DEC05
-	-	-	-
-	-	-	-
-	-	-	-
-	-	-	-
-	-	-	-

PDM: Rev:A

STATUS:Released

Printed: Dec 01, 2010

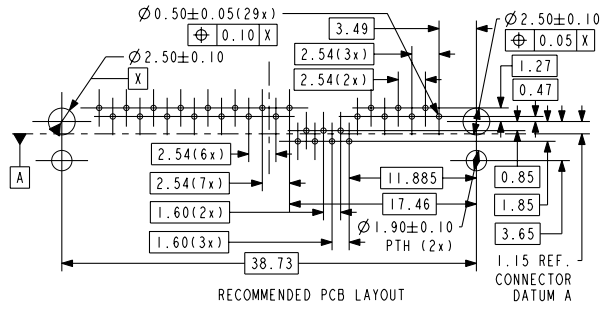

NOTE:

1. MATERIAL:
 - A) HOUSING: HIGH TEMPERATURE THERMOPLASTIC, UL 94V-0
COLOUR: BLACK
 - B) TERMINAL: COPPER ALLOY
 - C) HOLD DOWN: COPPER ALLOY
- 2 FINISH (LEAD-FREE):
 - A) TERMINAL: 30u" Au PLATING (CONTACT POINT) OVER 50u" NICKEL
 - B) SOLDER TAIL: 100u" MIN Sn OVER 50u" NICKEL
 - C) HOLD DOWN: 100u" min Sn OVER 50u" NICKEL
- 3 PER SFF REV 1.4 EXCEPT 0.8mm PITCH BUMP AREA.
- 4 THE HOUSING WILL WITHSTAND EXPOSURE TO 260°C PEAK TEMPERATURE FOR 10 SECONDS IN A CONVECTION, INFRA-RED OR VAPOR PHASE REFLOW OVEN.
- 5 THIS PRODUCT MEETS EUROPE UNION DIRECTIVES AND OTHER COUNTRY REGULATIONS AS DESCRIBED IN GS-22-008.
- 6 PART NUMBERS ENDING IN "LF" MEANS FOR NOTE 5 LEAD FREE IDENTIFICATION. P/N XXXXXXXX-XXXLF IS EQUIVALENT TO PREVIOUS P/N XXXXXXXX-XXX.

title	SAS RECEPTACLE TH (WIDE BASE)		dwg no	10039748	Rev. A
	catalog no	-			